

freestanding storage & accessories

B S C G B

Half Wardrobe Unit with Box/Box/ File – Glass Door

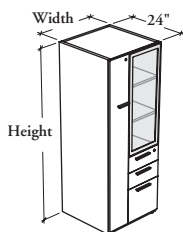

This unit provides a lockable storage area to store garments and other items combined with the filing capabilities of a pedestal (letter- and legal-size paper).

WHAT'S INCLUDED

1 storage unit, 2 adjustable shelves, 1 pencil tray, 1 drawer divider, 1 12" hanging file bar, 1 coat rod, pulls, levelers, lock and keys.

WHAT'S EXCLUDED

Top for Solid Storage and Hang-On Kit.

NOTES

Holes at 1 1/4" intervals on the inside walls of side panels of the top section allow for shelf adjustment.

Width of drawers is fixed. Only the wardrobe width varies.

Hanging file bars are included along the width only.

Soft Touch (2) and Standard T/O/S (4) pulls are only available in limited Foundation colors. Refer to the specification software for details.

PRODUCT OPTIONS

Depth	Width	Height	Drawer Configuration	Door and Drawer Front Finish	Edge Trim Finish	Case Finish	Door Frame Finish	Glass Door Finish	Pull Style	Pull Finish	Key Style	Glass Door Lock
24	24, 30, 36	66, 72	L Left R Right (Shown)	Source Laminate	Edge Trim Colors	Source Laminate	AC Clear Anodized	Standard: CL Clear FT Frosted Back-Painted	1 Standard Expansion 2 Soft Touch 4 Standard T/O/S 6 Arched 7 Elliptical 9 Rectilinear	Foundation Mica	K Keyed Alike R Keyed Randomly	0 No
				Foundation Laminate			Mica					1 Yes

SAMPLE ORDER CODE

BSCGB 24	30	72	L	2D	4D	3D	AC	CL	9	7	R	0
--------------------	-----------	-----------	----------	-----------	-----------	-----------	-----------	-----------	----------	----------	----------	----------

690

DIMENSIONS INCHES / MM

D	W	H
24 / 610	24 / 610	66 / 1676
24 / 610	24 / 610	72 / 1829
24 / 610	30 / 762	66 / 1676
24 / 610	30 / 762	72 / 1829
24 / 610	36 / 914	66 / 1676
24 / 610	36 / 914	72 / 1829

CLEAR GLASS DOOR (CL)

DOOR AND DRAWER FRONT FINISH

Source Laminate	Foundation Laminate
2184	2333
2282	2437
2404	2594
2507	2713
2642	2856
2750	2988

FROSTED GLASS (FT)/ BACK-PAINTED GLASS DOOR

Source Laminate	Foundation Laminate
2290	2439
2411	2566
2510	2700
2636	2842
2748	2962
2879	3117

KEY UPCHARGE

Glass Door Lock (1)
42
42
42
42
42
42