

mounted storage & accessories

BOSOG 

Overhead Cabinet – Glass Overlay Sliding Door

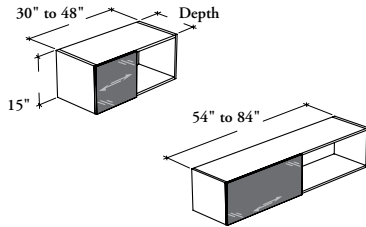

This cabinet is a mounted storage unit that supplies overhead storage in a variety of widths.

WHAT'S INCLUDED

1 overhead cabinet, wall-mounted supports (as specified), 1 overlay sliding door and 1 divider (54" to 84" only).

WHAT'S EXCLUDED

Wall Panel for Overhead Cabinet (B_WCC), Wall Panel for Overhead Cabinet and Shelf (B_WCO), Top for Overhead Cabinet (B_OT), and accessories (BLEDD or BLEDS).

NOTES

For the Wall Panel Mounting Style (B), specify the width according to the width of the Wall Panel for Overhead Cabinet.

When Wall-Mounted (W) option is specified, only 16" depth is available.

Top for Overhead Cabinet (B_OT) **cannot** be installed on this product.

When Linear LED Light Ready (L) option is specified, a Support for Linear LED Light – Overhead (BLEDS) must be ordered separately.

PRODUCT OPTIONS

Mounting Style	Configuration	Depth	Width	Height	Orientation
B Wall Panel Mounted W Wall-Mounted	O One Door	16, 18	30, 36, 42, 48, 54, 60, 66, 72, 78, 84	15	L Overlay Door on Left (Shown) R Overlay Door on Right

SAMPLE ORDER CODE

BOSOG B	O	18	72	15	L
----------------	----------	-----------	-----------	-----------	----------

PRODUCT OPTIONS CONTINUED

Light Management	Case Finish	Overlay Door Frame Finish	Overlay Door Finish	Key Style
L Linear LED Light Ready N No Light Management	Source Laminate Flintwood (No Cathedral)	Foundation Accent Mica	Back-Painted	N No Lock

SAMPLE ORDER CODE CONTINUED

L	XS	74	K1	N
----------	-----------	-----------	-----------	----------

See Pricing on the following page.



**Overhead Cabinet –
Glass Overlay Sliding Door (Continued)**

**DIMENSIONS
INCHES / MM**

D	W	H
16 / 406	30 / 762	15 / 381
16 / 406	36 / 914	15 / 381
16 / 406	42 / 1067	15 / 381
16 / 406	48 / 1219	15 / 381
16 / 406	54 / 1372	15 / 381
16 / 406	60 / 1524	15 / 381
16 / 406	66 / 1676	15 / 381
16 / 406	72 / 1829	15 / 381
16 / 406	78 / 1981	15 / 381
16 / 406	84 / 2134	15 / 381
18 / 457	30 / 762	15 / 381
18 / 457	36 / 914	15 / 381
18 / 457	42 / 1067	15 / 381
18 / 457	48 / 1219	15 / 381
18 / 457	54 / 1372	15 / 381
18 / 457	60 / 1524	15 / 381
18 / 457	66 / 1676	15 / 381
18 / 457	72 / 1829	15 / 381
18 / 457	78 / 1981	15 / 381
18 / 457	84 / 2134	15 / 381

PRICING

ONE DOOR (O)	
SOURCE LAMINATE CASE FINISH	FLINTWOOD CASE FINISH
OVERLAY DOOR FINISH	
Back-Painted Glass	Back-Painted Glass
969	2146
1066	2315
1165	2486
1260	2647
1357	3012
1455	3159
1550	3302
1648	3449
1743	3593
1840	3729
969	2146
1066	2315
1165	2486
1260	2647
1357	3012
1455	3159
1550	3302
1648	3449
1743	3593
1840	3729