

# mounted storage & accessories

**Xpress**

**BOGS** 

## Overhead Cabinet – Sliding Glass Doors

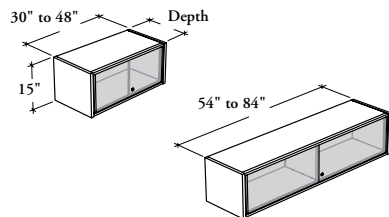

This cabinet is a lockable mounted storage unit that supplies overhead storage in a variety of widths.

**WHAT'S INCLUDED**

1 overhead cabinet, wall-mounted supports (as specified), 2 sliding doors, 2 sliding door pulls, 1 divider (54" to 84" only), lock and keys (as specified).

**WHAT'S EXCLUDED**

Wall Panel for Overhead Cabinet (B\_WCC), Wall Panel for Overhead Cabinet and Shelf (B\_WCO), Top for Overhead Cabinet (B\_OT), and accessories (BLEDD or BLEDS).

**NOTES**

For the Wall Panel Mounting Style (B), specify the width according to the width of the Wall Panel for Overhead Cabinet.

When Wall Panel Mounted (B) option is specified, only 18" depth is available.

When Wall-Mounted (W) option is specified, only 16" depth is available.

When Linear LED Light Ready (L) option is specified, a Support for Linear LED Light – Overhead (BLEDS) must be ordered separately.

Not all glass finishes are available as Xpress, Please see Xpress catalogue and/or specification software for details.

**PRODUCT OPTIONS**

Mounting Style	Depth	Width	Height	Light Management
<b>B</b> Wall Panel Mounted	16, 18	30, 36, 42, 48, 54, 60, 66, 72, 78, 84	15	<b>L</b> Linear LED Light Ready
<b>W</b> Wall-Mounted				<b>N</b> No Light Management

**SAMPLE ORDER CODE**

<b>BOGS B</b>	<b>18</b>	<b>84</b>	<b>15</b>	<b>L</b>
---------------	-----------	-----------	-----------	----------

**PRODUCT OPTIONS CONTINUED**

Case Finish	Glass Door Finish	Pull Finish	Key Style
Source Laminate Flintwood (No Cathedral)	Standard: <b>CL</b> Clear <b>FT</b> Frosted Back-Painted	Foundation Mica	<b>N</b> No Lock <b>K</b> Keyed Alike <b>R</b> Keyed Randomly

**SAMPLE ORDER CODE CONTINUED**

<b>XS</b>	<b>CL</b>	<b>74</b>	<b>K</b>
-----------	-----------	-----------	----------

See Pricing on the following page.

**Overhead Cabinet –  
Sliding Glass Doors (Continued)**

**DIMENSIONS  
INCHES / MM**

D	W	H
16 / 406	30 / 762	15 / 381
16 / 406	36 / 914	15 / 381
16 / 406	42 / 1067	15 / 381
16 / 406	48 / 1219	15 / 381
16 / 406	54 / 1372	15 / 381
16 / 406	60 / 1524	15 / 381
16 / 406	66 / 1676	15 / 381
16 / 406	72 / 1829	15 / 381
16 / 406	78 / 1981	15 / 381
16 / 406	84 / 2134	15 / 381
18 / 457	30 / 762	15 / 381
18 / 457	36 / 914	15 / 381
18 / 457	42 / 1067	15 / 381
18 / 457	48 / 1219	15 / 381
18 / 457	54 / 1372	15 / 381
18 / 457	60 / 1524	15 / 381
18 / 457	66 / 1676	15 / 381
18 / 457	72 / 1829	15 / 381
18 / 457	78 / 1981	15 / 381
18 / 457	84 / 2134	15 / 381

**PRICING**

SOURCE LAMINATE CASE FINISH		FLINTWOOD CASE FINISH	
GLASS DOOR FRONT FINISH			
Clear Glass (CL)	Frosted Glass (FT) / Back-Painted Glass	Clear Glass (CL)	Frosted Glass (FT) / Back-Painted Glass
1293	1390	2470	2567
1384	1502	2633	2751
1465	1602	2786	2923
1557	1707	2944	3094
1750	1921	3405	3576
1839	2032	3543	3736
1929	2140	3681	3892
2000	2255	3801	4056
2087	2367	3937	4217
2178	2476	4067	4365
1293	1390	2470	2567
1384	1502	2633	2751
1465	1602	2786	2923
1557	1707	2944	3094
1750	1921	3405	3576
1839	2032	3543	3736
1929	2140	3681	3892
2000	2255	3801	4056
2087	2367	3937	4217
2178	2476	4067	4365