

## BCLX

### Cubic Tower with Solid and Glass Doors – Low Secondary Desk Mounted

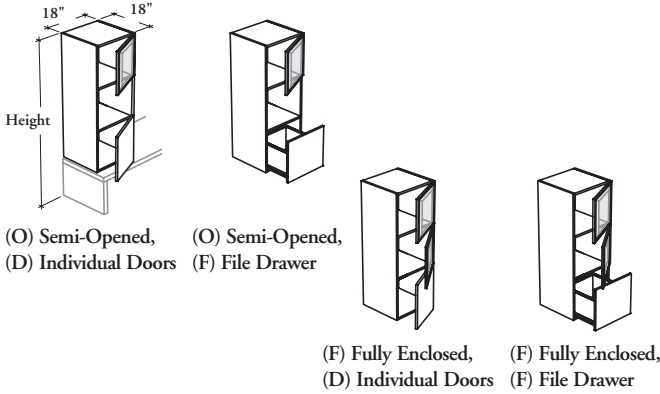

This tower combines a 3-level of closed, open or file drawer storage compartments in a cubic aesthetic. It must always be mounted on a Low Secondary Desk.

#### WHAT'S INCLUDED

1 tower, mounting hardware, locks and keys (as specified), and accessories as listed below:

	Cube Style			
	OD	OF	FD	FF
Cubic File Drawer	n/a	1	n/a	1
15" Cross File Bar	n/a	1	n/a	1
Cubic Door	2	1	3	2
Compartment	3	2	3	2

#### WHAT'S EXCLUDED

Low Secondary Desks and Multi-Functional Drawer (if applicable).

#### NOTES

This mounted tower **cannot** be used alone. It must be connected to another mounted tower, a freestanding tower, a wall panel or an overhead cabinet in order to ensure stability.

When applicable, the cross file bar is included and is installed along the depth only.

File drawer accepts the legal- and letter-size paper.

The Multi-Functionnal Drawer (BADMF) can only be installed in the file drawer compartment.

#### PRODUCT OPTIONS

Configuration Style	Storage Style	Depth	Width	Height	Door Swing Direction	Case Finish	Drawer and Door Front Finish	Door Frame Finish	Glass Door Finish	Key Style
<b>F</b> Fully Enclosed <b>O</b> Semi-Opened	<b>D</b> Individual Doors <b>F</b> File Drawer	18	18	66, 72	<b>L</b> Left Side <b>R</b> Right Side (Shown)	Source Laminate Flintwood (No Cathedral)	Source Laminate Flintwood (No Cathedral)	AC Clear Anodized Foundation Accent Mica	Standard: <b>CL</b> Clear <b>FT</b> Frosted <b>Back-Painted</b>	<b>N</b> No Lock <b>K</b> Keyed Alike <b>R</b> Keyed Randomly

#### SAMPLE ORDER CODE

<b>BCLX F</b>	<b>F</b>	<b>18</b>	<b>18</b>	<b>72</b>	<b>L</b>	<b>3E</b>	<b>3E</b>	<b>AC</b>	<b>K7</b>	<b>R</b>
---------------	----------	-----------	-----------	-----------	----------	-----------	-----------	-----------	-----------	----------

596

#### CUBE STYLE

#### CLEAR GLASS DOOR (CL)

#### KEY UPCHARGE

	SOURCE LAMINATE CASE FINISH DRAWER AND DOOR FRONT FINISH		FLINTWOOD CASE FINISH DRAWER AND DOOR FRONT FINISH		Keyed Alike or Keyed Randomly
	Source Laminate	Flintwood	Flintwood		
BCLXOD181866	981	1184	2475		42
BCLXOD181872	1054	1278	2569		42
BCLXOF181866	1098	1299	2669		42
BCLXOF181872	1169	1393	2763		42
BCLXFD181866	1234	1434	2819		89
BCLXFD181872	1305	1528	2913		89
BCLXFF181866	1347	1548	3012		89
BCLXFF181872	1418	1642	3106		89

Pricing is continued on the following page.

**BCLX**

**Cubic Tower with Solid and Glass  
Doors – Low Secondary Desk  
Mounted (Continued)**

CUBE STYLE	FROSTED GLASS (FT) / BACK-PAINTED GLASS DOOR			KEY UPCHARGE Keyed Alike or Keyed Randomly
	SOURCE LAMINATE CASE FINISH		FLINTWOOD CASE FINISH	
	DRAWER AND DOOR FRONT FINISH		DRAWER AND DOOR FRONT FINISH	
	Source Laminate	Flintwood	Flintwood	
BCLXOD181866	1042	1245	2536	42
BCLXOD181872	1120	1344	2635	42
BCLXOF181866	1159	1360	2730	42
BCLXOF181872	1235	1459	2829	42
BCLXFD181866	1353	1553	2938	89
BCLXFD181872	1435	1658	3043	89
BCLXFF181866	1466	1667	3131	89
BCLXFF181872	1548	1772	3236	89