

This tower combines 2-level of closed or open storage compartments and a pigeonhole with removeable metal shelves in a cubic aesthetic. It must always be mounted on a High Secondary Desk.

BCHL

Cubic Tower with Solid Doors – High Secondary Desk Mounted

WHAT'S INCLUDED

1 tower, mounting hardware, locks and keys (as specified), and accessories as listed below:

	Cube Style	
	O	F
Cubic Door	1	2
Compartment	2	2
Removeable Metal Shelf	2	2 (66" h)
	3	3 (72" h)

WHAT'S EXCLUDED

High Secondary Desks and Multi-Functional Drawer.

NOTES

This mounted tower **cannot** be used alone. It must be connected to another mounted tower, a freestanding tower, a wall panel or an overhead cabinet in order to ensure stability.

Up to two stacked Multi-Functionnal Drawer (BADMF) can only be installed in the pigeonhole section.

The removeable metal shelves can be repositioned in the closed section when a Multi-Functional Drawer is installed.

Not all finishes are available as Xpress, Please see Xpress catalogue and/or specification software for details.

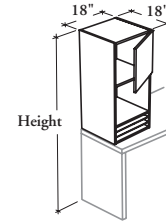

(O) Semi-Opened



(F) Fully Enclosed

PRODUCT OPTIONS

Configuration Style	Depth	Width	Height	Door Swing Direction	Case Finish	Door Front Finish	Shelf Finish	Key Style
F Fully Enclosed	18	18	66, 72	L Left Side	Source Laminate	Source Laminate	Foundation	N No Lock
O Semi-Opened				R Right Side (Shown)	Flintwood (No Cathedral)	Flintwood (No Cathedral)	Mica	K Keyed Alike R Keyed Randomly

SAMPLE ORDER CODE

BCHL O	18	18	66	R	XS	XS	7	K
---------------	-----------	-----------	-----------	----------	-----------	-----------	----------	----------

CUBE STYLE

CUBE STYLE	SOURCE LAMINATE CASE FINISH		FLINTWOOD CASE FINISH
	DOOR FRONT FINISH		DOOR FRONT FINISH
	Source Laminate	Flintwood	Flintwood
BCHLO181866	756	959	2046
BCHLO181872	808	1016	2119
BCHLF181866	883	1284	2286
BCHLF181872	935	1342	2360