

This storage provides a functional alternative to combo pedestals and storage cabinets.

## B B S D

### WHAT'S INCLUDED

1 storage cabinet with drawers, 1 adjustable shelf, pulls (as specified), levelers, lock and keys.

## Storage Cabinet with Drawer(s)

### WHAT'S EXCLUDED

Top for Solid Storage.

### NOTES

The box drawers are **not** lockable.

Holes at 1 1/4" intervals on the inside of side panels allow for shelf adjustment.

Additional shelves (BSHE) are available and must be specified separately.

Soft Touch (2) and Standard T/O/S (4) pulls are only available in limited Foundation colors. Refer to the specification software for details.

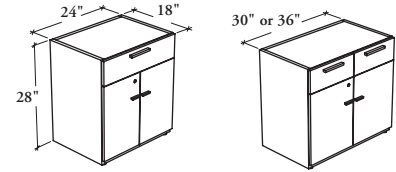

### PRODUCT OPTIONS

Depth	Width	Height	Door and Drawer Front Finish	Edge Trim Finish	Case Finish	Pull Style	Pull Finish	Key Style
18	24, 30, 36	28	Source Laminate Foundation Laminate	Edge Trim Colors	Source Laminate	<b>1</b> Standard Expansion <b>2</b> Soft Touch <b>4</b> Standard T/O/S <b>6</b> Arched <b>7</b> Elliptical <b>9</b> Rectilinear	Foundation Mica	<b>K</b> Keyed Alike <b>R</b> Keyed Randomly

### SAMPLE ORDER CODE

<b>BBSD 18</b>	<b>24</b>	<b>28</b>	<b>3E</b>	<b>4E</b>	<b>LE</b>	<b>1</b>	<b>7</b>	<b>R</b>
----------------	-----------	-----------	-----------	-----------	-----------	----------	----------	----------

### DIMENSIONS INCHES / MM

D	W	H
18 / 457	24 / 610	28 / 711
18 / 457	30 / 762	28 / 711
18 / 457	36 / 914	28 / 711

### PRICING

Source Laminate	Foundation Laminate
1171	1245
1192	1263
1213	1284