

ZJWS

Segmented Wall Panel – Above Credenza

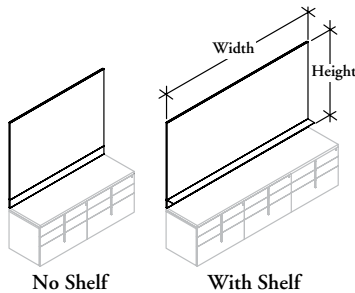

WHAT'S INCLUDED

1 segmented wall panel, 1 shelf (if specified).

NOTES

Heights 42-3/8" (42) and 56-1/2" (56) are only available in Widths 15" - 48".

Lower panel is always Natural Veneer.

Horizontal grain direction Veneer Group 4 only.

Flintwood available in Open Pore finish only.

436

PRODUCT OPTIONS

Shelf	Grain Direction	Height	Width	Upper Finish	Lower Finish	Shelf Finish
N No Shelf	H Horizontal	12 12-5/8"	15, 18, 30, 36, 42, 48, 54, 60, 66, 72, 78, 84, 90, 96, 102, 108	Panel Fabrics	Flintwood	A5 Clear Glass
S With Shelf	V Vertical	26 26-3/4"		Natural Veneer	Natural Veneer	MV White Solid Surface
		40 40-7/8"		K7 Very White Backpainted Glass	CWS Custom Wood Stain	
		42 42-3/8"		K1 Storm White Backpainted Glass		
		56 56-1/2"		J6 Gris Backpainted Glass		
			K8 Graphic Steel Backpainted Glass			

SAMPLE ORDER CODE

ZJWS S	H	42	36	L305	DV	MV
--------	---	----	----	------	----	----

DIMENSIONS FOR MM X BY 25.4

PRICING

H	W	VENEER		FLINTWOOD		FABRIC							MAGNETIC BACK-PAINTED	
		Vertical Grain	Horizontal Grain	Vertical Grain	Horizontal Grain	COM Gr. A	Gr. 1	Gr. 2	Gr. 3	Gr. 4	Gr. 5	Gr. 6		Gr. 7
12-5/8	15	781	824	718	757	1162	1179	1297	1360	1417	1475	1590	1668	1223
12-5/8	18	793	838	730	771	1173	1190	1307	1370	1428	1486	1601	1680	1265
12-5/8	30	845	891	778	819	1219	1235	1353	1416	1474	1531	1647	1724	1432
12-5/8	36	870	916	801	843	1241	1258	1376	1439	1496	1554	1670	1747	1517
12-5/8	42	957	1002	879	923	1323	1341	1457	1521	1579	1636	1751	1829	1658
12-5/8	48	981	1029	903	945	1346	1363	1480	1543	1601	1658	1775	1850	1744
12-5/8	54	1182	1228	1087	1130	1541	1559	1676	1741	1799	1854	1970	2048	2001
12-5/8	60	1207	1254	1111	1154	1565	1582	1699	1764	1820	1877	1993	2070	2086
12-5/8	66	1233	1281	114	1177	1588	1605	1721	1785	1843	1901	2015	2093	2169
12-5/8	72	1318	1366	121	1257	1670	1686	1804	1867	1925	1982	2097	2175	2313
12-5/8	78	1344	1393	123	1281	1691	1709	1827	1891	1946	2004	2121	2198	2396
12-5/8	84	1369	1420	126	1306	1714	1732	1848	1912	1970	2028	2143	2221	2479
12-5/8	90	1395	1445	128	1330	1738	1753	1872	1935	1993	2050	2165	2243	2564
12-5/8	96	1480	1531	135	1409	1819	1837	1953	2017	2074	2132	2248	2325	2707
12-5/8	102	1505	1557	137	1433	1842	1860	1976	2039	2097	2155	2270	2347	2790
12-5/8	108	1531	1584	139	1457	1865	1881	1999	2063	2121	2178	2294	2370	2875

To order a Custom Color for Dossier please use the code ZCCWS. A one time 897 list charge per color applies.

Pricing is continued on the following page.

Segmented Wall Panel –
Above Credenza (Continued)

DIMENSIONS
FOR MM X BY 25.4

PRICING

		VENEER		FLINTWOOD		FABRIC							MAGNETIC BACK-PAINTED	
H	W	Vertical Grain	Horizontal Grain	Vertical Grain	Horizontal Grain	COM Gr. A	Gr. 1	Gr. 2	Gr. 3	Gr. 4	Gr. 5	Gr. 6	Gr. 7	
26-3/4	15	925	971	850	894	1291	1309	1511	1490	1548	1605	1720	1799	1636
26-3/4	18	945	994	870	914	1309	1325	1546	1507	1564	1622	1738	1815	1741
26-3/4	30	1032	1081	948	995	1377	1394	1647	1574	1632	1689	1805	1882	2157
26-3/4	36	1074	1126	990	1035	1411	1427	1680	1609	1666	1723	1839	1916	2366
26-3/4	42	1186	1239	1091	1139	1512	1529	1886	1710	1768	1826	1940	2017	2643
26-3/4	48	1227	1283	1129	1181	1547	1562	1922	1744	1802	1860	1974	2052	2851
26-3/4	54	1444	1500	1329	1381	1752	1771	1956	1951	2008	2066	2182	2259	3234
26-3/4	60	1488	1546	1368	1422	1786	1805	2057	1984	2041	2099	2216	2294	3442
26-3/4	66	1530	1589	1408	1462	1820	1839	2091	2019	2076	2133	2249	2327	3650
26-3/4	72	1642	1702	1510	1606	1923	1940	2125	2121	2178	2236	2351	2429	3928
26-3/4	78	1683	1746	1549	1687	1957	1974	2159	2154	2211	2269	2384	2462	4137
26-3/4	84	1725	1789	1588	1831	1991	2007	2260	2188	2246	2303	2419	2496	4344
26-3/4	90	1769	1835	1627	1687	2025	2040	2295	2222	2280	2337	2453	2530	4553
26-3/4	96	1879	1945	1729	1789	2126	2143	2328	2323	2381	2439	2554	2632	4830
26-3/4	102	1923	1991	1769	1831	2160	2176	1426	2358	2415	2473	2588	2666	5038
26-3/4	108	1965	2035	1808	1414	2193	2210	1443	2392	2450	2507	2622	2701	5248
40-7/8	15	1069	1118	982	1722	1422	1439	1556	1619	1677	1735	1849	1927	2050
40-7/8	18	1098	1150	1010	1900	1444	1461	1578	1643	1700	1757	1873	1949	2217
40-7/8	30	1219	1273	1121	2014	1533	1552	1668	1733	1789	1846	1962	2039	2882
40-7/8	36	1279	1336	1176	2190	1579	1596	1713	1777	1835	1893	2007	2086	3217
40-7/8	42	1415	1475	1302	1358	1702	1718	1836	1899	1957	2014	2129	2206	3625
40-7/8	48	1474	1537	1356	1062	1746	1764	1879	1943	2001	2059	2174	2251	3959
40-7/8	54	1683	1747	1549	1240	1939	1957	2073	2136	2194	2252	2367	2445	4440
40-7/8	60	1742	1809	1603	1427	1984	2001	2118	2183	2240	2298	2413	2490	4774
40-7/8	66	1802	1873	1656	1145	2030	2047	2163	2227	2285	2343	2457	2535	5107
40-7/8	72	1930	2002	1775	1334	2142	2160	2276	2339	2397	2455	2570	2648	5509
40-7/8	78	1990	2065	1830	1900	2187	2205	2321	2384	2442	2499	2615	2692	5842
40-7/8	84	2049	2127	1884	1957	2232	2250	2366	2430	2488	2546	2660	2739	6175
40-7/8	90	2109	2189	1940	2014	2278	2295	2412	2475	2532	2590	2706	2783	6509
40-7/8	96	2237	2319	2058	2133	2391	2408	2525	2588	2646	2704	2818	2897	6909
40-7/8	102	2297	2381	2112	2190	2435	2453	2570	2633	2690	2748	2864	2941	7243
40-7/8	108	2357	2443	2167	2248	2481	2497	2615	2679	2737	2795	2909	2988	7577
42-3/8	15	1073	1123	989	1033	1424	1442	1558	1622	1680	1738	1852	1931	2084
42-3/8	18	1104	1155	1016	1062	1447	1464	1582	1646	1704	1761	1876	1955	2256
42-3/8	30	1227	1283	1129	1181	1540	1557	1675	1739	1797	1853	1969	2046	2950
42-3/8	36	1289	1347	1187	1240	1587	1604	1720	1784	1842	1900	2015	2092	3296
42-3/8	42	1427	1489	1313	1369	1709	1725	1843	1906	1964	2022	2136	2216	3718
42-3/8	48	1489	1552	1369	1427	1754	1772	1891	1953	2010	2068	2184	2261	4065
56-1/2	15	1192	1245	1097	1145	1529	1547	1662	1726	1784	1842	1958	2034	2471
56-1/2	18	1231	1285	1133	1183	1557	1574	1691	1754	1812	1871	1986	2064	2707
56-1/2	30	1389	1450	1279	1334	1673	1689	1807	1871	1929	1986	2101	2179	3649
56-1/2	36	1468	1531	1350	1409	1730	1747	1865	1929	1986	2042	2159	2237	4121
56-1/2	42	1641	1708	1509	1571	1880	1898	2015	2078	2135	2193	2309	2387	4684
56-1/2	48	1718	1788	1580	1646	1938	1956	2072	2135	2193	2251	2366	2444	5156

437

To order a Custom Color for Dossier please use the code ZCCWS. A one time 897 list charge per color applies.

Pricing is continued on the following page.

Z J W S

Segmented Wall Panel – Above Credenza (Continued)

If Glass Shelf is specified, add;

15"	473
18"	480
30"	519
36"	539
42"	557
48"	576
54"	595
60"	614
66"	633
72"	652
78"	672
84"	690
90"	710
96"	729
102"	748
108"	767

If Solid Surface Shelf is specified, add;

15"	357
18"	377
30"	458
36"	499
42"	540
48"	581
54"	621
60"	660
66"	704
72"	744
78"	784
84"	825
90"	867
96"	907
102"	947
108"	989