

wall panels

ZJWL

Segmented Wall Panel – Above Low Credenza

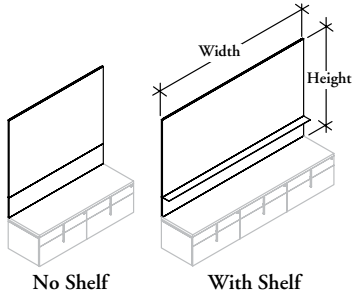

WHAT'S INCLUDED

1 segmented wall panel, 1 shelf (if specified).

NOTES

Heights 48-3/4" (48), 50-1/4" (50) and 64-3/8" (64) are only available in Widths 15" - 48".

Lower panel is always Natural Veneer.

Horizontal grain direction Veneer Group 4 only.

Flintwood available in Open Pore finish only.

44°

PRODUCT OPTIONS

Shelf	Grain Direction	Height	Width	Upper Finish	Lower Finish	Shelf Finish
N No Shelf	H Horizontal	20 20-1/2"	15, 18, 30, 36, 42, 48, 54, 60, 66, 72, 78, 84, 90, 96, 102, 108	Panel Fabrics	Flintwood	A5 Clear Glass
S With Shelf	V Vertical	34 34-5/8"		Natural Veneer	Veneer	MV White Solid Surface
		48 48-3/4"		K7 Very White Backpainted Glass	CWS Custom Wood Stain	
		50 50-1/4"		K1 Storm White Backpainted Glass		
		64 64-3/8"		J6 Gris Backpainted Glass		
			K8 Graphic Steel Backpainted Glass			

SAMPLE ORDER CODE

ZJWL N	V	64	48	K6	DV
--------	---	----	----	----	----

DIMENSIONS FOR MM X BY 25.4

PRICING

H	W	VENEER		FLINTWOOD		FABRIC							MAGNETIC BACK-PAINTED	
		Vertical Grain	Horizontal Grain	Vertical Grain	Horizontal Grain	COM Gr. A	Gr. 1	Gr. 2	Gr. 3	Gr. 4	Gr. 5	Gr. 6		Gr. 7
20-1/2	15	826	869	761	800	1206	1223	1341	1403	1461	1519	1634	1712	1284
20-1/2	18	839	883	772	812	1217	1235	1351	1415	1473	1530	1646	1723	1330
20-1/2	30	894	938	821	864	1265	1282	1399	1462	1520	1578	1692	1770	1514
20-1/2	36	919	965	846	888	1287	1305	1422	1485	1542	1600	1715	1795	1605
20-1/2	42	1005	1053	926	968	1369	1387	1504	1569	1626	1683	1799	1876	1756
20-1/2	48	1033	1079	950	994	1394	1411	1528	1591	1649	1707	1821	1900	1847
20-1/2	54	1233	1281	1134	1177	1591	1609	1724	1788	1846	1904	2019	2096	2113
20-1/2	60	1260	1309	1159	1204	1614	1631	1748	1811	1869	1927	2041	2121	2205
20-1/2	66	1286	1336	1184	1228	1637	1654	1772	1836	1894	1951	2066	2144	2297
20-1/2	72	1374	1423	1263	1309	1720	1738	1854	1917	1975	2033	2149	2226	2447
20-1/2	78	1399	1450	1287	1334	1744	1761	1877	1941	1999	2057	2171	2249	2538
20-1/2	84	1426	1477	1312	1359	1767	1784	1901	1964	2022	2079	2194	2272	2630
20-1/2	90	1454	1504	1337	1384	1789	1807	1925	1989	2046	2103	2219	2297	2722
20-1/2	96	1539	1591	1416	1463	1873	1891	2007	2070	2128	2186	2301	2379	2873
20-1/2	102	1567	1618	1441	1489	1897	1913	2030	2094	2152	2209	2325	2401	2965
20-1/2	108	1593	1647	1465	1515	1918	1937	2054	2117	2174	2232	2347	2425	3056

To order a Custom Color for Dossier please use the code ZCCWS. A one time 897 list charge per color applies.

Pricing is continued on the following page.

Segmented Wall Panel –
Above Low Credenza (Continued)

DIMENSIONS
FOR MM X BY 25.4

PRICING

		VENEER		FLINTWOOD		FABRIC							MAGNETIC BACK-PAINTED	
H	W	Vertical Grain	Horizontal Grain	Vertical Grain	Horizontal Grain	COM Gr. A	Gr. 1	Gr. 2	Gr. 3	Gr. 4	Gr. 5	Gr. 6	Gr. 7	
34-5/8	15	970	1016	893	935	1336	1353	1471	1533	1591	1649	1765	1842	1697
34-5/8	18	993	1038	913	956	1353	1370	1488	1551	1609	1666	1781	1860	1806
34-5/8	30	1079	1130	994	1039	1422	1440	1556	1619	1677	1735	1849	1929	2239
34-5/8	36	1124	1175	1033	1081	1457	1474	1591	1654	1712	1770	1884	1963	2455
34-5/8	42	1235	1288	1136	1186	1559	1577	1692	1757	1815	1872	1988	2065	2740
34-5/8	48	1279	1334	1176	1227	1593	1611	1728	1790	1848	1906	2022	2099	2956
34-5/8	54	1496	1553	1377	1428	1802	1819	1936	1999	2057	2114	2229	2307	3345
34-5/8	60	1540	1597	1417	1471	1837	1853	1971	2034	2092	2150	2265	2343	3562
34-5/8	66	1585	1645	1458	1514	1872	1888	2004	2069	2127	2185	2299	2377	3778
34-5/8	72	1695	1757	1559	1617	1973	1991	2108	2171	2228	2286	2401	2479	4063
34-5/8	78	1740	1803	1600	1657	2008	2026	2143	2206	2264	2321	2436	2514	4279
34-5/8	84	1783	1847	1642	1700	2041	2060	2176	2240	2298	2355	2471	2549	4494
34-5/8	90	1828	1894	1682	1742	2077	2094	2211	2275	2333	2391	2506	2584	4712
34-5/8	96	1938	2007	1783	1846	2179	2197	2314	2377	2434	2492	2608	2685	4995
34-5/8	102	1982	2053	1823	1888	2214	2231	2348	2412	2469	2527	2643	2720	5212
34-5/8	108	2027	2097	1865	1931	2249	2266	2382	2447	2505	2562	2677	2754	5428
48-3/4	15	1115	1163	1025	1070	1465	1483	1600	1664	1721	1779	1895	1972	2111
48-3/4	18	1145	1194	1054	1098	1489	1505	1623	1686	1744	1802	1916	1995	2282
48-3/4	30	1266	1321	1164	1215	1580	1596	1714	1778	1836	1894	2008	2087	2965
48-3/4	36	1327	1384	1221	1273	1626	1644	1759	1823	1881	1939	2054	2131	3304
48-3/4	42	1464	1524	1347	1402	1748	1766	1881	1945	2003	2061	2175	2253	3722
48-3/4	48	1524	1588	1402	1461	1795	1810	1929	1992	2049	2107	2222	2300	4063
50-1/4	15	1119	1167	1030	1073	1468	1486	1603	1666	1723	1781	1897	1974	2144
50-1/4	18	1151	1200	1059	1104	1492	1509	1626	1689	1747	1805	1920	1998	2321
50-1/4	30	1274	1331	1173	1225	1586	1604	1720	1783	1841	1899	2014	2092	3030
50-1/4	36	1338	1397	1230	1285	1633	1650	1768	1831	1888	1945	2061	2140	3384
50-1/4	42	1477	1538	1359	1415	1756	1773	1892	1955	2011	2069	2185	2263	3815
50-1/4	48	1539	1604	1416	1475	1803	1820	1937	2001	2059	2116	2231	2309	4169
64-3/8	15	1238	1289	1137	1187	1573	1590	1708	1771	1829	1885	2001	2078	2532
64-3/8	18	1278	1331	1175	1225	1601	1619	1737	1801	1859	1914	2030	2108	2773
64-3/8	30	1436	1497	1321	1378	1718	1737	1852	1916	1974	2031	2146	2224	3730
64-3/8	36	1517	1581	1396	1455	1777	1795	1911	1974	2032	2090	2205	2283	4208
64-3/8	42	1689	1757	1554	1617	1929	1944	2063	2126	2184	2241	2357	2434	4781
64-3/8	48	1769	1841	1627	1693	1986	2003	2121	2184	2241	2299	2414	2492	5261

44I

To order a Custom Color for Dossier please use the code ZCCWS. A one time 897 list charge per color applies.

Pricing is continued on the following page.

Z J W L

Segmented Wall Panel – Above Low Credenza (Continued)

If Glass is specified, add;

15"	473
18"	480
30"	519
36"	539
42"	557
48"	576
54"	595
60"	614
66"	633
72"	652
78"	672
84"	690
90"	710
96"	729
102"	748
108"	767

If Solid Surface Shelf is specified, add;

15"	357
18"	377
30"	458
36"	499
42"	540
48"	581
54"	621
60"	660
66"	704
72"	744
78"	784
84"	825
90"	867
96"	907
102"	947
108"	989