

## Z J W G M

### Full Wall Panel – Above Low Credenza, Magnetic Veneer

#### WHAT'S INCLUDED

1 full wall panel.

#### NOTES

Heights 48-3/4" (48), 50-1/4" (50) and 64-3/8" (64) are only available in Widths 15" - 48".

Available in Open Pore finish only.

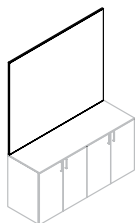

458

#### PRODUCT OPTIONS

Grain Direction	Height	Width	Finish
<b>H</b> Horizontal	<b>20</b> 20-1/2"	15, 18, 30, 36, 42, 48, 54, 60, 66, 72, 78, 84, 90	Flintwood Natural Veneer <b>CWS</b> Custom Wood Stain
<b>V</b> Vertical	<b>34</b> 34-5/8"		
	<b>48</b> 48-3/4"		
	<b>50</b> 50-1/4"		
	<b>64</b> 64-3/8"		

#### SAMPLE ORDER CODE

<b>ZJWGM V</b>	<b>34</b>	<b>84</b>	<b>VE</b>
----------------	-----------	-----------	-----------

#### DIMENSIONS FOR MM X BY 25.4

H	W
20-1/2	15
20-1/2	18
20-1/2	30
20-1/2	36
20-1/2	42
20-1/2	48
20-1/2	54
20-1/2	60
20-1/2	66
20-1/2	72
20-1/2	78
20-1/2	84
20-1/2	90

#### PRICING

VENEER		FLINTWOOD	
Vertical Grain	Horizontal Grain	Vertical Grain	Horizontal Grain
755	793	755	793
783	822	783	822
958	1005	958	1005
1013	1063	1013	1063
1069	1123	1069	1123
1124	1179	1124	1179
1335	1401	1335	1401
1389	1459	1389	1459
1444	1516	1444	1516
1532	1609	1532	1609
1587	1666	1587	1666
1675	1759	1675	1759
1730	1817	1730	1817

To order a Custom Color for Dossier please use the code ZCCWS. A one time 897 list charge per color applies.

Pricing is continued on the following page.

**Z J W G M**  
**Full Wall Panel – Above Low**  
**Credenza, Magnetic Veneer**  
**(Continued)**

**DIMENSIONS**  
**FOR MM X BY 25.4**

**PRICING**

H	W	VENEER		FLINTWOOD	
		Vertical Grain	Horizontal Grain	Vertical Grain	Horizontal Grain
34-5/8	15	894	938	894	938
34-5/8	18	941	989	941	989
34-5/8	30	1195	1255	1195	1255
34-5/8	36	1289	1354	1289	1354
34-5/8	42	1384	1454	1384	1454
34-5/8	48	1478	1552	1478	1552
34-5/8	54	1729	1816	1729	1816
34-5/8	60	1823	1914	1823	1914
34-5/8	66	1918	2014	1918	2014
34-5/8	72	2045	2147	2045	2147
34-5/8	78	2140	2246	2140	2246
34-5/8	84	2266	2379	2266	2379
34-5/8	90	2361	2479	2361	2479
48-3/4	15	1044	1097	1044	1097
48-3/4	18	1108	1164	1108	1164
48-3/4	30	1395	1464	1395	1464
48-3/4	36	1521	1597	1521	1597
48-3/4	42	1648	1730	1648	1730
48-3/4	48	1807	1898	1807	1898
50-1/4	15	1086	1139	1086	1139
50-1/4	18	1151	1209	1151	1209
50-1/4	30	1445	1518	1445	1518
50-1/4	36	1575	1654	1575	1654
50-1/4	42	1706	1791	1706	1791
50-1/4	48	1869	1963	1869	1963
64-3/8	15	1246	1308	1246	1308
64-3/8	18	1329	1396	1329	1396
64-3/8	30	1694	1779	1694	1779
64-3/8	36	1861	1954	1861	1954
64-3/8	42	2028	2129	2028	2129
64-3/8	48	2226	2338	2226	2338

To order a Custom Color for Dossier please use the code ZCCWS. A one time 897 list charge per color applies.