

ZJWFV

Full Wall Panel – Above Credenza, Veneer

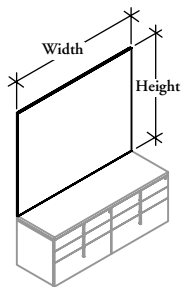

WHAT'S INCLUDED

1 full wall panel.

NOTES

Heights 42-3/8" (42) and 56-1/2" (56) are only available in Widths 15" - 48".

Grain Direction is only required for Natural Veneer finish.

Horizontal grain direction Veneer Group 4 only.

Flintwood available in Open Pore finish only.

452

PRODUCT OPTIONS

Grain Direction	Height	Width	Finish
H Horizontal	12 12-5/8"	15, 18, 30, 36, 42, 48, 54, 60, 66, 72, 78, 84, 90, 96, 102, 108	Flintwood Natural Veneer CWS Custom Wood Stain
V Vertical	26 26-3/4"		
	40 40-7/8"		
	42 42-3/8"		
	56 56-1/2"		

SAMPLE ORDER CODE

ZJWFV V	42	102	K6
---------	----	-----	----

DIMENSIONS FOR MM X BY 25.4

H	W
12-5/8	15
12-5/8	18
12-5/8	30
12-5/8	36
12-5/8	42
12-5/8	48
12-5/8	54
12-5/8	60
12-5/8	66
12-5/8	72
12-5/8	78
12-5/8	84
12-5/8	90
12-5/8	96
12-5/8	102
12-5/8	108

PRICING

VENEER		FLINTWOOD	
Vertical Grain	Horizontal Grain	Vertical Grain	Horizontal Grain
568	613	522	563
575	620	529	571
606	652	557	600
620	669	571	616
695	744	640	684
711	761	654	699
841	891	773	819
855	906	786	835
870	924	801	849
944	998	869	917
961	1015	883	934
975	1031	898	947
992	1047	912	963
1066	1123	980	1033
1080	1137	995	1047
1096	1154	1008	1061

To order a Custom Color for Dossier please use the code ZCCWS. A one time 897 list charge per color applies.

Pricing is continued on the following page.

Z J W F V

Full Wall Panel – Above Credenza,
Veneer (Continued)DIMENSIONS
FOR MM X BY 26PRICI

H	W	VENEER		FLINTWOOD	
		Vertical Grain	Horizontal Grain	Vertical Grain	Horizontal Grain
26-3/4	15	712	760	655	698
26-3/4	18	728	776	669	714
26-3/4	30	792	844	729	776
26-3/4	36	825	878	760	808
26-3/4	42	925	979	850	902
26-3/4	48	958	1015	880	934
26-3/4	54	1104	1163	1016	1070
26-3/4	60	1135	1196	1044	1100
26-3/4	66	1168	1230	1074	1132
26-3/4	72	1268	1334	1166	1227
26-3/4	78	1301	1367	1196	1258
26-3/4	84	1332	1401	1226	1289
26-3/4	90	1365	1435	1255	1320
26-3/4	96	1464	1537	1347	1414
26-3/4	102	1497	1572	1378	1446
26-3/4	108	1529	1606	1407	1477
40-7/8	15	857	906	787	835
40-7/8	18	880	933	810	859
40-7/8	30	979	1036	902	955
40-7/8	36	1029	1089	945	1001
40-7/8	42	1154	1217	1061	1120
40-7/8	48	1204	1269	1107	1167
40-7/8	54	1367	1435	1258	1320
40-7/8	60	1416	1488	1303	1368
40-7/8	66	1465	1539	1348	1416
40-7/8	72	1557	1634	1433	1503
40-7/8	78	1641	1720	1509	1582
40-7/8	84	1689	1772	1554	1631
40-7/8	90	1739	1823	1599	1679
40-7/8	96	1864	1953	1714	1798
40-7/8	102	1913	2004	1761	1844
40-7/8	108	1963	2057	1806	1893
42-3/8	15	862	910	792	839
42-3/8	18	885	938	814	864
42-3/8	30	990	1044	909	962
42-3/8	36	1039	1099	957	1011
42-3/8	42	1166	1229	1072	1131
42-3/8	48	1217	1284	1120	1182
56-1/2	15	979	1032	902	948
56-1/2	18	1013	1068	933	981
56-1/2	30	1150	1212	1058	1115
56-1/2	36	1217	1284	1120	1182
56-1/2	42	1379	1449	1268	1332
56-1/2	48	1446	1521	1331	1399

To order a Custom Color for Dossier please use the code ZCCWS. A one time 897 list charge per color applies.