

wall panels

Z J W F M

Full Wall Panel – Above Credenza, Magnetic Veneer

WHAT'S INCLUDED

1 full wall panel.

NOTES

Heights 42-3/8" (42) and 56-1/2" (56) are only available in Widths 15" - 48".

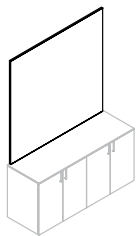

PRODUCT OPTIONS

Grain Direction	Height	Width	Finish
H Horizontal	12 12-5/8"	15, 18, 30, 36, 42, 48, 54, 60, 66, 72, 78, 84, 90	Flintwood Natural Veneer CWS Custom Wood Stain
V Vertical	26 26-3/4"		
	40 40-7/8"		
	42 42-3/8"		
	56 56-1/2"		

SAMPLE ORDER CODE

ZJWFM V	42	84	VE
----------------	-----------	-----------	-----------

DIMENSIONS FOR MM X BY 25.4

H	W
12-5/8	15
12-5/8	18
12-5/8	30
12-5/8	36
12-5/8	42
12-5/8	48
12-5/8	54
12-5/8	60
12-5/8	66
12-5/8	72
12-5/8	78
12-5/8	84
12-5/8	90

PRICING

VENEER		FLINTWOOD	
Vertical Grain	Horizontal Grain	Vertical Grain	Horizontal Grain
887	931	887	931
911	957	911	957
1082	1137	1082	1137
1130	1186	1130	1186
1173	1232	1173	1232
1219	1281	1219	1281
1460	1535	1460	1535
1507	1582	1507	1582
1550	1627	1550	1627
1638	1720	1638	1720
1683	1767	1683	1767
1728	1815	1728	1815
1815	1905	1815	1905

Pricing and upcharges continued on the following page.

Z J W F M
Full Wall Panel – Above Credenza,
Magnetic Veneer (Continued)

**DIMENSIONS
 FOR MM X BY 26PRIC**

H	W	VENEER		FLINTWOOD	
		Vertical Grain	Horizontal Grain	Vertical Grain	Horizontal Grain
26-3/4	15	1071	1124	1071	1124
26-3/4	18	1121	1176	1121	1176
26-3/4	30	1399	1469	1399	1469
26-3/4	36	1498	1573	1498	1573
26-3/4	42	1596	1675	1596	1675
26-3/4	48	1695	1779	1695	1779
26-3/4	54	1992	2090	1992	2090
26-3/4	60	2089	2192	2089	2192
26-3/4	66	2188	2297	2188	2297
26-3/4	72	2328	2444	2328	2444
26-3/4	78	2426	2547	2426	2547
26-3/4	84	2525	2651	2525	2651
26-3/4	90	2663	2797	2663	2797
40-7/8	15	1271	1336	1271	1336
40-7/8	18	1328	1394	1328	1394
40-7/8	30	1603	1684	1603	1684
40-7/8	36	1783	1871	1783	1871
40-7/8	42	1921	2017	1921	2017
40-7/8	48	2059	2161	2059	2161
40-7/8	54	2393	2511	2393	2511
40-7/8	60	2572	2702	2572	2702
40-7/8	66	2711	2848	2711	2848
40-7/8	72	2890	3033	2890	3033
40-7/8	78	3028	3178	3028	3178
40-7/8	84	3166	3325	3166	3325
40-7/8	90	3385	3554	3385	3554
42-3/8	15	1271	1336	1271	1336
42-3/8	18	1343	1411	1343	1411
42-3/8	30	1630	1712	1630	1712
42-3/8	36	1813	1904	1813	1904
42-3/8	42	1955	2053	1955	2053
42-3/8	48	2100	2205	2100	2205
56-1/2	15	1438	1510	1438	1510
56-1/2	18	1534	1609	1534	1609
56-1/2	30	1912	2007	1912	2007
56-1/2	36	2143	2248	2143	2248
56-1/2	42	2330	2448	2330	2448
56-1/2	48	2560	2688	2560	2688

To order a Custom Color for Dossier please use the code ZCCWS. A one time 1182 list charge per color applies.