

ZJWFG

Full Wall Panel – Above Credenza, Glass

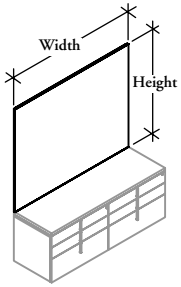

WHAT'S INCLUDED

1 full wall panel.

NOTES

Heights 42-3/8" (42) and 56-1/2" (56) are only available in Widths 15" - 48".

Grain Direction is only required for Natural Veneer finish.

Horizontal grain direction Veneer Group 4 only.

Flintwood available in Open Pore finish only.

448

PRODUCT OPTIONS

| Height | Width | Finish |
|------------|--|--|
| 12 12-5/8" | 15, 18, 30, 36, 42, 48, 54, 60, 66, 72, 78, 84, 90, 96, 102, 108 | K7 Very White Backpainted Glass K1 Storm White Backpainted Glass J6 Gris Backpainted Glass K8 Graphic Steel Backpainted Glass |
| 26 26-3/4" | | |
| 40 40-7/8" | | |
| 42 42-3/8" | | |
| 56 56-1/2" | | |

SAMPLE ORDER CODE

| | | |
|----------|-----|----|
| ZJWFG 42 | 102 | K6 |
|----------|-----|----|

DIMENSIONS FOR MM X BY 25.4

| H | W |
|--------|-----|
| 12-5/8 | 15 |
| 12-5/8 | 18 |
| 12-5/8 | 30 |
| 12-5/8 | 36 |
| 12-5/8 | 42 |
| 12-5/8 | 48 |
| 12-5/8 | 54 |
| 12-5/8 | 60 |
| 12-5/8 | 66 |
| 12-5/8 | 72 |
| 12-5/8 | 78 |
| 12-5/8 | 84 |
| 12-5/8 | 90 |
| 12-5/8 | 96 |
| 12-5/8 | 102 |
| 12-5/8 | 108 |

PRICING

MAGNETIC BACK-PAINTED GLASS

| |
|------|
| 1105 |
| 1160 |
| 1383 |
| 1495 |
| 1666 |
| 1778 |
| 2003 |
| 2114 |
| 2226 |
| 2397 |
| 2509 |
| 2620 |
| 2732 |
| 2902 |
| 3014 |
| 3125 |

To order a Custom Color for Dossier please use the code ZCCWS. A one time 897 list charge per color applies.

Pricing is continued on the following page.

Z J W F G

**Full Wall Panel – Above Credenza,
Glass (Continued)**

**DIMENSIONS
FOR MM X BY 25.4**

PRICING

**MAGNETIC
BACK-PAINTED GLASS**

| H | W | |
|--------|-----|------|
| 26-3/4 | 15 | 1519 |
| 26-3/4 | 18 | 1636 |
| 26-3/4 | 30 | 2109 |
| 26-3/4 | 36 | 2345 |
| 26-3/4 | 42 | 2649 |
| 26-3/4 | 48 | 2884 |
| 26-3/4 | 54 | 3236 |
| 26-3/4 | 60 | 3472 |
| 26-3/4 | 66 | 3708 |
| 26-3/4 | 72 | 4012 |
| 26-3/4 | 78 | 4248 |
| 26-3/4 | 84 | 4485 |
| 26-3/4 | 90 | 4720 |
| 26-3/4 | 96 | 5025 |
| 26-3/4 | 102 | 5261 |
| 26-3/4 | 108 | 5497 |
| 40-7/8 | 15 | 1933 |
| 40-7/8 | 18 | 2112 |
| 40-7/8 | 30 | 2835 |
| 40-7/8 | 36 | 3195 |
| 40-7/8 | 42 | 3631 |
| 40-7/8 | 48 | 3993 |
| 40-7/8 | 54 | 4468 |
| 40-7/8 | 60 | 4830 |
| 40-7/8 | 66 | 5191 |
| 40-7/8 | 72 | 5594 |
| 40-7/8 | 78 | 5988 |
| 40-7/8 | 84 | 6350 |
| 40-7/8 | 90 | 6711 |
| 40-7/8 | 96 | 7147 |
| 40-7/8 | 102 | 7509 |
| 40-7/8 | 108 | 7869 |
| 42-3/8 | 15 | 1965 |
| 42-3/8 | 18 | 2152 |
| 42-3/8 | 30 | 2901 |
| 42-3/8 | 36 | 3275 |
| 42-3/8 | 42 | 3724 |
| 42-3/8 | 48 | 4099 |
| 56-1/2 | 15 | 2353 |
| 56-1/2 | 18 | 2603 |
| 56-1/2 | 30 | 3601 |
| 56-1/2 | 36 | 4099 |
| 56-1/2 | 42 | 4691 |
| 56-1/2 | 48 | 5191 |

To order a Custom Color for Dossier please use the code ZCCWS. A one time 897 list charge per color applies.