

wall panels

ZJWFF

Full Wall Panel – Above Credenza, Fabric

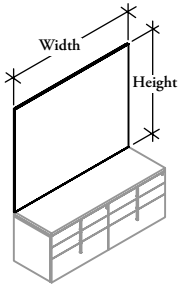

WHAT'S INCLUDED

1 full wall panel.

NOTES

Heights 42-3/8" (42) and 56-1/2" (56) are only available in Widths 15" - 48".

Grain Direction is only required for Natural Veneer finish.

Horizontal grain direction Veneer Group 4 only.

Flintwood available in Open Pore finish only.

PRODUCT OPTIONS

Height	Width	Finish
12 12-5/8"	15, 18, 30, 36, 42, 48, 54, 60, 66, 72, 78, 84, 90, 96, 102, 108	Panel Fabrics
26 26-3/4"		
40 40-7/8"		
42 42-3/8"		
56 56-1/2"		

SAMPLE ORDER CODE

ZJWFF 42	102	K6
----------	-----	----

DIMENSIONS FOR MM X BY 25.4

H	W
12-5/8	15
12-5/8	18
12-5/8	30
12-5/8	36
12-5/8	42
12-5/8	48
12-5/8	54
12-5/8	60
12-5/8	66
12-5/8	72
12-5/8	78
12-5/8	84
12-5/8	90

PRICING

FABRIC								
COM	Gr. A	Gr. 1	Gr. 2	Gr. 3	Gr. 4	Gr. 5	Gr. 6	Gr. 7
1242	1266	1420	1505	1578	1655	1806	1909	
1249	1273	1427	1511	1587	1662	1815	1916	
1276	1300	1451	1536	1612	1688	1840	1942	
1289	1313	1466	1549	1625	1701	1853	1955	
1382	1404	1558	1643	1717	1793	1945	2046	
1395	1416	1569	1655	1732	1804	1957	2059	
1559	1580	1734	1819	1894	1970	2123	2221	
1571	1594	1747	1833	1908	1981	2132	2236	
1585	1608	1761	1843	1920	1996	2147	2249	
1675	1698	1853	1937	2011	2088	2241	2343	
1689	1712	1864	1949	2025	2100	2252	2352	
1702	1725	1878	1964	2039	2115	2264	2368	
1714	1738	1891	1973	2051	2126	2277	2380	

Pricing and upcharges continued on the following page.

Z J W F F
Full Wall Panel – Above Credenza,
Fabric (Continued)

**DIMENSIONS
 FOR MM X BY 25.4**

PRICING

		FABRIC							
		COM	Gr. A	Gr. 1	Gr. 2	Gr. 3	Gr. 4	Gr. 5	Gr. 6
H	W								
26-3/4	15	1413	1437	1590	1674	1750	1825	1978	2081
26-3/4	18	1429	1450	1605	1688	1763	1840	1992	2094
26-3/4	30	1485	1507	1661	1743	1820	1895	2047	2149
26-3/4	36	1514	1535	1689	1772	1848	1923	2076	2177
26-3/4	42	1630	1652	1804	1890	1966	2042	2192	2294
26-3/4	48	1656	1682	1834	1919	1995	2068	2219	2323
26-3/4	54	1836	1859	2011	2096	2173	2248	2397	2501
26-3/4	60	1863	1887	2040	2124	2201	2275	2426	2530
26-3/4	66	1891	1914	2068	2152	2227	2303	2455	2557
26-3/4	72	2009	2030	2185	2268	2346	2421	2573	2675
26-3/4	78	2038	2059	2214	2297	2375	2450	2600	2704
26-3/4	84	2066	2088	2242	2326	2401	2477	2627	2729
26-3/4	90	2093	2117	2268	2351	2427	2503	2655	2758
40-7/8	15	1586	1608	1762	1846	1921	1998	2148	2250
40-7/8	18	1607	1630	1783	1865	1942	2017	2170	2271
40-7/8	30	1692	1714	1870	1952	2028	2102	2256	2355
40-7/8	36	1734	1759	1912	1995	2069	2145	2297	2398
40-7/8	42	1878	1900	2053	2139	2214	2291	2441	2543
40-7/8	48	1920	1943	2096	2178	2256	2332	2481	2586
40-7/8	54	2114	2138	2291	2375	2450	2524	2676	2778
40-7/8	60	2155	2177	2333	2417	2494	2568	2719	2822
40-7/8	66	2201	2220	2377	2460	2536	2611	2762	2864
40-7/8	72	2297	2320	2473	2557	2632	2709	2861	2964
40-7/8	78	2384	2408	2560	2645	2721	2797	2949	3051
40-7/8	84	2427	2451	2602	2687	2763	2840	2990	3091
40-7/8	90	2470	2495	2646	2729	2805	2881	3032	3135
42-3/8	15	1588	1612	1766	1850	1924	2000	2152	2255
42-3/8	18	1611	1634	1789	1871	1946	2023	2174	2276
42-3/8	30	1699	1721	1877	1962	2037	2112	2263	2366
42-3/8	36	1743	1767	1921	2004	2081	2155	2306	2410
42-3/8	42	1888	1912	2066	2148	2225	2300	2452	2554
42-3/8	48	1934	1955	2111	2192	2268	2346	2497	2598
56-1/2	15	1726	1748	1904	1987	2064	2139	2291	2392
56-1/2	18	1757	1777	1930	2015	2093	2169	2320	2421
56-1/2	30	1875	1895	2051	2132	2211	2288	2436	2540
56-1/2	36	1934	1955	2111	2192	2268	2346	2497	2598
56-1/2	42	2115	2138	2292	2376	2451	2525	2677	2781
56-1/2	48	2174	2197	2350	2434	2509	2586	2736	2840

To order a Custom Color for Dossier please use the code ZCCWS. A one time 1182 list charge per color applies.