

ZJWCH

Wall Panel, Open Shelves Combination – Above Credenza

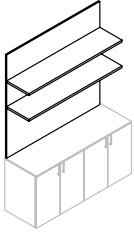

WHAT'S INCLUDED

1 wall panel with shelves (as specified), wood wall cleats, backpainted glass lower portion

NOTES

42-3/8" height will have one shelf.

56-1/2" height will have one or two shelves depending on the number of shelves specified.

56-1/2" height will have a maximum width of 60".

Shelves align with current Dossier datum heights.

Sliding Door, Cubby and Top options are not available.

This is a Full Height Wall Panel and is not intended to be specified with a storage cabinet installed above it.

464

PRODUCT OPTIONS

| Grain Direction | Height | Depth | Width | Number of Shelves | Top Panel Finish | Bottom Panel Finish |
|---------------------|------------------|------------------|--|----------------------|--|--|
| H Horizontal | 42 42-3/8 | 12 12 | 030, 036, 042, 048, 054, 060, 066, 072, 078, 084, 090, 096, 102, 108 | 1 1 Shelf | Flintwood | K7 Very White |
| V Vertical | 56 56-1/2 | 15 15-1/2 | | 2 Two Shelves | Natural Veneer CWS Custom Wood Stain | K1 Storm White J6 Gris K8 Graphic Steel |

SAMPLE ORDER CODE

| | | | | | | |
|----------------|-----------|-----------|------------|----------|-----------|-----------|
| ZJWCH V | 42 | 15 | 060 | 1 | VE | K7 |
|----------------|-----------|-----------|------------|----------|-----------|-----------|

DIMENSIONS FOR MM X BY 25.4

| H | D | W |
|--------|----|-----|
| 42-3/8 | 12 | 30 |
| 42-3/8 | 12 | 36 |
| 42-3/8 | 12 | 42 |
| 42-3/8 | 12 | 48 |
| 42-3/8 | 12 | 54 |
| 42-3/8 | 12 | 60 |
| 42-3/8 | 12 | 66 |
| 42-3/8 | 12 | 72 |
| 42-3/8 | 12 | 78 |
| 42-3/8 | 12 | 84 |
| 42-3/8 | 12 | 90 |
| 42-3/8 | 12 | 96 |
| 42-3/8 | 12 | 102 |
| 42-3/8 | 12 | 108 |

PRICING

| FLINTWOOD | | VENEER | |
|-----------|------|-----------|------|
| One Shelf | | One Shelf | |
| 1940 | 1952 | 1952 | 1952 |
| 2103 | 2117 | 2117 | 2117 |
| 2265 | 2282 | 2282 | 2282 |
| 2428 | 2447 | 2447 | 2447 |
| 2814 | 2835 | 2835 | 2835 |
| 2976 | 3000 | 3000 | 3000 |
| 3139 | 3165 | 3165 | 3165 |
| 3301 | 3330 | 3330 | 3330 |
| 3493 | 3525 | 3525 | 3525 |
| 3848 | 3881 | 3881 | 3881 |
| 4010 | 4046 | 4046 | 4046 |
| 4173 | 4211 | 4211 | 4211 |
| 4559 | 4600 | 4600 | 4600 |
| 4721 | 4764 | 4764 | 4764 |

Pricing is continued on the following page.

Z J W C H
Wall Panel, Open Shelves
Combination – Above Credenza
(Continued)

DIMENSIONS
FOR MM X BY 25.4

| H | D | W |
|--------|--------|-----|
| 42-3/8 | 15-1/2 | 30 |
| 42-3/8 | 15-1/2 | 36 |
| 42-3/8 | 15-1/2 | 42 |
| 42-3/8 | 15-1/2 | 48 |
| 42-3/8 | 15-1/2 | 54 |
| 42-3/8 | 15-1/2 | 60 |
| 42-3/8 | 15-1/2 | 66 |
| 42-3/8 | 15-1/2 | 72 |
| 42-3/8 | 15-1/2 | 78 |
| 42-3/8 | 15-1/2 | 84 |
| 42-3/8 | 15-1/2 | 90 |
| 42-3/8 | 15-1/2 | 96 |
| 42-3/8 | 15-1/2 | 102 |
| 42-3/8 | 15-1/2 | 108 |

PRICING

| FLINTWOOD | | VENEER |
|------------------|--|---------------|
| One Shelf | | One Shelf |
| 2000 | | 2015 |
| 2169 | | 2185 |
| 2337 | | 2356 |
| 2505 | | 2527 |
| 2897 | | 2922 |
| 3065 | | 3092 |
| 3233 | | 3263 |
| 3401 | | 3434 |
| 3599 | | 3636 |
| 3959 | | 3998 |
| 4127 | | 4169 |
| 4295 | | 4339 |
| 4687 | | 4735 |
| 4855 | | 4906 |

| | | |
|--------|--------|----|
| 56-1/2 | 12 | 30 |
| 56-1/2 | 12 | 36 |
| 56-1/2 | 12 | 42 |
| 56-1/2 | 12 | 48 |
| 56-1/2 | 12 | 54 |
| 56-1/2 | 12 | 60 |
| 56-1/2 | 15-1/2 | 30 |
| 56-1/2 | 15-1/2 | 36 |
| 56-1/2 | 15-1/2 | 42 |
| 56-1/2 | 15-1/2 | 48 |
| 56-1/2 | 15-1/2 | 54 |
| 56-1/2 | 15-1/2 | 60 |

| FLINTWOOD | | VENEER | |
|------------------|-------------|---------------|-------------|
| One Shelf | Two Shelves | One Shelf | Two Shelves |
| 2288 | 2485 | 2312 | 2510 |
| 2505 | 2696 | 2530 | 2723 |
| 2721 | 2907 | 2748 | 2936 |
| 2937 | 3116 | 2967 | 3148 |
| 3153 | 3615 | 3185 | 3651 |
| 3401 | 3826 | 3435 | 3864 |
| 2348 | 2372 | 2573 | 2598 |
| 2571 | 2596 | 2796 | 2824 |
| 2793 | 2820 | 3017 | 3048 |
| 3014 | 3045 | 3240 | 3273 |
| 3268 | 3301 | 3751 | 3789 |
| 3490 | 3525 | 3972 | 4012 |