

stacking storage

ZJSO

Stack On Storage – Open

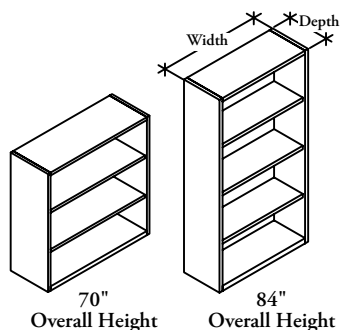

WHAT'S INCLUDED

1 open cabinet with fixed shelves.

NOTES

Overall Height 84" cabinet is **not** available with widths 15" and 18".

Overall Height 70" cabinet has three shelves.

Overall Height 84" cabinet has four shelves.

Horizontal grain direction Veneer Group 4 only.

Flintwood available in Open Pore finish only.

PRODUCT OPTIONS

Overall Height	Surface Height	Grain Direction	Depth	Width	Finish
70, 84	27 27-1/2" 29 29"	H Horizontal V Vertical	12 12" 15 15-1/2"	15, 18, 30, 36, 42	Flintwood Natural Veneer CWS Custom Wood Stain

SAMPLE ORDER CODE

ZJSO 70	29	V	15	18	DV
----------------	-----------	----------	-----------	-----------	-----------

DIMENSIONS INCHES / MM

Overall H	Surface "H"	D	W
70 / 1778	27 / 686	12 / 305	15 / 381
70 / 1778	27 / 686	12 / 305	18 / 457
70 / 1778	27 / 686	12 / 305	30 / 762
70 / 1778	27 / 686	12 / 305	36 / 914
70 / 1778	27 / 686	12 / 305	42 / 1067
70 / 1778	27 / 686	15.5 / 394	15 / 381
70 / 1778	27 / 686	15.5 / 394	18 / 457
70 / 1778	27 / 686	15.5 / 394	30 / 762
70 / 1778	27 / 686	15.5 / 394	36 / 914
70 / 1778	27 / 686	15.5 / 394	42 / 1067
70 / 1778	29 / 737	12 / 305	15 / 381
70 / 1778	29 / 737	12 / 305	18 / 457
70 / 1778	29 / 737	12 / 305	30 / 762
70 / 1778	29 / 737	12 / 305	36 / 914
70 / 1778	29 / 737	12 / 305	42 / 1067
70 / 1778	29 / 737	15.5 / 394	15 / 381
70 / 1778	29 / 737	15.5 / 394	18 / 457
70 / 1778	29 / 737	15.5 / 394	30 / 762
70 / 1778	29 / 737	15.5 / 394	36 / 914
70 / 1778	29 / 737	15.5 / 394	42 / 1067

PRICING

VENEER		FLINTWOOD	
Vertical Grain	Horizontal Grain	Vertical Grain	Horizontal Grain
2225	2376	2068	2207
2304	2462	2144	2290
2673	2851	2482	2653
2833	3024	2634	2811
3039	3241	2827	3014
2446	2605	2272	2423
2539	2707	2363	2518
2959	3155	2753	2935
3147	3356	2927	3120
3380	3604	3145	3351
2383	2532	2217	2354
2465	2618	2292	2434
2965	3142	2757	2922
3122	3312	2905	3079
3515	3711	3268	3453
2598	2760	2419	2566
2692	2859	2502	2659
3248	3441	3021	3199
3432	3639	3192	3384
3848	4070	3579	3784

To order a Custom Color for Dossier please use the code ZCCWS. A one time 1182 list charge per color applies.

See pricing on following page.

Z J S O
Stack On Storage – Open
(Continued)

DIMENSIONS

INCHES / MM

Overall H	Surface "H"	D	W
84 / 2134	27 / 686	12 / 305	30 / 762
84 / 2134	27 / 686	12 / 305	36 / 914
84 / 2134	27 / 686	12 / 305	42 / 1067
84 / 2134	27 / 686	15.5 / 394	30 / 762
84 / 2134	27 / 686	15.5 / 394	36 / 914
84 / 2134	27 / 686	15.5 / 394	42 / 1067
84 / 2134	29 / 737	12 / 305	30 / 762
84 / 2134	29 / 737	12 / 305	36 / 914
84 / 2134	29 / 737	12 / 305	42 / 1067
84 / 2134	29 / 737	15.5 / 394	30 / 762
84 / 2134	29 / 737	15.5 / 394	36 / 914
84 / 2134	29 / 737	15.5 / 394	42 / 1067

PRICING

VENEER

Vertical Grain	Horizontal Grain
3086	3279
3262	3472
3487	3706
3406	3619
3611	3838
3864	4106
3377	3570
3554	3756
3960	4176
3695	3906
3898	4120
4333	4572

FLINTWOOD

Vertical Grain	Horizontal Grain
2871	3050
3032	3228
3242	3449
3169	3367
3359	3570
3593	3818
3142	3321
3305	3493
3685	3885
3436	3632
3625	3834
4028	4251

To order a Custom Color for Dossier please use the code ZCCWS. A one time 1182 list charge per color applies.