

# bridge returns

## ZJBH

### Bridge Return for Standard Desk with Full Back Panel & Overlap Credenza Connection

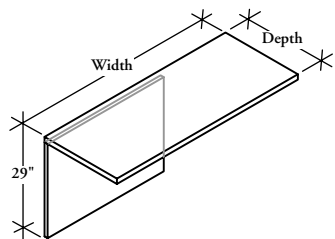

#### WHAT'S INCLUDED

1 bridge return with full back panel, worksurface grommet (if specified), connection hardware.

#### NOTES

Round Grommet is only available in Satin Nickel Coordinate (I) and Ebony (E).

Horizontal grain direction Veneer Group 4 only.

Flintwood available in Open Pore finish only.

#### PRODUCT OPTIONS

Grain Direction	Credenza Depth	Depth	Width (6" increments)	Orientation	Finish	Grommet Style	Grommet Finish
<b>H</b> Horizontal	<b>1</b> 20	20, 24	60 - 78	<b>L</b> Left <b>R</b> Right	Flintwood	<b>N</b> No Grommet <b>C</b> Rectangular Grommet Centered <b>F</b> Round Grommet Centered	<b>A</b> Satin Nickel
<b>V</b> Vertical	<b>2</b> 24				Natural Veneer <b>CWS</b> Custom Wood Stain		<b>E</b> Ebony <b>7</b> Platinum <b>V</b> Very White <b>I</b> Satin Nickel Coordinate <b>X</b> Anthracite <b>2</b> Burnished Bronze <b>S</b> Sepia Bronze <b>M</b> Graphite <b>F</b> Titanium Grey <b>1</b> Gilded Ash

#### SAMPLE ORDER CODE

<b>ZJBH H</b>	<b>1</b>	<b>24</b>	<b>72</b>	<b>R</b>	<b>DV</b>	<b>C</b>	<b>A</b>
---------------	----------	-----------	-----------	----------	-----------	----------	----------

#### DIMENSIONS

INCHES / MM

CREDENZA		
D	D	W
20 / 508	20 / 508	60 / 1524
20 / 508	20 / 508	66 / 1676
20 / 508	20 / 508	72 / 1829
20 / 508	20 / 508	78 / 1981
20 / 508	24 / 610	60 / 1524
20 / 508	24 / 610	66 / 1676
20 / 508	24 / 610	72 / 1829
20 / 508	24 / 610	78 / 1981

#### PRICING

FLINTWOOD		VENEER	
Vertical Grain	Horizontal Grain	Vertical Grain	Horizontal Grain
1561	1697	1751	1907
1650	1793	1853	2014
1739	1888	1954	2122
1831	1984	2055	2229
1629	1770	1831	1988
1728	1873	1940	2104
1825	1955	2050	2221
1921	2056	2158	2310

If Rectangular Grommet, Painted is specified, add 189

If Rectangular Grommet, Satin Nickel (A) is specified, add 234

If Round Grommet, Ebony (E) is specified, add 138

If Round Grommet, Satin Nickel Coordinate (I) is specified, add 200

To order a Custom Color for Dossier please use the code ZCCWS. A one time 1019 list charge per color applies.