

understanding credenzas

Dossier credenzas are available in a variety of heights and configurations to provide aesthetics and functionality.

high credenzas

High credenzas have unfinished tops, so require a credenza top to complete the configuration.

Heights:

- 26" for an overall height of 27-1/2"
- 27-1/2" for an overall height of 29"

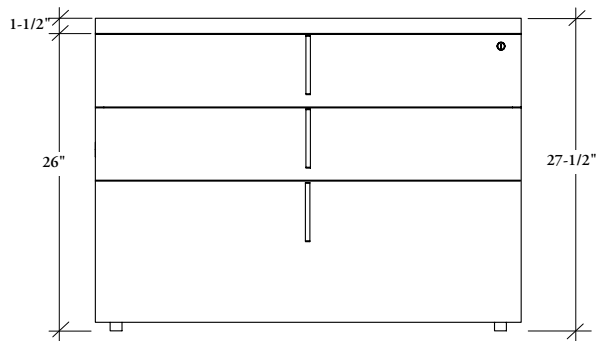

27-1/2" high credenzas are typically used when a Bridge or Run-Off overlaps the credenza.

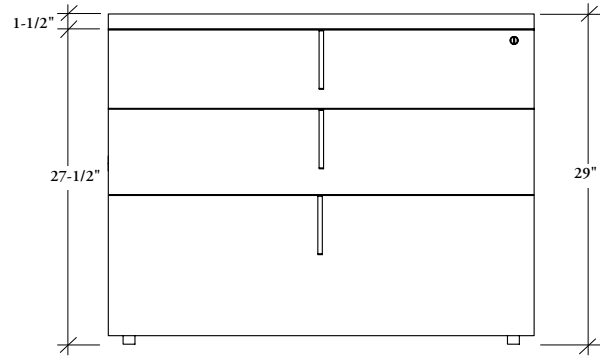

29" high credenzas are typically used when a Bridge or Run-Off mounts flush to a credenza, or in freestanding applications.

low credenzas

Low credenzas are available:

- with a finished top that does not require a credenza top
- with an unfinished top that requires a credenza top to complete the configuration

Heights:

- 19-5/8" with no credenza top
- 19-5/8" with a credenza top for an overall height of 21-1/8"

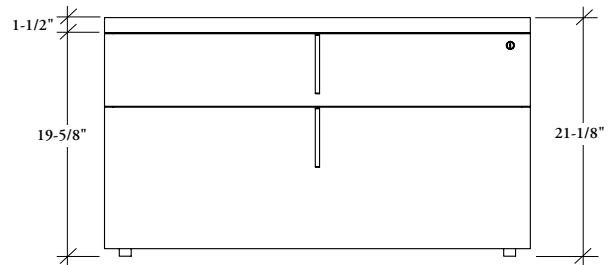
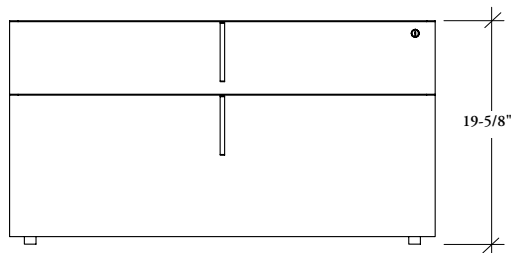

Are typically used

- with when a lighter aesthetic is desired
- with a worksurface with a spacer to fill the space between the worksurface and the credenza

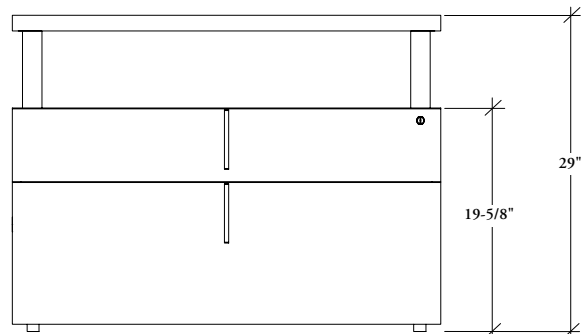
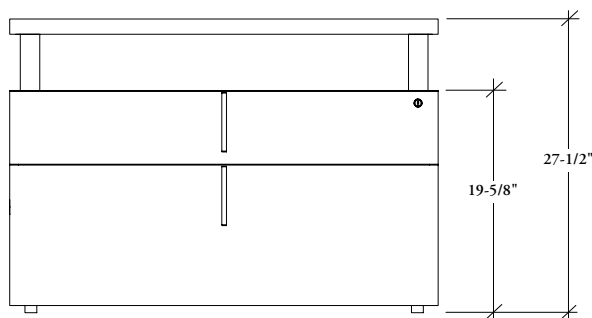

Spacers are available to elevate the worksurface to the desired height.

credenza basics

Dossier Credenzas consist of a variety of storage units, supports and tops to create open or closed storage, knee spaces and electrical access.



high units for use with credenza top

Cabinets do not have finished tops, so require a credenza top.

Heights:

- 26" (when used with a credenza top provides a 27-1/2" overall height)
- 27-1/2" (when used with a credenza top provides a 29" overall height)

Depths: 20" and 24"

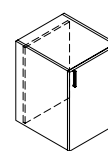
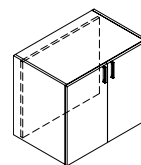
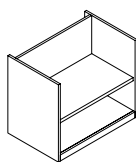
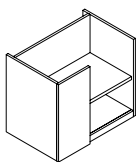
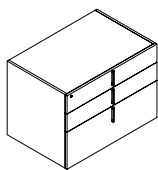
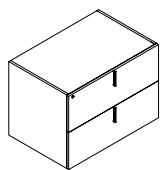

Filing Cabinet – High, for use with Credenza Top (ZJFF)

- Configurations:
 - Box, box, file
 - File, file
- Widths: 18", 30" and 36"
- Counterweights:
 - Required in freestanding applications, not when components are ganged
 - 18" wide, one counterweight required
 - For 30" and 36" wide two counterweights required

Open Cabinet – High, for use with Credenza Top (ZJJC)

- Configurations:
 - Open shelves
 - Open shelves with 12" modesty filler
- Widths:
 - Open Configuration:
 - 15", 18", 30", 36" and 42"
 - Open with Modesty Filler Configuration:
 - 30", 36" and 42"
- Back Options:
 - Unfinished back inset 2" for wire management
 - 6" recessed back to allow for grommets or data/electrical modules

Cabinet with Doors – High, for use with Credenza Top (ZJJD)

- Configurations:
 - Single door
 - Double door
- Widths:
 - Single Door: 15" and 18"
 - Double Door: 30", 36" and 42"
- Back Options:
 - Unfinished back inset 2" for wire management
 - 6" recessed back to allow for grommets or data/electrical modules

credenza basics (continued)

low units for use with credenza top, credenza top height 21-1/8"

The 19-5/8" high unit that does not have a finished top, a credenza top is required.

Heights: 19-5/8" (when used with a credenza top provides a 21-1/8" overall height)

Depths: 20" and 24"

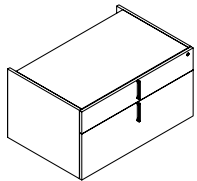

Box, File Cabinet – Low, for use with Credenza Top (ZJQB)

- Configurations: Box, file
- Widths: 18", 30" and 36"
- Back Options:
 - Unfinished back inset 2" for wire management

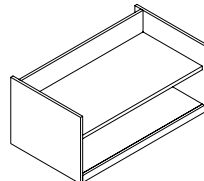

Open Cabinet – Low, for use with Credenza Top (ZJQC)

- Configurations: Open shelves
- Widths:
 - Open Configuration: 15", 18", 30", 36" and 42"
- Back Options:
 - Unfinished back inset 2" for wire management
 - 6" recessed back to allow for grommets or data/electrical modules

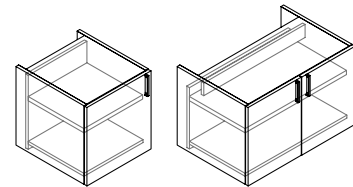

Cabinet with Doors – Low, for use with Credenza Top (ZJQD)

- Configurations:
 - Single door
 - Double door
- Widths:
 - Single Door: 15" and 18"
 - Double Door: 30", 36" and 42"
- Back Options:
 - Unfinished back inset 2" for wire management
 - 6" recessed back to allow for grommets or data/electrical modules

planning with credenzas

Low and high open cabinets are available with or without a top.

When a credenza top is used, it is recommended that the open cabinet with no top be used to avoid the aesthetic of two tops.

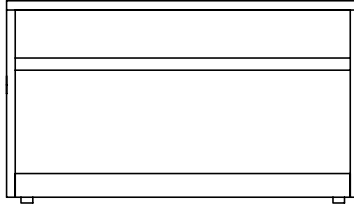
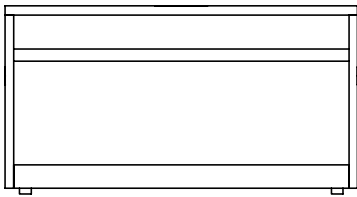

The low cabinet with no top is used when a credenza top is required, therefore avoiding the aesthetic of a double top thickness.

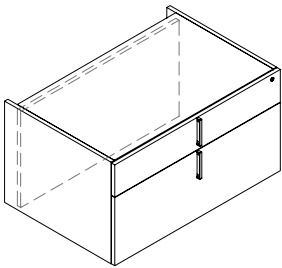

All storage units have a 2" recessed back to allow for wire management.

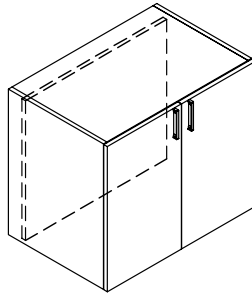

Several of the storage units have an option for a 6" recess for a grommet module or power bar.

planning with low credenza grommets

The following should be considered when planning with low credenza grommets.

low credenza, finished case top

Low Cabinets are available with back panels in two locations:

- 2" from back which will accommodate cables
- 6" from back to accommodate data/electrical modules, rectangular and round grommets

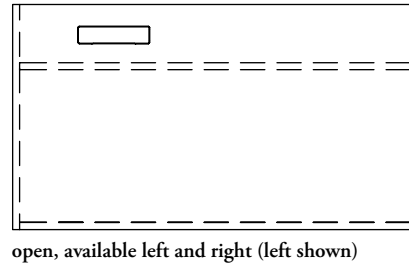
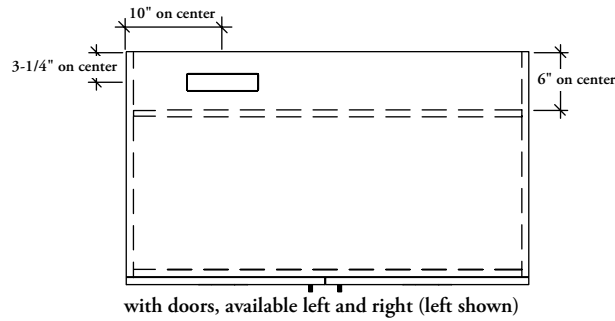

credenza top & spacer basics

The Dossier Credenza Top finishes the top surface of a credenza with no top. Spacers provide a lighter aesthetic by raising the top above a low credenza.



credenza top

Used to complete low and high credenza configurations on credenza units with no tops.

Widths: 15", 18" and 30" to 108" in 6" increments

Height: 1-1/2"

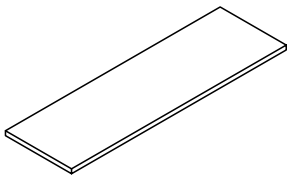

Credenza Top, Full Depth, No Wire Management Access (ZJACN)

- Depths: 20" and 24" deep to match credenza depths

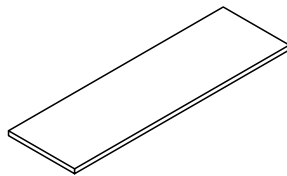

Credenza Top – Full Depth (ZJAC)

- Depths: 20" and 24" deep to match credenza depths
- Grommet and Data Electrical Module Options:
 - Notches on back edge in one, two or three locations

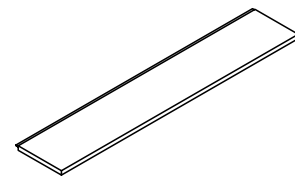

Credenza Top – Reduced Depth, for use with Wall Panels (ZJAD)

- Depths: 17-1/2" and 21-1/2" deep for use with Wall Panels
- Includes a 1" deep brush seal on the full length of the back edge to allow wires to pass from a wall panel to lower storage

credenza spacers

A Credenza Top can be installed at 27-1/2" or 29" high over a low credenza by using a Credenza Spacer. The spacer mounts between the top of the credenza and the underside of the Credenza Top to provide a lighter aesthetic.

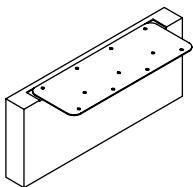

Spacer for Low Credenza (ZJAG)

- Configurations for credenza surface:
 - 29" high on storage without top
 - 29" high on storage with top
 - 27-1/2" on storage without top
 - 27-1/2" on storage with top

planning with credenza tops

The following should be considered when planning with Dossier Credenza Tops.

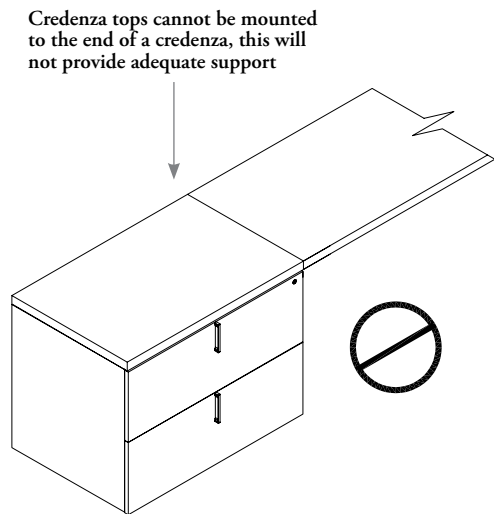

cable management

Reduced depth Credenza Tops are available 17-1/2" deep and 21-1/2" deep and include a brush seal, to allow the Dossier Wall Panel to extend beyond it and cables to route to storage below the Credenza Top.

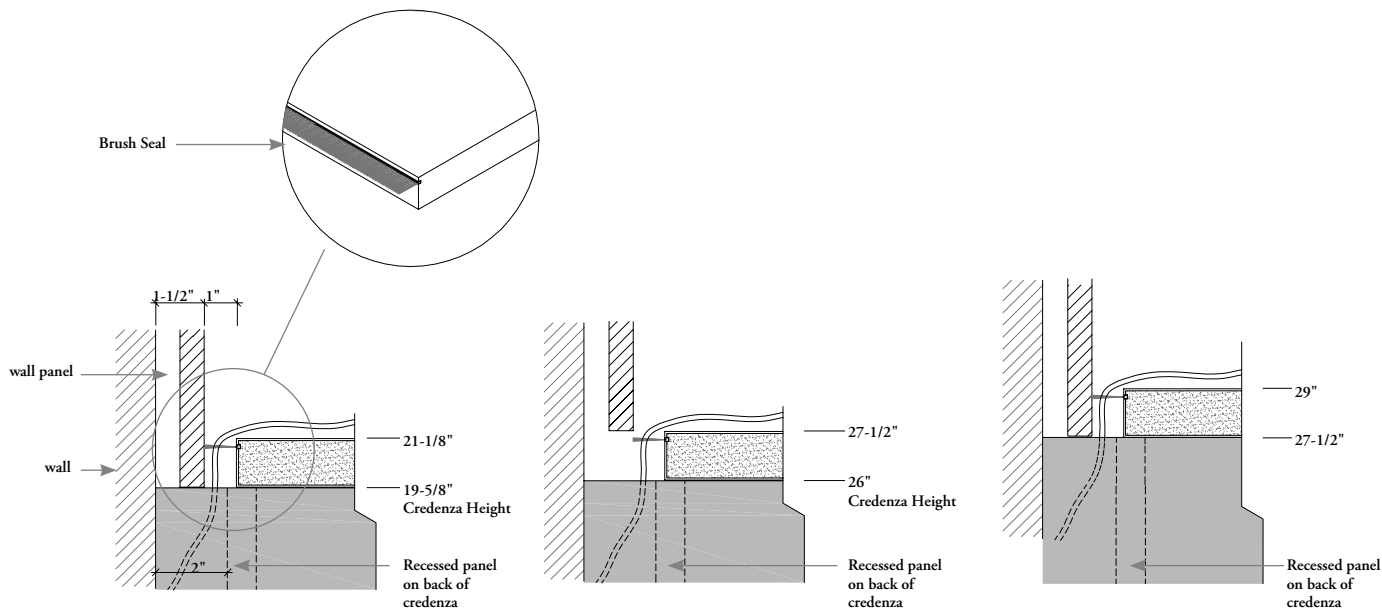

Low Credenza

The wall panel extends to the top of the low credenza.

27-1/2" high credenza

The wall panel extends to the top of the Credenza top, it does not extend down to the credenza.

29" high credenza

The wall panel extends to the top of the high credenza.

planning with credenza spacers

The following should be considered when planning with credenza spacers.

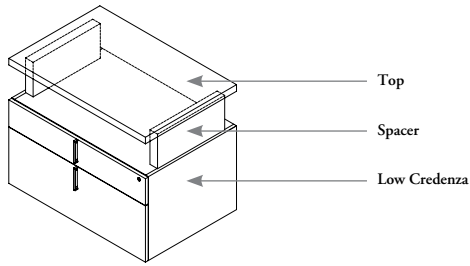

- Spacers are available in three heights:
 - 4-7/8"
 - 6-3/8"
 - 7-7/8"
- Four configurations can be achieved with these heights.

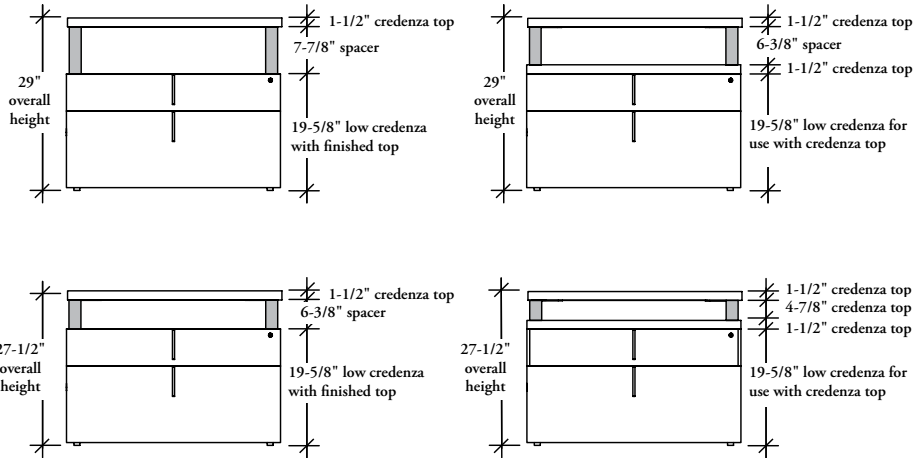

Spacers can be placed either left, right or centered on a unit.

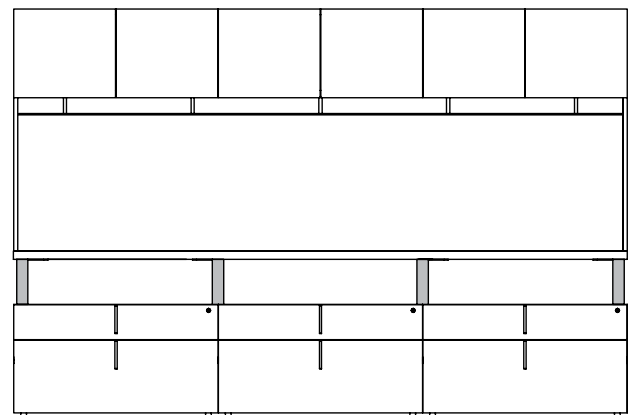
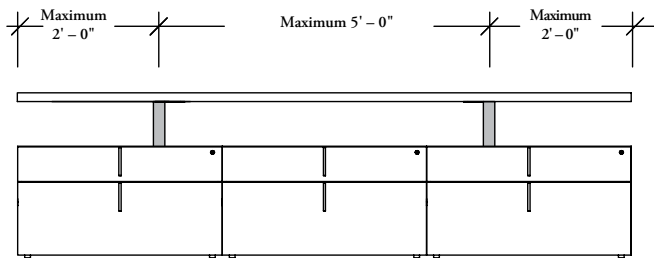

When there is no requirement for vertical load transfer (nothing stacked on the credenza), the following spacer distances apply:

- maximum 2'-0" overhang
- maximum 5'-0" between spaces

When there is a requirement for vertical load transfer (hutches, etc) spacers must be placed over the gables of a credenza unit

planning with credenza top grommets

The following should be considered when planning with credenza tops.

credenza top

- Credenza tops can accommodate cutouts for rectangular grommets, round grommet, data/electrical modules and surface notches
- The cut outs locations are compatible:
 - With a credenza top placed over a credenza run
 - With a Run-Off offset by 6"

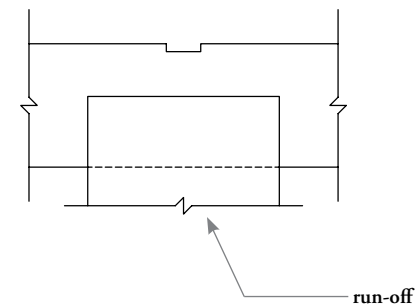
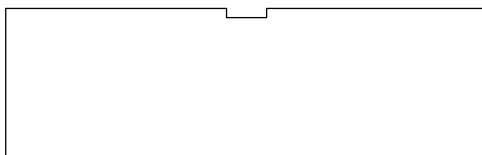
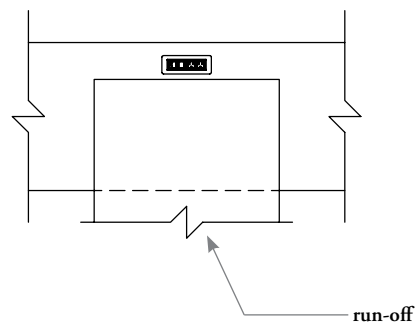
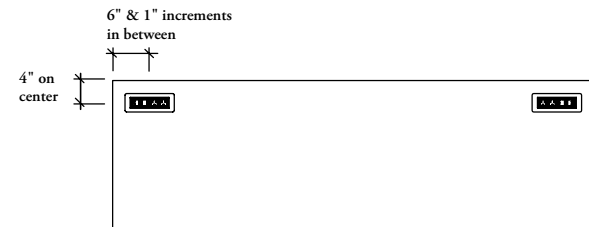
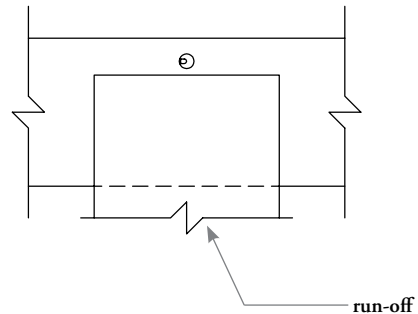
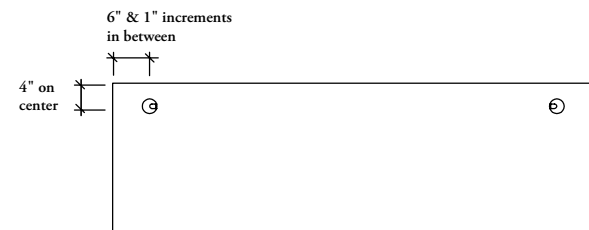
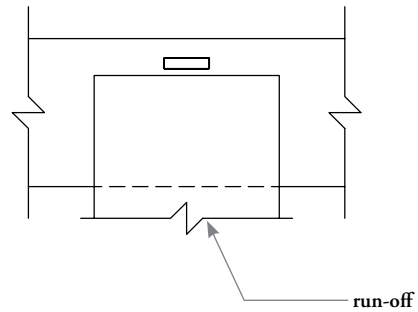
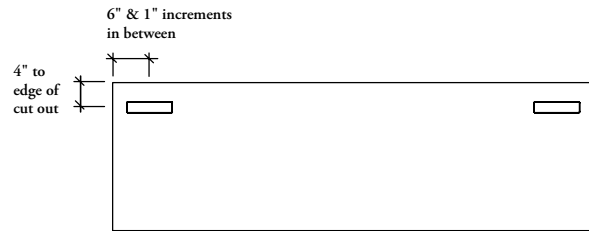

credenza panel basics

Dossier credenza panels are used to complete open spaces in a credenza. They support Credenza Tops, finish the end of a credenza run and provide access to electrical.



Extended L Panel (shown)

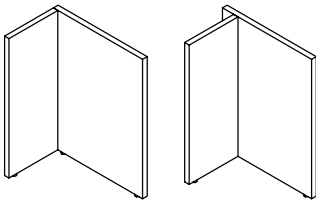

L Panel (ZJAL)

- Provides a full height end panel with a 12" return to support an open credenza configuration
- Depths: 20" and 24"
- Heights: 26" or 27-1/2"
- Return Options:
 - flush to the back of the panel
 - 2-1/2" inset for reduced depth credenza tops

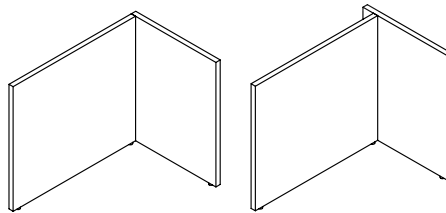

Extended L Panel (ZJAF)

- Provides an end panel and an extended width full height back panel to an open credenza configuration
- Depths: 20" and 24"
- Heights: 26" or 27-1/2"
- Widths: 30" to 66" in 6" increments
- Extended Back Panel Options:
 - flush to the back of the panel
 - 2-1/2" inset for reduced depth credenza tops

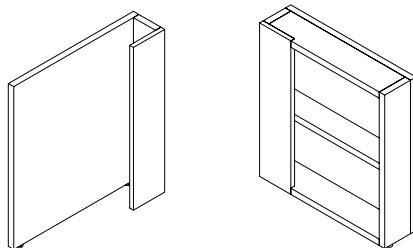

J Panel (ZJAJ)

- Provides a full height end panel to support a credenza top and as an attachment point for the Electrical Access Panel
- Shelving Options:
 - with shelves
 - without shelves
- Depths: 20" and 24"
- Heights: 26" or 27-1/2"
- Width: 6"

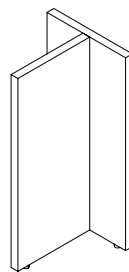

T Panel (ZJAT)

- Provides a full height intermediate support along a Credenza top run
- Depths: 12"
- Heights: 26" or 27-1/2"
- Width: 12"

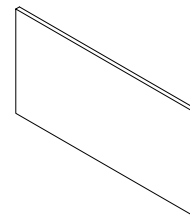

Electrical Access Panel (ZJAE)

- Used to finish open knee spaces between two cabinets or a cabinet and end panel to allow access to wall power
- Styles:
 - Standard (S) which is a solid panel with clips
 - With Doors (D) which has two doors that can be opened to access power
- Depth: 6"
- Height: 18-5/8" and 25" (1" shorter than adjacent credenzas to allow for cable access)
- Widths: 30" to 60" in 6" increments

planning with credenza panels

The following should be considered when planning with Dossier credenza panels.

L panel

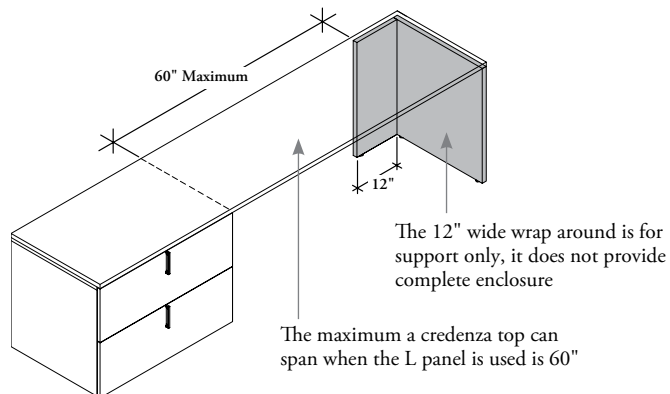

T panel

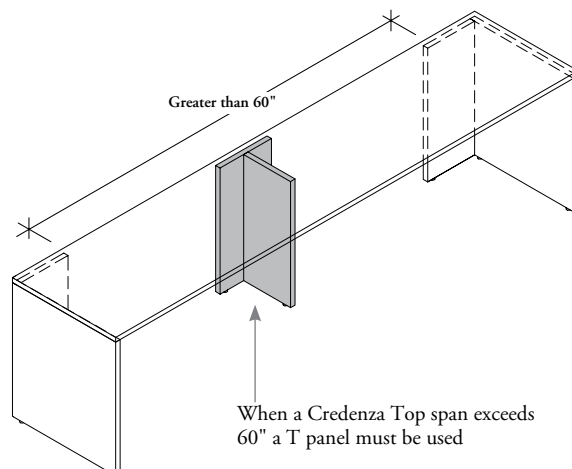

extended L panel

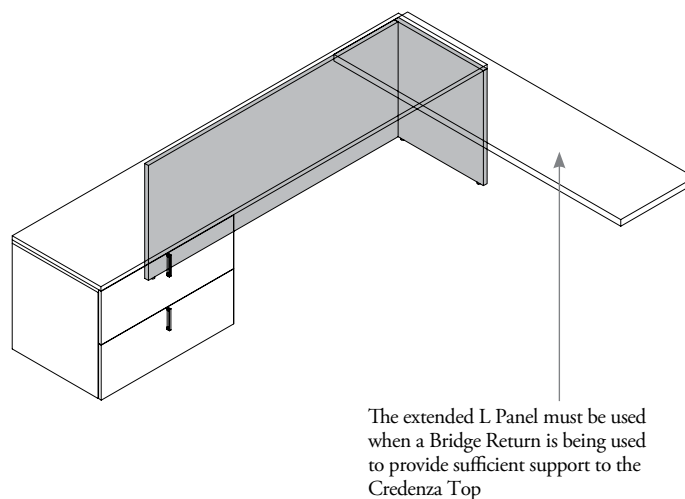
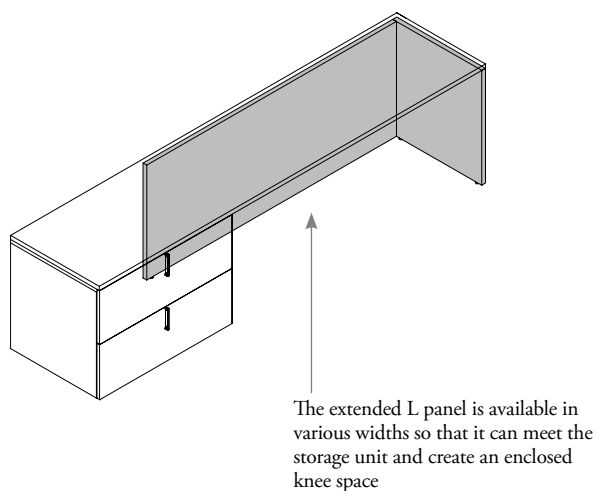

J panel

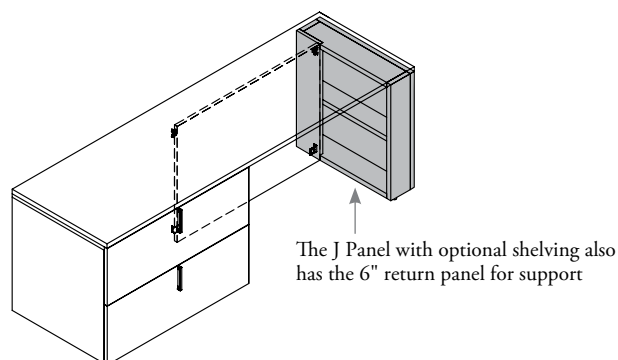
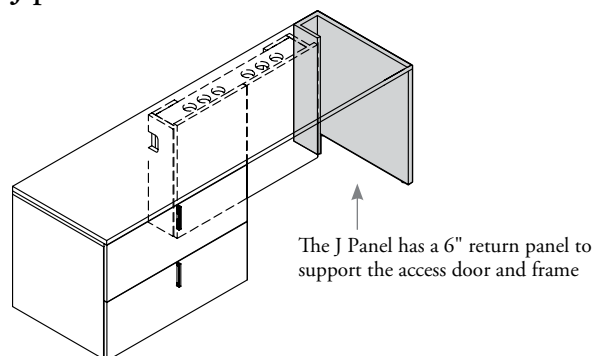

boardroom credenza basics

Dossier Boardroom Credenzas are complete credenza units that complement Dossier Boardroom Tables.

Boardroom Credenza, 1-1/2" Top, 36H with Doors and Drawers (ZJXD) shown

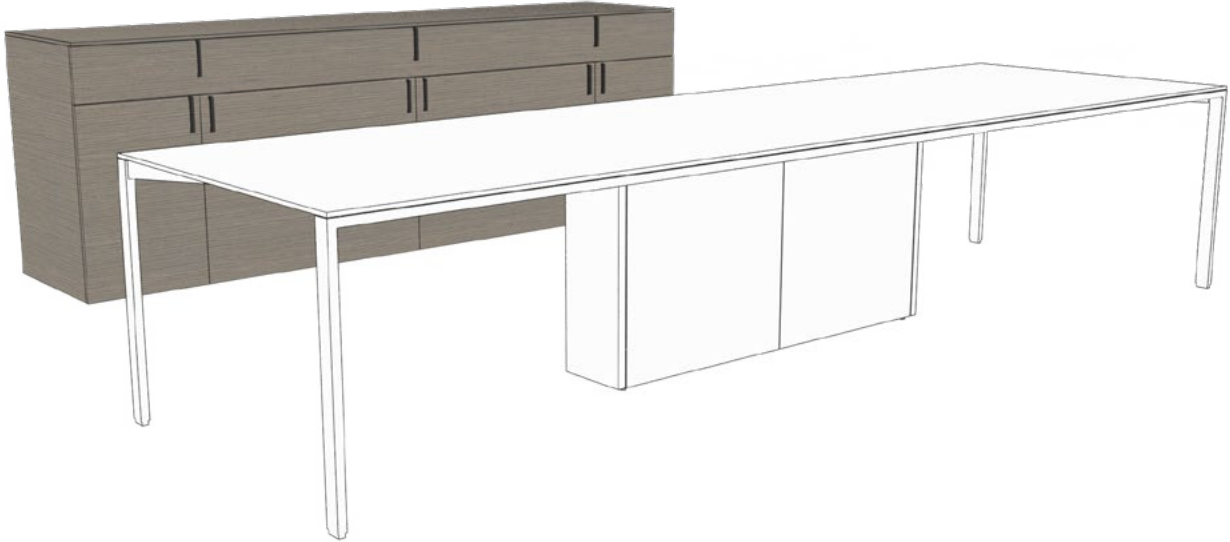

Dossier Boardroom Credenzas consist of a combination of doors and drawers and include the credenza top.

Heights: 29" and 36"

Depths: 20" and 24"

Widths: 60", 72", 90", and 108"

The credenza top is available in two thicknesses:
 • 1/2" thick, available in Flintwood, Veneer, Solid Surface and Backpainted Glass
 • 1-1/2" thick, available in Flintwood and Veneer

Grain Direction:
 • Horizontal
 • Vertical

Pull Style:
 • Dossier Pull
 • Rectangular Pull

Drawer box finishes:
 • Ebony
 • Maple

Lock Options:
 • With lock
 • Without lock

Case finish:
 • Flintwood
 • Veneer

Top finishes:
 • Flintwood, Veneer, Solid Surface and Backpainted Glass

Pull finishes:
 • Paint, Satin Nickel

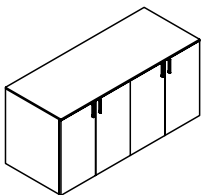

Boardroom Credenza, 1/2" Top, 29H with Doors (ZJXA)

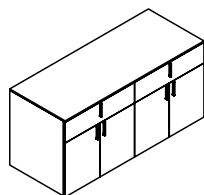

Boardroom Credenza, 1/2" Top, 29H with Doors and Drawers (ZJXB)

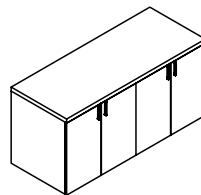

Boardroom Credenza, 1-1/2" Top, 29H with Doors (ZJXC)

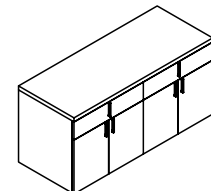

Boardroom Credenza, 1-1/2" Top, 29H with Doors and Drawers (ZJXD)

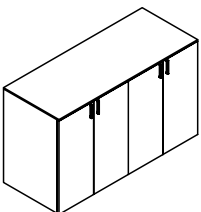

Boardroom Credenza, 1/2" Top, 36H with Doors (ZJYA)

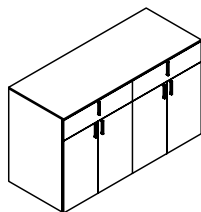

Boardroom Credenza, 1/2" Top, 36H with Doors and Drawers (ZJYB)

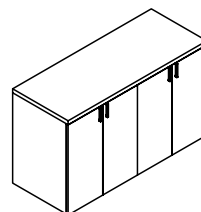

Boardroom Credenza, 1-1/2" Top, 36H with Doors (ZJYC)

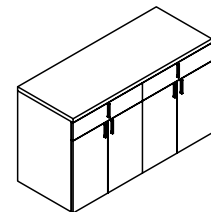

Boardroom Credenza, 1-1/2" Top, 36H with Doors and Drawers (ZJYD)

planning with boardroom credenzas

The following should be considered when planning with Boardroom Credenzas.

- Two top thicknesses are available on the credenza
 - 1/2"
 - 1 1/2"

The overall height is to the top of the credenza top, regardless of its thickness.

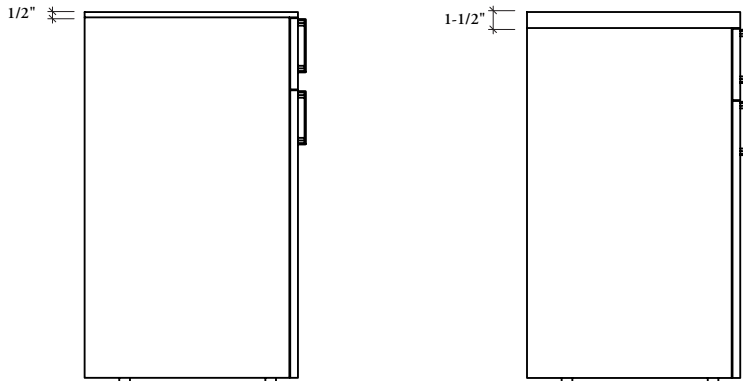

Boardroom Credenzas are available with two or three storage sections depending on the size specified.

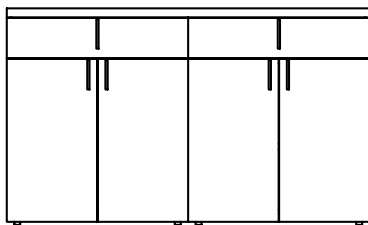

- The 60" and 72" wide credenzas have two storage sections:
- Each section will consist of two doors
 - If drawers are specified, each section will have one drawer

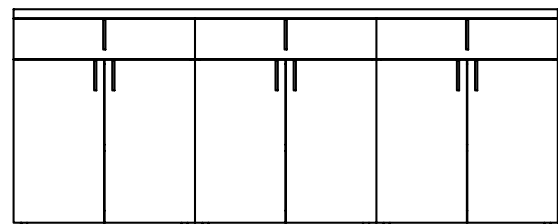

- The 90" and 108" wide credenzas have three storage sections:
- Each section will consist of two doors
 - If drawers are specified, each section will have one drawer