

UPSC

Parallel Spine Credenza for Height-Adjustable Table

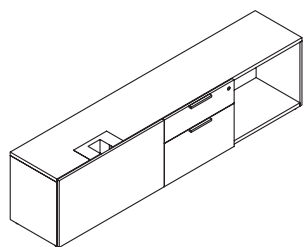

The Parallel Spine Credenza for Height-Adjustable Table is installed parallel to the panel to allow for perpendicular planning with the worksurface. This product can support the panel.

WHAT'S INCLUDED

1 case, box/file drawers with pulls (as specified), lock and keys (if specified), counterweight, leg grommet.

Open with Drawer (P) has an extra kit that contains two 1-1/4" levelers and two 1-3/4" levelers will be shipped with the storage.

WHAT'S EXCLUDED

A Seat Cushion (UWLC) or Fitted Seated Cushion (UWLF) can be ordered separately. Can be found in Accessories section.

NOTES

Full Drawer (F) includes extended levelers (UNSLB) already installed.

Hinged door is push latch, no handle required.

The following bases can be installed into this credenza:

Navigate Height-Adjustable Built-in Base - Perpendicular Planning (YGD)

Navigate Height-Adjustable Built-in Gable Base - Perpendicular Planning (YVD)

hiSpace HA Built-in Base - Perpendicular Planning (YSG)

hiSpace HA Built-in Base - Parallel Planning (YSP)

PRODUCT OPTIONS

Configuration	Depth	Width	Pull Style	Storage Compartment Location
F Full Drawer	16	72, 78, 84	D District	L Left
P Open with Drawer			R Rectangular	

SAMPLE ORDER CODE

UPSC F	16	72	D	L
---------------	-----------	-----------	----------	----------

PRODUCT OPTIONS (CONTINUED)

Pull Finish	Leg Grommet Finish	Case & Back, Front Finish	Key
Foundation	Foundation	Source Laminate	K Key Alike R Key Random N None
Mica	Mica	Seamless Color	
		Flintwood	
		Natural Veneer	

SAMPLE ORDER CODE (CONTINUED)

7	7	ZA	ZA	R
----------	----------	-----------	-----------	----------

See pricing in the following page.

Parallel Spine Credenza for
Height-Adjustable Table
(Continued)

DIMENSIONS
INCHES / MM

D	W
16 / 406	72 / 1829
16 / 406	78 / 1981
16 / 406	84 / 2134

16 / 406	72 / 1829
16 / 406	78 / 1981
16 / 406	84 / 2134

16 / 406	72 / 1829
16 / 406	78 / 1981
16 / 406	84 / 2134

16 / 406	72 / 1829
16 / 406	78 / 1981
16 / 406	84 / 2134

D	W
16 / 406	72 / 1829
16 / 406	78 / 1981
16 / 406	84 / 2134

16 / 406	72 / 1829
16 / 406	78 / 1981
16 / 406	84 / 2134

16 / 406	72 / 1829
16 / 406	78 / 1981
16 / 406	84 / 2134

16 / 406	72 / 1829
16 / 406	78 / 1981
16 / 406	84 / 2134

PRICING

FULL DRAWER (F)

SOURCE LAMINATE BACK & CASE

Source Lam. Front	Flintwood Front
2710	3524
2836	3686
2938	3820

SEAMLESS BACK & CASE

Seamless Front	Flintwood Front	Veneer Front
3903	4137	4176
4083	4328	4370
4230	4485	4527

FLINTWOOD BACK & CASE

Seamless Front	Flintwood Front
4598	4919
4811	5145
4983	5330

VENEER BACK & CASE

Seamless Front	Veneer Front
5112	5164
5349	5402
5540	5598

OPEN WITH DRAWER (P)

SOURCE LAMINATE BACK & CASE

Source Lam. Front	Flintwood Front
2192	2849
2296	2984
2374	3087

SEAMLESS BACK & CASE

Seamless Front	Flintwood Front	Veneer Front
3155	3343	3376
3306	3504	3536
3419	3625	3659

FLINTWOOD BACK & CASE

Seamless Front	Flintwood Front
3717	3976
3896	4164
4028	4307

VENEER BACK & CASE

Seamless Front	Veneer Front
4132	4175
4330	4374
4478	4524