

# height-adjustability

**Xpress**

## UPPC

### Perpendicular Credenza for Height-Adjustable Table

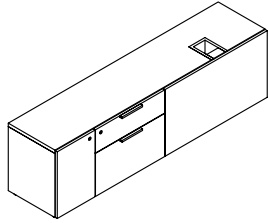

The Perpendicular Credenza for Height-Adjustable Table is installed perpendicular to the panel to allow for parallel planning within the worksurface.

#### WHAT'S INCLUDED

1 case, box/file drawers with pulls (as specified), lock and keys (if specified), counterweight, leg grommet

File with Hinged Door (H) has an extra kit that contains two 1-1/4" levelers and two 1-3/4" levelers will be shipped with the storage.

#### WHAT'S EXCLUDED

A Seat Cushion (UWLC) or Fitted Seated Cushion (UWLF) can be ordered separately and can be found in the *Accessories* section.

#### NOTES

Full Drawer (F) includes extended levelers (UNSLB) already installed.

Hinged door is push latch, no handle required.

48" and 54" Widths are not available if configuration (H) File with Hinged Door is specified.

The following bases can be installed into this credenza:

Navigate Height-Adjustable Built-in Base - Parallel Planning (YHD)

Navigate Height-Adjustable Built-in Gable Base - Parallel Planning (YWD)

hiSpace HA Built-in Base - Perpendicular Planning (YSG)

hiSpace HA Built-in Base - Parallel Planning (YSP)

**Xpress** Case, Back & Front Finish Flintwood and Natural Veneer are excluded from *Teknion's Xpress Program*.

#### PRODUCT OPTIONS

Configuration	Depth	Width	Pull Style	Storage Compartment Location
<b>F</b> Navigate Compatible with Full drawer	16	48, 54, 60, 66, 72	<b>D</b> District	<b>L</b> Left (shown)
<b>H</b> Navigate Compatible with File with Hinged Door			<b>R</b> Rectangular	<b>R</b> Right
<b>E</b> hiSpace Compatible with Full drawer				
<b>G</b> hiSpace Compatible with File with Hinged Door				

#### SAMPLE ORDER CODE

<b>UPPC F</b>	<b>16</b>	<b>60</b>	<b>D</b>	<b>L</b>
---------------	-----------	-----------	----------	----------

#### PRODUCT OPTIONS (CONTINUED)

Pull Finish	Leg Grommet Finish	Case, Back & Front Finish	Key	Slot For Storage Screen
Foundation	Foundation	Source Laminate	<b>K</b> Key Alike	<b>N</b> No
Mica	Mica	Flintwood	<b>R</b> Key Random	<b>Y</b> Yes
		Natural Veneer	<b>N</b> No Key	

#### SAMPLE ORDER CODE (CONTINUED)

		Case	Back	Front		
<b>7</b>	<b>7</b>	<b>ZA</b>	<b>ZA</b>	<b>ZA</b>	<b>R</b>	<b>N</b>

See pricing in the following page.

Xpress

UPPC

Perpendicular Credenza for  
Height-Adjustable Table  
(Continued)

DIMENSIONS  
INCHES / MM

D	W
16 / 406	48 / 1219
16 / 406	54 / 1372
16 / 406	60 / 1524
16 / 406	66 / 1676
16 / 406	72 / 1829

PRICING

FULL DRAWER (F/E)

SOURCE LAMINATE CASE		FLINTWOOD CASE	VENEER CASE
Source Lam. Back & Front	Source Lam. Back, Flintwood Front	Flintwood Back & Front	Veneer Back & Front
2068	2689	3751	3941
2185	2842	3970	4167
2491	3238	4521	4744
2608	3390	4732	4968
2709	3519	4911	5159

FILE WITH HINGED DOOR (H/G)

SOURCE LAMINATE CASE		FLINTWOOD CASE	VENEER CASE
Source Lam. Back & Front	Source Lam. Back, Flintwood Front	Flintwood Back & Front	Veneer Back & Front
2366	3074	4292	4504
2477	3221	4496	4721
2572	3343	4667	4900