

UPCS

Shared Perpendicular Credenza for Height-Adjustable Table

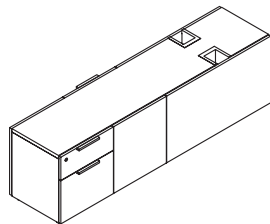

The Shared Perpendicular Credenza for Height-Adjustable Table is shared and installed perpendicular to the panel to allow for parallel planning within the worksurface.

Shared Perpendicular Credenza for Height-Adjustable Table provides file and personal storage with the capability to integrate height-adjustable tables and support stackers and panels.

WHAT'S INCLUDED

1 case, box/file drawers with pulls (as specified), lock and keys (if specified), counterweight, leg grommet

WHAT'S EXCLUDED

A Seat Cushion (UWLC) or Fitted Seated Cushion(UWLF) can be ordered separately. Can be found in Accessories section.

NOTES

This Product includes extended levelers (UNSL) already installed.

Hinged door is push latch, no handle required.

The following bases can be installed into this credenza:

Navigate Height-Adjustable Built-in Base - Parallel Planning (YHD)

Navigate Height-Adjustable Built-in Gable Base - Parallel Planning (YWD)

PRODUCT OPTIONS

Depth	Width	Pull Style	Storage Compartment Location
16	66, 72	D District R Rectangular	L Left R Right (shown)

SAMPLE ORDER CODE

UPCS 16	72	D	L
---------	----	---	---

PRODUCT OPTIONS (CONTINUED)

Pull Finish	Leg Grommet Finish	Case & Back, Front Finish	Key
Foundation	Foundation	Source Laminate	K Key Alike
Mica	Mica	Seamless Color	R Key Random
		Flintwood	N None
		Natural Veneer	

SAMPLE ORDER CODE (CONTINUED)

7	7	ZA	ZA	R
---	---	----	----	---

See pricing in the following page.

U P C S
Shared Perpendicular Credenza
for Height-Adjustable Table
(Continued)

DIMENSIONS
INCHES / MM

D	W
16 / 406	66 / 1676
16 / 406	72 / 1829

16 / 406	66 / 1676
16 / 406	72 / 1829

16 / 406	66 / 1676
16 / 406	72 / 1829

16 / 406	66 / 1676
16 / 406	72 / 1829

PRICING

SOURCE LAMINATE BACK & CASE

Source Lam. Front	Flintwood Front
2496	3245
2567	3337

SEAMLESS BACK & CASE

Seamless Front	Flintwood Front	Veneer Front
3594	3810	3845
3697	3918	3955

FLINTWOOD BACK & CASE

Seamless Front	Flintwood Front
4235	4529
4355	4658

VENEER BACK & CASE

Seamless Front	Veneer Front
4708	4756
4842	4891