

U O O Open Overhead

The Open Overhead is a 16" deep open cabinet that is mounted to a panel or wall to provide easily accessible open storage.

WHAT'S INCLUDED

1 cabinet with 1 to 2 height-adjustable shelves (depending on height and width), mounting bracket (as specified).

NOTES

The 21" high overhead is **not** available with 54" and 60" widths.

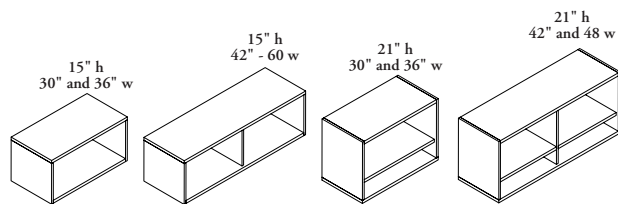

PRODUCT OPTIONS

Height	Width	Case & Back Finish	Mounting Brackets
15, 21	30, 36, 42, 48, 54, 60	Source Laminate Seamless Color Flintwood Natural Veneer	D District A Altos L Leverage W Drywall

SAMPLE ORDER CODE

		Case	Back	
UOO 15	42	ZA	ZA	D

DIMENSIONS INCHES / MM

H	W
15 / 381	30 / 762
15 / 381	36 / 914
15 / 381	42 / 1067
15 / 381	48 / 1219
15 / 381	54 / 1372
15 / 381	60 / 1524
21 / 533	30 / 762
21 / 533	36 / 914
21 / 533	42 / 1067
21 / 533	48 / 1219

15 / 381	30 / 762
15 / 381	36 / 914
15 / 381	42 / 1067
15 / 381	48 / 1219
15 / 381	54 / 1372
15 / 381	60 / 1524
21 / 533	30 / 762
21 / 533	36 / 914
21 / 533	42 / 1067
21 / 533	48 / 1219

PRICING

SOURCE LAMINATE CASE

Source Lam. Back
632
675
730
779
828
875
755
809
879
938

FLINTWOOD CASE

Seamless Back	Flintwood Back
1533	1699
1606	1784
1683	1876
1763	1973
1845	2067
1931	2159
1880	2165
1974	2278
2070	2397
2170	2522

SEAMLESS CASE

Seamless Back	Flintwood Back	Veneer Back
1317	1576	1600
1379	1651	1676
1446	1732	1759
1512	1815	1842
1581	1898	1925
1655	1984	2016
1613	1921	1967
1687	2014	2061
1773	2115	2162
1857	2218	2267

VENEER CASE

Seamless Back	Veneer Back
1568	1753
1643	1842
1722	1936
1806	2038
1872	2130
1961	2231
2036	2318
2141	2437
2253	2567
2369	2701

If Wall Rail System Mounting Brackets are specified, add 204