

U O O C

Open Centermount Overhead

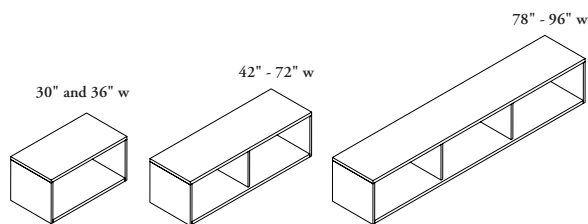

The Centermount Open Overhead is a 16" deep open cabinet that sits atop a panel to provide accessible open storage in a single- or double-sided application.

WHAT'S INCLUDED

- 42" - 72" h = 1 divider
- 78" - 96" h = 2 dividers

WHAT'S EXCLUDED

When Leverage Center Upmount (N) mounting brackets have been specified, the Centermount Overhead Storage Bracket (KUOHC) must be ordered separately. See the Leverage: *Mounted Storage & Accessories* section.

When District Center Upmount (U) mounting brackets have been specified, Centermount Cabinet Support Posts & Trim (UNOPT) or Centermount Cabinet Support Brackets & Top Trim (UNOBT) must be ordered separately. Can be found in the *Supports* section.

NOTES

The Open Compartment Locations (L & R) do **not** apply to the Single-Sided (S) stacker. (N) must be selected.

PRODUCT OPTIONS

Style	Height	Width	Open Location (Double-Sided)	Case & Back Finish	Mounting Brackets
S Single-Sided (Shown) D Double-Sided	09, 15	30, 36, 42, 48, 54, 60, 66, 72, 78, 84, 90, 96	L Left R Right N Not Applicable	Source Laminate Seamless Color Flintwood Natural Veneer	U District Center Upmount N Leverage Center Upmount

SAMPLE ORDER CODE

				Case	Back	
UOOC S	09	42	N	ZA	ZA	N

DIMENSIONS
INCHES / MM

H	W
9 / 229	30 / 762
9 / 229	36 / 914
9 / 229	42 / 1067
9 / 229	48 / 1219
9 / 229	54 / 1372
9 / 229	60 / 1524
9 / 229	66 / 1676
9 / 229	72 / 1829
9 / 229	78 / 1981
9 / 229	84 / 2134
9 / 229	90 / 2286
9 / 229	96 / 2438
15 / 381	30 / 762
15 / 381	36 / 914
15 / 381	42 / 1067
15 / 381	48 / 1219
15 / 381	54 / 1372
15 / 381	60 / 1524
15 / 381	66 / 1676
15 / 381	72 / 1829
15 / 381	78 / 1981
15 / 381	84 / 2134
15 / 381	90 / 2286
15 / 381	96 / 2438

PRICING

SINGLE-SIDED (S)

SOURCE LAMINATE CASE

Source Lam. Back
445
483
532
574
620
662
707
752
828
869
912
n/a
493
534
592
640
688
738
787
836
886
930
987
n/a

SEAMLESS CASE

Seamless Back	Flintwood Back	Veneer Back
1062	1271	1292
1115	1339	1360
1177	1410	1433
1235	1482	1507
1298	1556	1583
1361	1635	1661
1430	1715	1745
1500	1802	1831
1651	1981	2014
1734	2081	2116
1821	2187	2222
1911	2296	2332
1179	1435	1461
1239	1512	1536
1305	1592	1621
1374	1676	1702
1441	1759	1786
1513	1846	1876
1588	1937	1970
1668	2036	2070
1834	2238	2274
1926	2349	2389
2022	2468	2509
2123	2593	2635

Pricing is continued on the following page.

U O O C
Open Centermount Overhead
(Continued)

DIMENSIONS
INCHES / MM

PRICING

		SINGLE-SIDED (S)			
		FLINTWOOD CASE		VENEER CASE	
H	W	Seamless Back	Flintwood Back	Seamless Back	Veneer Back
9 / 229	30 / 762	1255	1403	1285	1452
9 / 229	36 / 914	1322	1482	1352	1533
9 / 229	42 / 1067	1389	1563	1424	1620
9 / 229	48 / 1219	1462	1649	1499	1708
9 / 229	54 / 1372	1535	1733	1561	1794
9 / 229	60 / 1524	1610	1821	1638	1883
9 / 229	66 / 1676	1693	1911	1722	1976
9 / 229	72 / 1829	1776	2006	1807	2075
9 / 229	78 / 1981	1955	2205	1986	2283
9 / 229	84 / 2134	2051	2317	2085	2399
9 / 229	90 / 2286	2155	2431	2192	2519
9 / 229	96 / 2438	2262	2553	2301	2646
15 / 381	30 / 762	1393	1559	1428	1615
15 / 381	36 / 914	1468	1645	1503	1702
15 / 381	42 / 1067	1545	1737	1582	1797
15 / 381	48 / 1219	1625	1833	1666	1898
15 / 381	54 / 1372	1706	1925	1733	1995
15 / 381	60 / 1524	1792	2021	1821	2092
15 / 381	66 / 1676	1879	2122	1911	2196
15 / 381	72 / 1829	1974	2229	2007	2307
15 / 381	78 / 1981	2174	2453	2209	2538
15 / 381	84 / 2134	2280	2574	2318	2665
15 / 381	90 / 2286	2394	2702	2435	2797
15 / 381	96 / 2438	2515	2837	2558	2939

		DOUBLE-SIDED (D)			
		SOURCE LAMINATE CASE		SEAMLESS CASE	
H	W	Source Lam. Back	Seamless Back	Flintwood Back	Veneer Back
9 / 229	30 / 762	499	1115	1374	1394
9 / 229	36 / 914	531	1177	1447	1471
9 / 229	42 / 1067	566	1235	1521	1547
9 / 229	48 / 1219	601	1302	1601	1627
9 / 229	54 / 1372	647	1393	1713	1743
9 / 229	60 / 1524	695	1491	1834	1867
9 / 229	66 / 1676	743	1596	1962	1996
9 / 229	72 / 1829	790	1707	2103	2137
9 / 229	78 / 1981	833	1825	2245	2281
9 / 229	84 / 2134	877	1954	2404	2443
9 / 229	90 / 2286	930	2090	2572	2613
9 / 229	96 / 2438	n/a	2237	2751	2795
15 / 381	30 / 762	554	1239	1525	1550
15 / 381	36 / 914	591	1305	1606	1633
15 / 381	42 / 1067	627	1374	1687	1719
15 / 381	48 / 1219	668	1447	1779	1808
15 / 381	54 / 1372	720	1549	1905	1935
15 / 381	60 / 1524	770	1658	2040	2072
15 / 381	66 / 1676	824	1773	2181	2217
15 / 381	72 / 1829	875	1897	2332	2371
15 / 381	78 / 1981	928	2030	2496	2536
15 / 381	84 / 2134	974	2170	2669	2713
15 / 381	90 / 2286	1035	2322	2857	2904
15 / 381	96 / 2438	n/a	2486	3057	3108

Pricing is continued on the following page.

U O O C

Open Centermount Overhead
(Continued)

DIMENSIONS
INCHES / MM

PRICING

		DOUBLE-SIDED (D)			
		FLINTWOOD CASE		VENEER CASE	
H	W	Seamless Back	Flintwood Back	Seamless Back	Veneer Back
9 / 229	30 / 762	1297	1487	1310	1541
9 / 229	36 / 914	1367	1573	1384	1626
9 / 229	42 / 1067	1445	1660	1461	1720
9 / 229	48 / 1219	1523	1752	1541	1813
9 / 229	54 / 1372	1631	1873	1648	1940
9 / 229	60 / 1524	1746	2006	1763	2074
9 / 229	66 / 1676	1869	2148	1885	2221
9 / 229	72 / 1829	2000	2298	2020	2375
9 / 229	78 / 1981	2140	2456	2160	2542
9 / 229	84 / 2134	2290	2628	2311	2720
9 / 229	90 / 2286	2449	2813	2474	2911
9 / 229	96 / 2438	2620	3010	2647	3114
15 / 381	30 / 762	1440	1656	1457	1712
15 / 381	36 / 914	1520	1746	1535	1807
15 / 381	42 / 1067	1603	1843	1623	1909
15 / 381	48 / 1219	1694	1946	1712	2014
15 / 381	54 / 1372	1813	2082	1832	2155
15 / 381	60 / 1524	1940	2229	1961	2306
15 / 381	66 / 1676	2074	2385	2096	2467
15 / 381	72 / 1829	2221	2552	2244	2641
15 / 381	78 / 1981	2375	2732	2402	2827
15 / 381	84 / 2134	2541	2920	2570	3022
15 / 381	90 / 2286	2719	3127	2750	3233
15 / 381	96 / 2438	2910	3343	2942	3460