

U O H Sliding Door Overhead

The Sliding Door Overhead is a 16" deep double sliding door overhead that mounts to a panel or wall to provide secured lockable storage.

WHAT'S INCLUDED

1 cabinet with 2 sliding doors, lock and keys (if specified), mounting bracket (as specified).

NOTES

The 21" high overhead is **not** available in 54" and 60" widths.

Standard Glass, Frost is an etched tempered glass.

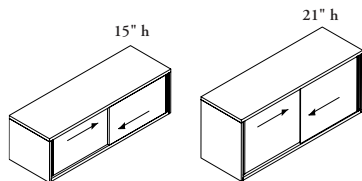

PRODUCT OPTIONS

Height	Width	Pull Finish	Case & Front Finish	Key Style	Mounting Bracket Configuration
15, 21	30, 36, 42, 48, 54, 60	Foundation Mica	Source Laminate Seamless Color Flintwood Natural Veneer FT Frost Standard Glass BP Backpainted Glass	K Keyed Alike R Keyed Randomly N No Lock	D District A Altos L Leverage W Drywall

SAMPLE ORDER CODE

UOH 15		42	Q	Case ZA	Front FT	K	D
--------	--	----	---	------------	-------------	---	---

DIMENSIONS INCHES / MM

H	W
15 / 381	30 / 762
15 / 381	36 / 914
15 / 381	42 / 1067
15 / 381	48 / 1219
15 / 381	54 / 1372
15 / 381	60 / 1524
21 / 533	30 / 762
21 / 533	36 / 914
21 / 533	42 / 1067
21 / 533	48 / 1219

PRICING

SOURCE LAMINATE CASE

Source Lam. Front	Glass Front	Flintwood Front
1039	1603	1603
1123	1661	1661
1209	1855	1855
1297	1912	1912
1379	1968	1968
1460	2021	2021
1269	1968	1968
1372	2046	2046
1479	2284	2284
1590	2363	2363

SEAMLESS CASE

Seamless Front	Flintwood Front	Veneer Front	Glass Front
1864	1879	1968	1968
1933	1948	2040	2040
2160	2181	2283	2283
2228	2249	2355	2355
2291	2314	2422	2422
2358	2379	2493	2493
2243	2253	2361	2361
2333	2346	2458	2458
2608	2621	2746	2746
2698	2711	2840	2840

If Wall Rail System Mounting Brackets are specified, add 184

Pricing is continued on the following page.

U O H
Sliding Door Overhead
(Continued)

DIMENSIONS
INCHES / MM

H	W
15 / 381	30 / 762
15 / 381	36 / 914
15 / 381	42 / 1067
15 / 381	48 / 1219
15 / 381	54 / 1372
15 / 381	60 / 1524
21 / 533	30 / 762
21 / 533	36 / 914
21 / 533	42 / 1067
21 / 533	48 / 1219

PRICING

FLINTWOOD CASE

Seamless Front	Glass Front	Flintwood Front
2136	2316	2211
2234	2422	2314
2483	2693	2571
2583	2802	2674
2680	2908	2776
2782	3018	2881
2511	2724	2601
2632	2856	2725
2926	3173	3029
3044	3304	3152

VENEER CASE

	Seamless Front	Glass Front	Veneer Front
15 / 381	2211	2395	2286
15 / 381	2316	2509	2395
15 / 381	2572	2787	2661
15 / 381	2677	2902	2769
15 / 381	2778	3012	2874
15 / 381	2883	3127	2984
21 / 533	2602	2819	2691
21 / 533	2727	2959	2821
21 / 533	3031	3285	3137
21 / 533	3030	3284	3134

If Wall Rail System (R) Mounting Brackets are specified, add 184