

ULSE

Low Double Sliding Door Credenza – Elevated

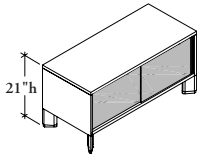

The Elevated Low Double Sliding Door Credenza provides secured, lockable binder storage, and the capability to support stackers and panels.

WHAT'S INCLUDED

1 credenza, 2 District feet or 4 angled feet (as specified), 2 sliding doors with pulls, lock and keys (if specified).

WHAT'S EXCLUDED

A Seat Cushion (UWLC) or Fitted Seated Cushion (UWLF) can be ordered separately. Can be found in the *Accessories* section.

NOTES

Double Sliding Door Credenzas will always have two sections secured with two sliding doors regardless of the width of the unit.

The 16" deep **cannot** be specified with a District Foot (D).

The Reconfigurable Low Credenza-to-Worksurface Support (UWCPWN) **cannot** be used with this unit as it will interfere with the sliding door.

It is **not** recommended that Double Sliding Door Credenzas be used to support worksurfaces in a perpendicular application as handle pulls will be difficult to reach under the worksurface.

Cubby Power Mounting (EWQPM) cannot be mounted in sliding door credenzas.

PRODUCT OPTIONS

Depth	Width	Pull Finish	Case, Back & Front Finish	Foot Finish	Foot Style	Electrical Cut Out (Angled Foot Only)	Key Style
16, 19	42, 48, 54, 60, 66, 72, 78, 84, 90, 96	Foundation Mica	Source Laminate Seamless Color Flintwood Natural Veneer FT Frost Standard Glass BP Backpainted Glass	Q Storm White 7 Platinum V Very White X Anthracite M Graphite 2 Burnished Bronze	D District A Angled Foot	TR Base and Top Grommet Right TL Base and Top Grommet Left NN None	K Keyed Alike R Keyed Randomly N No Lock

SAMPLE ORDER CODE

		Case Back Front								
ULSE 16	90	7	ZA	ZA	ZA	7	A	NN	R	

DIMENSIONS INCHES / MM

D	W
16 / 406	42 / 1067
16 / 406	48 / 1219
16 / 406	54 / 1372
16 / 406	60 / 1524
16 / 406	66 / 1676
16 / 406	72 / 1829
16 / 406	78 / 1981
16 / 406	84 / 2134
16 / 406	90 / 2286
16 / 406	96 / 2438
19 / 483	42 / 1067
19 / 483	48 / 1219
19 / 483	54 / 1372
19 / 483	60 / 1524
19 / 483	66 / 1676
19 / 483	72 / 1829
19 / 483	78 / 1981
19 / 483	84 / 2134
19 / 483	90 / 2286
19 / 483	96 / 2438

PRICING

SOURCE LAMINATE CASE

Source Lam. Back & Front	Source Lam. Back, Flintwood Front	Source Lam. Back, Glass Front
1372	2088	1583
1469	2154	1662
1559	2216	1747
1649	2274	1825
1747	2340	1918
1843	2404	2032
1935	2470	2148
2025	2539	2261
2118	2610	2366
n/a	n/a	n/a
1440	2193	1662
1544	2261	1746
1637	2324	1834
1732	2389	1918
1834	2455	2012
1935	2523	2133
2033	2594	2256
2125	2666	2373
2224	2742	2485
n/a	n/a	n/a

If Base & Top Grommet is specified, add 208

Pricing is continued on the following page.

ULSE

Low Double Sliding Door Credenza –
Elevated (Continued)

DIMENSIONS
INCHES / MM

PRICING

D	W
16 / 406	42 / 1067
16 / 406	48 / 1219
16 / 406	54 / 1372
16 / 406	60 / 1524
16 / 406	66 / 1676
16 / 406	72 / 1829
16 / 406	78 / 1981
16 / 406	84 / 2134
16 / 406	90 / 2286
16 / 406	96 / 2438
19 / 483	42 / 1067
19 / 483	48 / 1219
19 / 483	54 / 1372
19 / 483	60 / 1524
19 / 483	66 / 1676
19 / 483	72 / 1829
19 / 483	78 / 1981
19 / 483	84 / 2134
19 / 483	90 / 2286
19 / 483	96 / 2438

SEAMLESS CASE

Seamless Back & Front	Seamless Back, Flintwood Front	Seamless Back, Veneer Front	Seamless Back, Glass Front	Flintwood Back, Seamless Front	Flintwood Back & Front	Flintwood Back, Glass Front
2181	2428	2452	2563	2428	2684	2810
2251	2503	2528	2646	2503	2770	2899
2310	2574	2598	2719	2574	2847	2982
2375	2647	2671	2796	2647	2929	3066
2443	2722	2746	2876	2722	3011	3154
2510	2797	2827	2957	2797	3095	3242
2579	2876	2904	3040	2876	3183	3333
2652	2958	2985	3127	2958	3274	3429
2728	3042	3071	3217	3042	3369	3529
2804	3129	3157	3306	3129	3464	3628
2291	2550	2573	2694	2550	2818	2949
2361	2629	2655	2777	2629	2907	3044
2427	2702	2728	2856	2702	2988	3130
2495	2779	2807	2937	2779	3076	3220
2563	2858	2885	3020	2858	3160	3309
2636	2939	2967	3107	2939	3254	3406
2708	3020	3048	3191	3020	3341	3501
2785	3108	3133	3280	3108	3436	3602
2864	3193	3225	3376	3193	3536	3705
2944	3284	3313	3473	3284	3636	3810

SEAMLESS CASE

Veneer Back, Seamless Front	Veneer Back & Front	Veneer Back, Glass Front
2452	3002	3144
2528	3094	3238
2598	3184	3334
2671	3275	3430
2746	3369	3529
2827	3464	3628
2904	3562	3731
2985	3663	3837
3071	3771	3949
3157	3877	4062
2573	3152	3301
2655	3253	3405
2728	3342	3502
2807	3437	3603
2885	3536	3705
2967	3636	3810
3048	3738	3917
3133	3849	4030
3225	3957	4149
3313	4071	4267

If Base & Top Grommet is specified, add 208

Pricing is continued on the following page.

ULSE

Low Double Sliding Door Credenza – Elevated (Continued)

DIMENSIONS
INCHES / MM

PRICING

DIMENSIONS		FLINTWOOD CASE					
D	W	Seamless Back & Front	Seamless Back, Glass Front	Seamless Back, Flintwood Front	Flintwood Back, Seamless Front	Flintwood Back, Glass Front	Flintwood Back & Front
16 / 406	42 / 1067	2641	2918	2788	2788	3021	2885
16 / 406	48 / 1219	2744	3035	2897	2897	3142	3001
16 / 406	54 / 1372	2847	3150	3007	3007	3260	3112
16 / 406	60 / 1524	2955	3267	3119	3119	3383	3230
16 / 406	66 / 1676	3066	3391	3236	3236	3511	3352
16 / 406	72 / 1829	3183	3523	3360	3360	3648	3481
16 / 406	78 / 1981	3303	3654	3489	3489	3784	3613
16 / 406	84 / 2134	3428	3795	3622	3622	3930	3752
16 / 406	90 / 2286	3559	3942	3761	3761	4082	3896
16 / 406	96 / 2438	3695	4090	3905	3905	4237	4046
19 / 483	42 / 1067	2772	3064	2928	2928	3175	3030
19 / 483	48 / 1219	2882	3185	3042	3042	3300	3151
19 / 483	54 / 1372	2988	3305	3156	3156	3424	3267
19 / 483	60 / 1524	3103	3430	3276	3276	3553	3391
19 / 483	66 / 1676	3220	3562	3401	3401	3686	3521
19 / 483	72 / 1829	3341	3698	3530	3530	3829	3654
19 / 483	78 / 1981	3468	3836	3663	3663	3976	3795
19 / 483	84 / 2134	3600	3983	3803	3803	4127	3939
19 / 483	90 / 2286	3736	4137	3949	3949	4286	4089
19 / 483	96 / 2438	3879	4298	4099	4099	4449	4245
DIMENSIONS		VENEER CASE					
D	W	Seamless Back & Front	Seamless Back, Glass Front	Seamless Back, Veneer Front	Veneer Back, Seamless Front	Veneer Back, Glass Front	Veneer Back & Front
16 / 406	42 / 1067	2733	3022	2886	2886	3127	2985
16 / 406	48 / 1219	2839	3145	3003	3003	3255	3107
16 / 406	54 / 1372	2946	3262	3114	3114	3376	3224
16 / 406	60 / 1524	3058	3385	3232	3232	3503	3343
16 / 406	66 / 1676	3175	3514	3354	3354	3636	3472
16 / 406	72 / 1829	3295	3650	3485	3485	3775	3604
16 / 406	78 / 1981	3419	3788	3616	3616	3921	3742
16 / 406	84 / 2134	3551	3935	3755	3755	4071	3884
16 / 406	90 / 2286	3685	4085	3899	3899	4227	4032
16 / 406	96 / 2438	3827	4240	4049	4049	4388	4189
19 / 483	42 / 1067	2869	3178	3031	3031	3280	3133
19 / 483	48 / 1219	2983	3302	3153	3153	3416	3261
19 / 483	54 / 1372	3094	3425	3269	3269	3542	3383
19 / 483	60 / 1524	3214	3557	3393	3393	3679	3511
19 / 483	66 / 1676	3332	3689	3525	3525	3819	3647
19 / 483	72 / 1829	3458	3832	3657	3657	3963	3781
19 / 483	78 / 1981	3589	3978	3798	3798	4116	3927
19 / 483	84 / 2134	3729	4130	3945	3945	4273	4080
19 / 483	90 / 2286	3871	4293	4095	4095	4440	4234
19 / 483	96 / 2438	4017	4452	4250	4250	4608	4397

If Base & Top Grommet is specified, add 208