

ULDS

Low Full Drawer Credenza – Standard

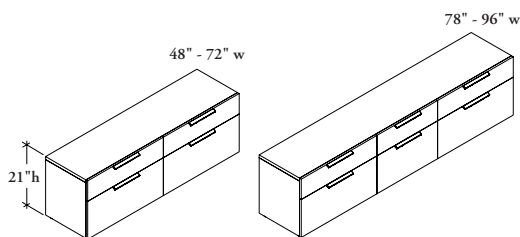

The Standard Low Full Drawer Credenza provides file storage with the capability to support worksurfaces, stackers and panels.

WHAT'S INCLUDED

1 credenza, box/file drawers with pulls (as specified), lock and keys (if specified), counterweight (if specified).

WHAT'S EXCLUDED

A Seat Cushion (UWLC) or Fitted Seated Cushion (UWLF) can be ordered separately. Can be found in the *Accessories* section.

NOTES

This product includes extended levelers (UNSL) already installed.

PRODUCT OPTIONS

Depth	Width	Pull Style	Pull Finish	Case, Back & Front Finish	Key Style	Counterweight
16, 19	48, 60, 72, 78, 84, 90, 96	D District R Rectangular	Foundation Mica	Source Laminate Seamless Color Flintwood Natural Veneer	K Keyed Alike R Keyed Randomly N No Lock	1 Yes 2 No

SAMPLE ORDER CODE

ULDS	Depth	Width	Pull Style	Pull Finish	Case	Back	Front	Key Style	Counterweight
					Code	Code	Code		
ULDS 19	19	48	D	7	ZA	ZA	ZA	K	1

**DIMENSIONS
INCHES / MM**

D	W
16 / 406	48 / 1219
16 / 406	60 / 1524
16 / 406	72 / 1829
16 / 406	78 / 1981
16 / 406	84 / 2134
16 / 406	90 / 2286
16 / 406	96 / 2438
19 / 483	48 / 1219
19 / 483	60 / 1524
19 / 483	72 / 1829
19 / 483	78 / 1981
19 / 483	84 / 2134
19 / 483	90 / 2286
19 / 483	96 / 2438

PRICING

SOURCE LAMINATE CASE

Source Lam. Back & Front	Source Lam. Back, Flintwood Front
2183	3000
2295	3150
2464	3379
2870	3929
3013	4121
3239	4426
n/a	n/a
2298	3154
2414	3313
2593	3554
3018	4129
3173	4335
3410	4655
n/a	n/a

If Counterweight is specified, add 150 for widths of 48" - 72"

If Counterweight is specified, add 301 for widths of 78" - 96"

Pricing is continued on the following page.

U L D S
Low Full Drawer Credenza –
Standard (Continued)

DIMENSIONS
INCHES / MM

D	W
16 / 406	48 / 1219
16 / 406	60 / 1524
16 / 406	72 / 1829
16 / 406	78 / 1981
16 / 406	84 / 2134
16 / 406	90 / 2286
16 / 406	96 / 2438
19 / 483	48 / 1219
19 / 483	60 / 1524
19 / 483	72 / 1829
19 / 483	78 / 1981
19 / 483	84 / 2134
19 / 483	90 / 2286
19 / 483	96 / 2438

PRICING

SEAMLESS CASE

Seamless Back & Front	Seamless Back, Flintwood Front	Seamless Back, Veneer Front	Flintwood Back, Seamless Front	Flintwood Back & Front	Veneer Back, Seamless Front	Veneer Back & Front
3088	3332	3384	3332	3569	3384	3675
3188	3437	3494	3437	3684	3494	3792
3764	4122	4184	4122	4475	4184	4593
4123	4551	4616	4551	4971	4616	5098
4665	5193	5266	5193	5714	5266	5854
4844	5406	5481	5406	5959	5481	6106
5001	5579	5654	5579	6149	5654	6298
3259	3515	3570	3515	3765	3570	3875
3364	3627	3685	3627	3886	3685	4001
3969	4347	4412	4347	4718	4412	4844
4348	4799	4868	4799	5239	4868	5373
4917	5474	5549	5474	6021	5549	6170
5108	5700	5777	5700	6281	5777	6434
5270	5880	5960	5880	6481	5960	6639

FLINTWOOD CASE

Seamless Back & Front	Seamless Back, Flintwood Front	Flintwood Back, Seamless Front	Flintwood Back & Front
3575	3767	3767	3870
3689	3887	3887	3993
4444	4740	4740	4917
4910	5266	5266	5489
5612	6051	6051	6348
5843	6315	6315	6633
6027	6517	6517	6843
3771	3972	3972	4081
3893	4101	4101	4212
4685	4998	4998	5185
5178	5549	5549	5786
5914	6379	6379	6689
6158	6655	6655	6989
6353	6869	6869	7210

VENEER CASE

Seamless Back & Front	Seamless Back, Veneer Front	Veneer Back, Seamless Front	Veneer Back & Front
3687	3930	3930	4074
3806	4053	4053	4204
4569	4916	4916	5147
5040	5452	5452	5730
5743	6254	6254	6605
5980	6521	6521	6897
6169	6727	6727	7115
3889	4143	4143	4296
4014	4275	4275	4433
4816	5184	5184	5426
5312	5747	5747	6041
6054	6591	6591	6960
6302	6872	6872	7267
6501	7090	7090	7496

If Counterweight is specified, add 150 for widths of 48" - 72"

If Counterweight is specified, add 301 for widths of 78" - 96"