

U H H S

High Open with Drawer Credenza – Standard

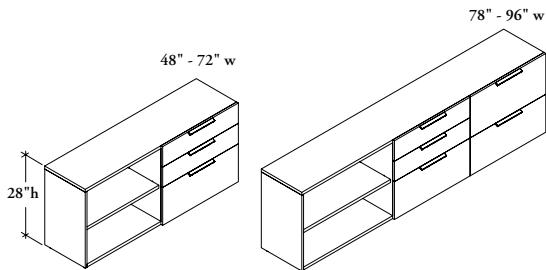

The Standard High Open Drawer Credenza provides both file storage and open binder storage with the capability to support worksurfaces, stackers and panels.

WHAT'S INCLUDED

1 credenza with 1 height-adjustable shelf, file/file or box/box/file drawers and pulls (as specified), lock and keys (if specified), counterweight (if specified).

WHAT'S EXCLUDED

A Seat Cushion (UWLC) or Fitted Seated Cushion (UWLF) can be ordered separately. Can be found in the *Accessories* section.

NOTES

If Box/Box/File (B) drawer combination is specified on widths 78" and greater, the box/box/file drawer will only appear in the middle section.

PRODUCT OPTIONS

Drawer Combination	Depth	Width	Open Compartment Location	Pull Style	Pull Finish	Case, Back & Front Finish	Key Style	Counterweight
B Box/Box/File (shown)	16, 19	48, 54, 60, 66, 72, 78, 84, 90, 96	L Left (shown) R Right	D District R Rectangular	Foundation Mica	Source Laminate Seamless Color Flintwood Natural Veneer	K Keyed Alike R Keyed Randomly N No Lock	1 Yes 2 No
F File/File								

SAMPLE ORDER CODE

							Case	Back	Front		
UHHS B	16	48	L	D	7	ZA	ZA	ZA	R	1	

**DIMENSIONS
INCHES / MM**

D	W
16 / 406	48 / 1219
16 / 406	54 / 1372
16 / 406	60 / 1524
16 / 406	66 / 1676
16 / 406	72 / 1829
16 / 406	78 / 1981
16 / 406	84 / 2134
16 / 406	90 / 2286
16 / 406	96 / 2438
19 / 483	48 / 1219
19 / 483	54 / 1372
19 / 483	60 / 1524
19 / 483	66 / 1676
19 / 483	72 / 1829
19 / 483	78 / 1981
19 / 483	84 / 2134
19 / 483	90 / 2286
19 / 483	96 / 2438

PRICING

BOX/BOX/FILE (B)

SOURCE LAMINATE CASE

Source Lam. Back & Front	Source Lam. Back, Flintwood Front
2019	2553
2077	2645
2135	2737
2217	2848
2298	2962
2911	3767
3048	3951
3261	4251
n/a	n/a
2113	2683
2176	2779
2237	2875
2323	2995
2409	3111
3060	3964
3202	4156
3423	4470
n/a	n/a

If Counterweight is specified, add 150

Pricing is continued on the following page.

High Open with Drawer Credenza – Standard (Continued)

DIMENSIONS
INCHES / MM

PRICING

BOX/BOX/FILE (B)

SEAMLESS CASE

D	W	Seamless Back & Front	Seamless Back, Flintwood Front	Seamless Back, Veneer Front	Flintwood Back, Seamless Front	Flintwood Back & Front	Veneer Back, Seamless Front	Veneer Back & Front
16 / 406	48 / 1219	2837	3120	3178	3120	3403	3178	3517
16 / 406	54 / 1372	2939	3234	3294	3234	3528	3294	3645
16 / 406	60 / 1524	3041	3345	3404	3345	3648	3404	3771
16 / 406	66 / 1676	3166	3484	3547	3484	3800	3547	3927
16 / 406	72 / 1829	3289	3620	3685	3620	3948	3685	4080
16 / 406	78 / 1981	4185	4605	4687	4605	5022	4687	5190
16 / 406	84 / 2134	4391	4831	4916	4831	5269	4916	5445
16 / 406	90 / 2286	4722	5194	5290	5194	5669	5290	5856
16 / 406	96 / 2438	4833	5315	5411	5315	5798	5411	5990
19 / 483	48 / 1219	2980	3280	3337	3280	3578	3337	3696
19 / 483	54 / 1372	3087	3396	3458	3396	3705	3458	3830
19 / 483	60 / 1524	3195	3515	3579	3515	3835	3579	3964
19 / 483	66 / 1676	3326	3657	3723	3657	3990	3723	4123
19 / 483	72 / 1829	3457	3803	3872	3803	4148	3872	4286
19 / 483	78 / 1981	4401	4841	4932	4841	5283	4932	5458
19 / 483	84 / 2134	4617	5080	5171	5080	5542	5171	5725
19 / 483	90 / 2286	4968	5463	5562	5463	5960	5562	6158
19 / 483	96 / 2438	5083	5592	5693	5592	6098	5693	6304

FLINTWOOD CASE

D	W	Seamless Back & Front	Seamless Back, Flintwood Front	Flintwood Back, Seamless Front	Flintwood Back & Front
16 / 406	48 / 1219	3395	3504	3504	3611
16 / 406	54 / 1372	3529	3642	3642	3754
16 / 406	60 / 1524	3662	3780	3780	3898
16 / 406	66 / 1676	3843	3968	3968	4089
16 / 406	72 / 1829	4024	4152	4152	4282
16 / 406	78 / 1981	4940	5096	5096	5255
16 / 406	84 / 2134	5178	5341	5341	5509
16 / 406	90 / 2286	5598	5776	5776	5954
16 / 406	96 / 2438	5741	5923	5923	6108
19 / 483	48 / 1219	3569	3682	3682	3798
19 / 483	54 / 1372	3709	3830	3830	3945
19 / 483	60 / 1524	3850	3973	3973	4096
19 / 483	66 / 1676	4040	4169	4169	4298
19 / 483	72 / 1829	4231	4366	4366	4501
19 / 483	78 / 1981	5196	5363	5363	5527
19 / 483	84 / 2134	5447	5619	5619	5794
19 / 483	90 / 2286	5890	6079	6079	6266
19 / 483	96 / 2438	6040	6231	6231	6424

If Counterweight is specified, add 150

Pricing is continued on the following page.

U H H S

High Open with Drawer Credenza – Standard (Continued)

DIMENSIONS
INCHES / MM

D	W
16 / 406	48 / 1219
16 / 406	54 / 1372
16 / 406	60 / 1524
16 / 406	66 / 1676
16 / 406	72 / 1829
16 / 406	78 / 1981
16 / 406	84 / 2134
16 / 406	90 / 2286
16 / 406	96 / 2438
19 / 483	48 / 1219
19 / 483	54 / 1372
19 / 483	60 / 1524
19 / 483	66 / 1676
19 / 483	72 / 1829
19 / 483	78 / 1981
19 / 483	84 / 2134
19 / 483	90 / 2286
19 / 483	96 / 2438

D	W
16 / 406	48 / 1219
16 / 406	54 / 1372
16 / 406	60 / 1524
16 / 406	66 / 1676
16 / 406	72 / 1829
16 / 406	78 / 1981
16 / 406	84 / 2134
16 / 406	90 / 2286
16 / 406	96 / 2438
19 / 483	48 / 1219
19 / 483	54 / 1372
19 / 483	60 / 1524
19 / 483	66 / 1676
19 / 483	72 / 1829
19 / 483	78 / 1981
19 / 483	84 / 2134
19 / 483	90 / 2286
19 / 483	96 / 2438

PRICING

BOX/BOX/FILE (B)

VENEER CASE

Seamless Back & Front	Seamless Back, Veneer Front	Veneer Back, Seamless Front	Veneer Back & Front
3653	3813	3813	3972
3800	3966	3966	4129
3943	4114	4114	4286
4140	4318	4318	4499
4333	4522	4522	4711
5318	5548	5548	5779
5576	5817	5817	6059
6026	6290	6290	6550
6180	6449	6449	6717
3841	4010	4010	4177
3993	4166	4166	4339
4145	4326	4326	4506
4349	4539	4539	4727
4554	4752	4752	4950
5594	5838	5838	6081
5864	6118	6118	6372
6341	6617	6617	6892
6502	6783	6783	7065

FILE/FILE (F)

SOURCE LAMINATE CASE

Source Lam. Back & Front	Source Lam. Back, Flintwood Front
1812	2393
1871	2485
1930	2578
2009	2690
2091	2801
2776	3660
2911	3844
3123	4145
n/a	n/a
1906	2520
1970	2619
2031	2713
2116	2834
2202	2948
2926	3855
3066	4049
3287	4365
n/a	n/a

If Counterweight is specified, add 150

Pricing is continued on the following page.

614

High Open with Drawer Credenza – Standard (Continued)

DIMENSIONS
INCHES / MM

PRICING

FILE/FILE (F)

SEAMLESS CASE

D	W	Seamless Back & Front	Seamless Back, Flintwood Front	Seamless Back, Veneer Front	Flintwood Back, Seamless Front	Flintwood Back & Front	Veneer Back, Seamless Front	Veneer Back & Front
16 / 406	48 / 1219	2658	2926	2976	2926	3188	2976	3296
16 / 406	54 / 1372	2762	3036	3090	3036	3314	3090	3423
16 / 406	60 / 1524	2864	3150	3207	3150	3435	3207	3550
16 / 406	66 / 1676	2988	3287	3346	3287	3586	3346	3705
16 / 406	72 / 1829	3111	3422	3485	3422	3735	3485	3858
16 / 406	78 / 1981	4068	4474	4555	4474	4879	4555	5044
16 / 406	84 / 2134	4273	4701	4784	4701	5126	4784	5298
16 / 406	90 / 2286	4606	5066	5157	5066	5525	5157	5710
16 / 406	96 / 2438	4714	5185	5278	5185	5656	5278	5845
19 / 483	48 / 1219	2802	3082	3139	3082	3362	3139	3474
19 / 483	54 / 1372	2909	3201	3259	3201	3491	3259	3608
19 / 483	60 / 1524	3015	3318	3378	3318	3619	3378	3740
19 / 483	66 / 1676	3147	3463	3524	3463	3776	3524	3903
19 / 483	72 / 1829	3279	3607	3672	3607	3934	3672	4066
19 / 483	78 / 1981	4284	4713	4799	4713	5142	4799	5313
19 / 483	84 / 2134	4500	4949	5041	4949	5399	5041	5580
19 / 483	90 / 2286	4848	5334	5431	5334	5819	5431	6014
19 / 483	96 / 2438	4966	5461	5559	5461	5955	5559	6156

FLINTWOOD CASE

D	W	Seamless Back & Front	Seamless Back, Flintwood Front	Flintwood Back, Seamless Front	Flintwood Back & Front
16 / 406	48 / 1219	3227	3331	3331	3433
16 / 406	54 / 1372	3362	3468	3468	3576
16 / 406	60 / 1524	3496	3608	3608	3719
16 / 406	66 / 1676	3678	3796	3796	3911
16 / 406	72 / 1829	3858	3981	3981	4105
16 / 406	78 / 1981	4831	4983	4983	5139
16 / 406	84 / 2134	5068	5229	5229	5391
16 / 406	90 / 2286	5487	5661	5661	5838
16 / 406	96 / 2438	5627	5809	5809	5987
19 / 483	48 / 1219	3400	3508	3508	3618
19 / 483	54 / 1372	3543	3655	3655	3768
19 / 483	60 / 1524	3681	3800	3800	3916
19 / 483	66 / 1676	3873	3997	3997	4120
19 / 483	72 / 1829	4062	4192	4192	4322
19 / 483	78 / 1981	5086	5249	5249	5410
19 / 483	84 / 2134	5335	5507	5507	5677
19 / 483	90 / 2286	5779	5964	5964	6149
19 / 483	96 / 2438	5928	6117	6117	6306

If Counterweight is specified, add 150

Pricing is continued on the following page.

U H H S

High Open with Drawer Credenza – Standard (Continued)

DIMENSIONS
INCHES / MM

PRICING

FILE/FILE (F)

VENEER CASE

D	W	Seamless Back & Front	Seamless Back, Veneer Front	Veneer Back, Seamless Front	Veneer Back & Front
16 / 406	48 / 1219	3474	3624	3624	3776
16 / 406	54 / 1372	3619	3775	3775	3934
16 / 406	60 / 1524	3765	3929	3929	4090
16 / 406	66 / 1676	3958	4130	4130	4302
16 / 406	72 / 1829	4154	4334	4334	4515
16 / 406	78 / 1981	5199	5426	5426	5651
16 / 406	84 / 2134	5454	5692	5692	5929
16 / 406	90 / 2286	5908	6164	6164	6422
16 / 406	96 / 2438	6059	6325	6325	6586
19 / 483	48 / 1219	3661	3819	3819	3979
19 / 483	54 / 1372	3813	3979	3979	4145
19 / 483	60 / 1524	3966	4138	4138	4309
19 / 483	66 / 1676	4170	4351	4351	4532
19 / 483	72 / 1829	4372	4563	4563	4753
19 / 483	78 / 1981	5477	5714	5714	5951
19 / 483	84 / 2134	5743	5993	5993	6242
19 / 483	90 / 2286	6222	6492	6492	6764
19 / 483	96 / 2438	6382	6659	6659	6938

If Counterweight is specified, add 150