

UCC Closed Stacker

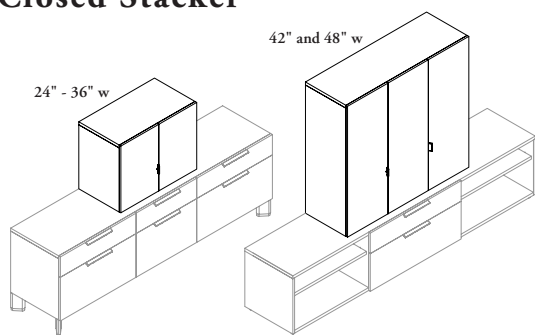

The Closed Stacker is a 16" deep closed cabinet that sits atop credenzas, towers and laterals to provide adjustable shelving and secured storage.

WHAT'S INCLUDED

1 cabinet, single-hinged door(s) or a combination of single-hinged door and bi-folding doors (depending on width), height-adjustable shelves (depending on height), lock and keys (if specified).

NOTES

For widths 24", 30" and 36", handedness will indicate which door will have the door handle and lock, for widths 42" and 48" handedness will indicate the location on the cabinet of the single hinged door (not the bi-fold).

Shelves are height-adjustable.

Height denotes height of the cabinet only and must be added to the height of the base unit (21" and 28" high credenzas or stretch pedestals or 36", 42" or 51" towers or lateral files) to get total height.

It is **not** recommended to stack units so that total height exceeds 66".

Stackers **cannot** be stacked on top of each other.

PRODUCT OPTIONS

| Height | Width | Handedness | Pull Style | Pull Finish | Case, Back & Front Finish | Key Style |
|----------------|--------------------|-------------------|-----------------------------|--------------------|------------------------------------------------------------------|------------------------------------------------|
| 23, 30, 38, 45 | 24, 30, 36, 42, 48 | L Left R Right | D District R Rectangular | Foundation Mica | Source Laminate Seamless Color Flintwood Natural Veneer | K Keyed Alike R Keyed Randomly N No Lock |

SAMPLE ORDER CODE

| | | | | | Case | Back | Front | | |
|--------|----|---|---|---|------|------|-------|---|--|
| UCC 23 | 42 | L | D | 7 | ZA | ZA | ZA | R | |

DIMENSIONS INCHES / MM

| H | W |
|-----------|-----------|
| 23 / 584 | 24 / 610 |
| 23 / 584 | 30 / 762 |
| 23 / 584 | 36 / 914 |
| 23 / 584 | 42 / 1067 |
| 23 / 584 | 48 / 1219 |
| 30 / 762 | 24 / 610 |
| 30 / 762 | 30 / 762 |
| 30 / 762 | 36 / 914 |
| 30 / 762 | 42 / 1067 |
| 30 / 762 | 48 / 1219 |
| 38 / 965 | 24 / 610 |
| 38 / 965 | 30 / 762 |
| 38 / 965 | 36 / 914 |
| 38 / 965 | 42 / 1067 |
| 38 / 965 | 48 / 1219 |
| 45 / 1143 | 24 / 610 |
| 45 / 1143 | 30 / 762 |
| 45 / 1143 | 36 / 914 |
| 45 / 1143 | 42 / 1067 |
| 45 / 1143 | 48 / 1219 |

PRICING

SOURCE LAMINATE CASE

| Source Lam. Back & Front | Source Lam. Back, Flintwood Front |
|--------------------------|-----------------------------------|
| 1035 | 1656 |
| 1095 | 1750 |
| 1257 | 2010 |
| 1604 | 2566 |
| 1765 | 2822 |
| 1121 | 1796 |
| 1181 | 1891 |
| 1344 | 2149 |
| 1690 | 2705 |
| 1850 | 2962 |
| 1208 | 1933 |
| 1267 | 2029 |
| 1430 | 2287 |
| 1777 | 2842 |
| 1937 | 3101 |
| 1296 | 2073 |
| 1364 | 2183 |
| 1521 | 2434 |
| 1912 | 3063 |
| 2071 | 3315 |

Pricing is continued on the following page.

UCC
Closed Stacker
(Continued)

DIMENSIONS
INCHES / MM

PRICING

| H | W |
|-----------|-----------|
| 23 / 584 | 24 / 610 |
| 23 / 584 | 30 / 762 |
| 23 / 584 | 36 / 914 |
| 23 / 584 | 42 / 1067 |
| 23 / 584 | 48 / 1219 |
| 30 / 762 | 24 / 610 |
| 30 / 762 | 30 / 762 |
| 30 / 762 | 36 / 914 |
| 30 / 762 | 42 / 1067 |
| 30 / 762 | 48 / 1219 |
| 38 / 965 | 24 / 610 |
| 38 / 965 | 30 / 762 |
| 38 / 965 | 36 / 914 |
| 38 / 965 | 42 / 1067 |
| 38 / 965 | 48 / 1219 |
| 45 / 1143 | 24 / 610 |
| 45 / 1143 | 30 / 762 |
| 45 / 1143 | 36 / 914 |
| 45 / 1143 | 42 / 1067 |
| 45 / 1143 | 48 / 1219 |

SEAMLESS CASE

| Seamless Back & Front | Seamless Back, Flintwood Front | Seamless Back, Veneer Front | Flintwood Back, Seamless Front | Flintwood Back & Front | Veneer Back, Seamless Front | Veneer Back & Front |
|-----------------------|--------------------------------|-----------------------------|--------------------------------|------------------------|-----------------------------|---------------------|
| 1725 | 2070 | 2087 | 2070 | 2295 | 2087 | 2415 |
| 1823 | 2187 | 2207 | 2187 | 2425 | 2207 | 2552 |
| 2096 | 2514 | 2535 | 2514 | 2786 | 2535 | 2934 |
| 2673 | 3208 | 3234 | 3208 | 3554 | 3234 | 3742 |
| 2940 | 3529 | 3557 | 3529 | 3911 | 3557 | 4118 |
| 1869 | 2243 | 2261 | 2243 | 2486 | 2261 | 2617 |
| 1968 | 2361 | 2381 | 2361 | 2616 | 2381 | 2754 |
| 2240 | 2686 | 2709 | 2686 | 2977 | 2709 | 3137 |
| 2816 | 3380 | 3409 | 3380 | 3746 | 3409 | 3943 |
| 3085 | 3702 | 3734 | 3702 | 4104 | 3734 | 4319 |
| 2013 | 2415 | 2435 | 2415 | 2678 | 2435 | 2819 |
| 2111 | 2533 | 2554 | 2533 | 2807 | 2554 | 2956 |
| 2383 | 2861 | 2882 | 2861 | 3171 | 2882 | 3336 |
| 2962 | 3553 | 3583 | 3553 | 3938 | 3583 | 4145 |
| 3228 | 3874 | 3907 | 3874 | 4294 | 3907 | 4521 |
| 2160 | 2592 | 2614 | 2592 | 2873 | 2614 | 3024 |
| 2275 | 2730 | 2751 | 2730 | 3024 | 2751 | 3184 |
| 2536 | 3044 | 3069 | 3044 | 3373 | 3069 | 3551 |
| 3188 | 3829 | 3858 | 3829 | 4241 | 3858 | 4465 |
| 3452 | 4143 | 4178 | 4143 | 4590 | 4178 | 4834 |

FLINTWOOD CASE

| Seamless Back & Front | Seamless Back, Flintwood Front | Flintwood Back, Seamless Front | Flintwood Back & Front |
|-----------------------|--------------------------------|--------------------------------|------------------------|
| 2064 | 2285 | 2261 | 2485 |
| 2179 | 2414 | 2389 | 2625 |
| 2375 | 2632 | 2604 | 2862 |
| 3069 | 3401 | 3364 | 3699 |
| 3417 | 3785 | 3745 | 4116 |
| 2218 | 2459 | 2432 | 2673 |
| 2334 | 2587 | 2560 | 2813 |
| 2530 | 2804 | 2774 | 3048 |
| 3173 | 3517 | 3479 | 3823 |
| 3521 | 3902 | 3861 | 4241 |
| 2530 | 2804 | 2774 | 3048 |
| 2647 | 2934 | 2902 | 3188 |
| 2841 | 3150 | 3115 | 3425 |
| 3537 | 3920 | 3877 | 4262 |
| 3883 | 4304 | 4258 | 4680 |
| 2750 | 3048 | 3015 | 3315 |
| 2897 | 3209 | 3174 | 3488 |
| 3090 | 3427 | 3390 | 3723 |
| 3875 | 4296 | 4250 | 4669 |
| 4073 | 4515 | 4466 | 4907 |

Pricing is continued on the following page.

U C C
Closed Stacker
(Continued)

DIMENSIONS
INCHES / MM

PRICING

| DIMENSIONS | | VENEER CASE | | | |
|------------|-----------|-----------------------|-----------------------------|-----------------------------|---------------------|
| H | W | Seamless Back & Front | Seamless Back, Veneer Front | Veneer Back, Seamless Front | Veneer Back & Front |
| 23 / 584 | 24 / 610 | 2068 | 2299 | 2351 | 2584 |
| 23 / 584 | 30 / 762 | 2184 | 2430 | 2485 | 2731 |
| 23 / 584 | 36 / 914 | 2379 | 2648 | 2707 | 2974 |
| 23 / 584 | 42 / 1067 | 3076 | 3422 | 3499 | 3844 |
| 23 / 584 | 48 / 1219 | 3425 | 3809 | 3897 | 4281 |
| 30 / 762 | 24 / 610 | 2223 | 2474 | 2529 | 2779 |
| 30 / 762 | 30 / 762 | 2340 | 2604 | 2662 | 2928 |
| 30 / 762 | 36 / 914 | 2536 | 2821 | 2883 | 3171 |
| 30 / 762 | 42 / 1067 | 3180 | 3538 | 3618 | 3975 |
| 30 / 762 | 48 / 1219 | 3532 | 3931 | 4017 | 4416 |
| 38 / 965 | 24 / 610 | 2536 | 2821 | 2883 | 3171 |
| 38 / 965 | 30 / 762 | 2653 | 2951 | 3017 | 3317 |
| 38 / 965 | 36 / 914 | 2848 | 3170 | 3241 | 3561 |
| 38 / 965 | 42 / 1067 | 3547 | 3944 | 4034 | 4432 |
| 38 / 965 | 48 / 1219 | 3895 | 4332 | 4429 | 4868 |
| 45 / 1143 | 24 / 610 | 2756 | 3068 | 3138 | 3446 |
| 45 / 1143 | 30 / 762 | 2902 | 3228 | 3300 | 3627 |
| 45 / 1143 | 36 / 914 | 3100 | 3447 | 3524 | 3873 |
| 45 / 1143 | 42 / 1067 | 3883 | 4322 | 4418 | 4855 |
| 45 / 1143 | 48 / 1219 | 4082 | 4543 | 4644 | 5105 |