

YNP Workstation Name Plate

What's Included

Solid Screens/Framed Fabric Screens/Infinity Screens/Smooth Felt Screens

1 metal bracket, 1 name plate consisting of 1 metal bezel and 1 plastic chassis, 1 transparent cover sheet, 1 whiteboard, information sheet with link to template

Wall Mount/Accessory Mount

1 name plate consisting of 1 metal bezel and 1 plastic chassis, 1 metal mounting plate, 1 transparent cover sheet, 1 whiteboard and 1 information sheet with link to template

Notes

Workstation Name Plate magnetically attaches onto the metal bracket.

The single-sided option is available on all screens. The double-sided option is available on the Solid Screen, Framed Fabric Screen and the Smooth Felt Screen.

Whiteboard Name Plate can be used in two different ways:

Whiteboard - for non-permanent use such as hot-desking or co-working applications.

Printed Template - for more permanent applications, users can print their name plate using templates provided on product website.

Printed template is placed behind the transparent cover sheet for added protection.

Customizable templates are available for download at www.teknion.com/workstation-nameplate.

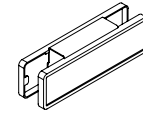

Solid Screen

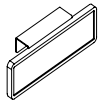

Frame Fabric Screen

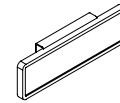

Infinity Screen

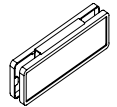

Smooth Felt

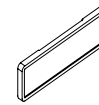

Wall Mount

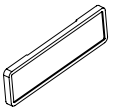

Accessory Mount

PRODUCT OPTIONS

Application Type	Screen Application	Bracket Finish	Bezel Finish
01 Solid Screen	N Not Applicable	Foundation	Foundation
02 Frame Fabric Screen	S Hang-on Single-Sided	Mica	Mica
03 Infinity Screen	D Hang-on Double-Sided	Accent	Accent
04 Smooth Felt			
05 Wall Mount			
06 Accessory Mount			

SAMPLE ORDER CODE

YNP 01	S	24	24
--------	---	----	----

APPLICATION

Hang-On Single-Sided	
Hang-On Double-Sided	
Workstation Name Plate, Wall/Accessory Mount	

PRICING

	Bracket Foundation	Bracket Mica/Accent
Hang-On Single-Sided	83	85
Hang-On Double-Sided	166	170
Workstation Name Plate, Wall/Accessory Mount	83	85

If Bazel Mica/Accent Single-Sided Finish is specified, add 2

If Bazel Mica/Accent Double-Sided Finish is specified, add 4