

Smooth Felt Hoodie with Laminate

The Smooth Felt Hoodie Desk Screen with Laminate attaches to the worksurface on the back and the lateral edge on both sides of the worksurface. It provides space division and local desktop privacy in varying levels. The extended roof top adds a more perceived acoustical privacy.

What's Included

1 Smooth Felt Hoodie Desk Screen with Laminate, attachment brackets and hardware.

Notes

The screen depth is 18" with a 1/2" wire gap on the back edge of the screen. Overall height of the screen is 65" (36" above worksurface).

Screen is designed to accompany a Rectangular Worksurface (with or without Radius Corners) 24" and 30" depth. Compatible with Navigate and hiSpace Quick Connect height-adjustable tables.

The metal bar is Steel and is defaulted to match the felt color specified.

Add on light option.

Xpress Available through *Teknion's Xpress Program*.

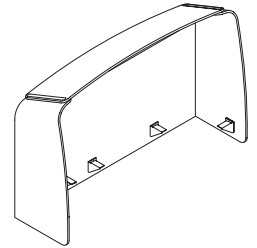

PRODUCT OPTIONS

Width	Modesty Base Height	Hoodie Top Finish	Back Pattern	Ambient Light
46, 52, 58, 60, 64, 70, 72	S Partial Modesty Height (23") T Semi-Modesty Height (19")	Smooth Felt Colors	Source Laminate	N No Y Yes

SAMPLE ORDER CODE

GZHL 46	S	R4	XG	N
----------------	----------	-----------	-----------	----------

DIMENSIONS INCHES / MM

W
46 / 1168
52 / 1321
58 / 1473
60 / 1524
64 / 1626
70 / 1778
72 / 1829

PRICING

Partial Modesty Height (23")	Semi-Modesty Height (19")
1926	2180
1926	2180
2180	2230
2270	2332
2270	2332
2332	2382
2332	2382

If Ambient Light is specified, add 416