

study tables

Xpress

THLBR Rectangular Base

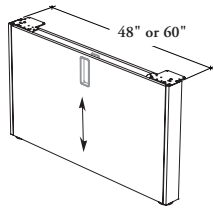

Double-Sided (D)

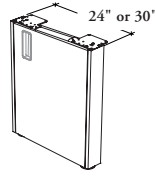

Single-Sided –
Right (R) or Left (L) Handed

Supports to be installed at both end of the Single- or Double-Sided Library Table. This product can also be specified on ADA Extension for Library Table.

WHAT'S INCLUDED

1 rectangular base with levelers, 1 or 2 cable pass-through grommets (as specified), mounting brackets, and mounting hardware.

WHAT'S EXCLUDED

Single- or Double Library Tables and Cable Pass-Through Cover.

NOTES

Base height is 29" or 33" from finished floor to the top of the finished worksurface with a leveling range of 3 1/2".

Rectangular Bases on Library Table – Single-Sided are handed and must be specified right or left.

Must be specified the same depth than the Library Table.

The inside panel comes always with a Cable Pass-Through Grommet.

Not all finishes are available in Xpress, Please see Xpress catalogue and/or specification software for details.

PRODUCT OPTIONS

Configuration	Height	Depth	External Cable Pass-Through Grommet Option	External Panel Finish	Internal Panel Finish	Support Finish
D Double-Sided (Shown)	29, 33 (ADA)	24, 30, 48, 60	N None	Source Laminate	Source Laminate	AC Clear Anodized Foundation Mica
L Single-Sided – Left Handed (Shown)			W With External Cable Pass-Through Grommet (Shown)	Flintwood	Flintwood	
R Single-Sided – Right Handed						

SAMPLE ORDER CODE

THLBR L	29	24	N	3E	3E	AC
----------------	-----------	-----------	----------	-----------	-----------	-----------

DIMENSIONS INCHES / MM

H	D
29 / 737	24 / 610
29 / 737	30 / 762
29 / 737	48 / 1219
29 / 737	60 / 1524
33 / 838	24 / 610
33 / 838	30 / 762
33 / 838	48 / 1219
33 / 838	60 / 1524

PRICING

SINGLE-SIDED CONFIGURATION (L/R)

Source Laminate	Flintwood
682	1132
732	1223
n/a	n/a
n/a	n/a
710	1202
792	1385
n/a	n/a
n/a	n/a

DOUBLE-SIDED (D)

Source Laminate	Flintwood
n/a	n/a
n/a	n/a
882	1714
983	n/a
n/a	n/a
n/a	n/a
962	1868
1072	n/a

UPCHARGE FLINTWOOD INTERNAL PANEL

449
491
832
n/a
492
594
906
n/a