

Supports to be installed at both end of the Single- or Double-Sided Library Table. This product can also be specified on ADA Extension for Library Table.

**WHAT'S INCLUDED**

**Single-Sided Configuration:** 1 end gable with levelers, 1 cable pass-through grommet (if specified), mounting brackets, and mounting hardware.

**Double-Sided Configuration:** 1 end gable with levelers, 1 cable pass-through grommet (if specified), mounting brackets, and mounting hardware.

**WHAT'S EXCLUDED**

Single- or Double-Sided Library Tables and Cable Pass-Through Cover.

**NOTES**

Base height is 29" or 33" from finished floor to the top of the finished worksurface with a leveling range of 3 1/2".

End Gable is handed and must be specified right or left.

Must be specified the same depth the Library Table.

The 1 1/2" (Q) thickness is **not** available in all Source Laminate colors. Refer to the Application Guide for details.

**Not** all finishes are available in Xpress, Please see Xpress catalogue and/or specification software for details.



**THLBG**  
**End Gable – Solid**

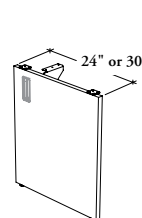

Single-Sided –  
Right (R) or Left (L) Handed

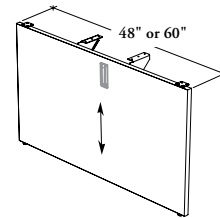

Double-Sided (D)

**PRODUCT OPTIONS**

Gable Thickness	Configuration	Height	Depth	Cable Pass-Through Grommet Option	Gable Finish
D 1"	D Double-Sided (Shown)	29, 33 (ADA)	24, 30, 48, 60	W With Cable Pass-Through Grommet (Shown)	Source Laminate
Q 1 1/2"	L Single-Sided – Left Handed (Shown)			N None	Flintwood
	R Single-Sided – Right Handed				

**SAMPLE ORDER CODE**

<b>THLBG Q</b>	<b>L</b>	<b>33</b>	<b>48</b>	<b>W</b>	<b>VZ</b>
----------------	----------	-----------	-----------	----------	-----------

**DIMENSIONS**  
**INCHES / MM**

H	D
29 / 737	24 / 610
29 / 737	30 / 762
29 / 737	48 / 1219
29 / 737	60 / 1524
33 / 838	24 / 610
33 / 838	30 / 762
33 / 838	48 / 1219
33 / 838	60 / 1524

**PRICING**

**SINGLE-SIDED CONFIGURATION (L/R)**

1" (D)	
Source Laminate	Flintwood
299	959
345	1080
n/a	n/a
n/a	n/a
334	1042
384	1269
n/a	n/a
n/a	n/a

**DOUBLE-SIDED (D)**

1" (D)	
Source Laminate	Flintwood
n/a	n/a
n/a	n/a
507	1761
594	n/a
n/a	n/a
n/a	n/a
566	1940
668	n/a

**1 1/2" (Q)**

H	D
29 / 737	24 / 610
29 / 737	30 / 762
29 / 737	48 / 1219
29 / 737	60 / 1524
33 / 838	24 / 610
33 / 838	30 / 762
33 / 838	48 / 1219
33 / 838	60 / 1524

Source Laminate	Flintwood
369	1020
426	1155
n/a	n/a
n/a	n/a
413	1110
480	1357
n/a	n/a
n/a	n/a

Source Laminate	Flintwood
n/a	n/a
n/a	n/a
640	1884
757	n/a
n/a	n/a
n/a	n/a
718	2080
854	n/a