

The On-Module Hooks can be attached to the back of the Overhead Cabinet (DSF) or A4 Overhead Cabinet (DSFM) to enable on-module mounting to the panel.

WHAT'S INCLUDED

2 (1 left, 1 right) on-module hooks, attachment hardware.

S F O M On-Module Hooks

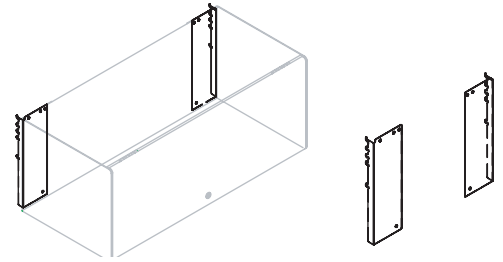

PRODUCT OPTIONS

Finish	Cabinet Type	Cabinet Purchase Date
Foundation	1 DSF 2 DSFM	A On or Post October 2005 B Pre October 2005

SAMPLE ORDER CODE

SFOM E	2	A
--------	---	---

PRICING

51
