

freestanding modules

FREESTANDING MODULES OVERVIEW	106
DESKS & TABLE BASICS	107
COMPONENTS & ASSEMBLY	108
DESK CREEP	109
WORKSURFACES, MODESTY PANELS & GABLE BASICS	110
PLANNING WITH MODESTY PANELS & GABLES	111
STABILITY REQUIREMENTS	112
EDGE TRIM STYLE OVERVIEW	113
GRAIN DIRECTION / USER EDGE	113
STORAGE BASICS	114
WIRE MANAGEMENT OVERVIEW	115
T/O/S STORAGE COMPATIBILITY WITH INSTALLED WIRE TRAY	116
PLANNING WITH FREESTANDING MODULES AND T/O/S PANELS	117

freestanding modules

freestanding modules overview

Freestanding Modules are a collection of preconfigured desks and individual components that can be used for building freestanding workstations or reconfiguring units.

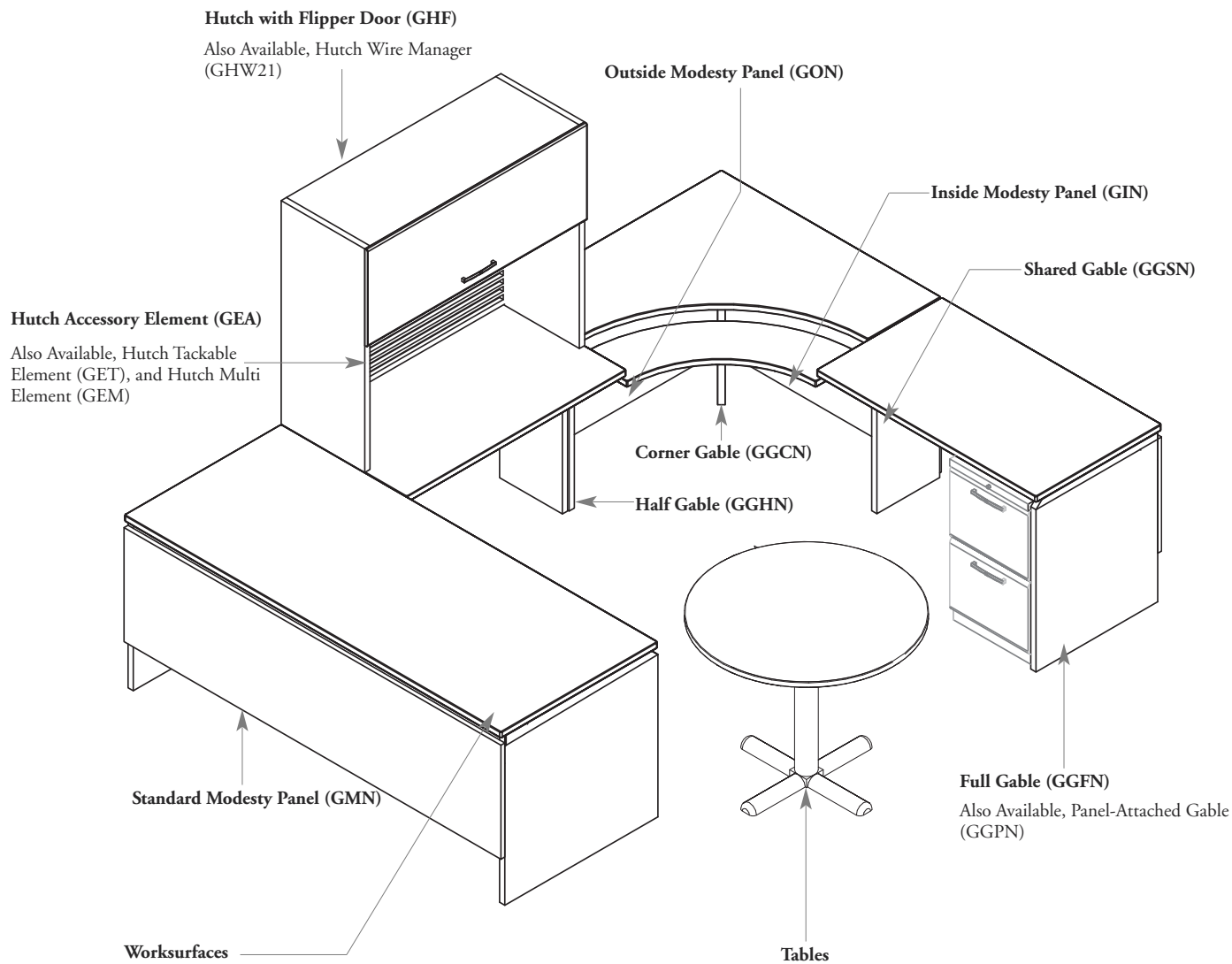

freestanding modules

desks & tables basics

The desking system can be used on its own or in a variety of other environments including drywall offices; it combines T/O/S worksurfaces with modesty panels and supports to create preconfigured units.

- All desks, returns, bridges and tables are complete units with modesty panels and gables included
- Desks, returns and bridges come with options for height and depth of modesty panel
- All semi-supported desks must be attached to another desk for support
- Levelers have a 1" leveling range
- Desk height is 29" with a leveling range of 1"

Rectangular Bridge with Half Gable (GDRHN)

Is a semi-supported bridge used between two other semi-supported desks

- **Corner Desks** are used between two semi-supported desks to enable application of a keyboard support
- Comes complete with grommets in back corner for wire access
- Outside modesty panel is located on the left side of the unit from the users perspective, and overlaps the inside modesty panel on the right side to complete the corner detail

- Split corner and keyboard support option has an adjustment range of 10" in total, 5" above and 5" below the surface—it is activated by a panel on the right underside of the support—it has a tilt range of +15° to -10° and is adjusted with a tension panel on the left underside of the support

- **Rectangular Return Desks** are available with full gable or full and half gable
- Are semi-supported desks used as a return, at the end of a run of desks, or when butting two desks together
- Must be attached to another desk

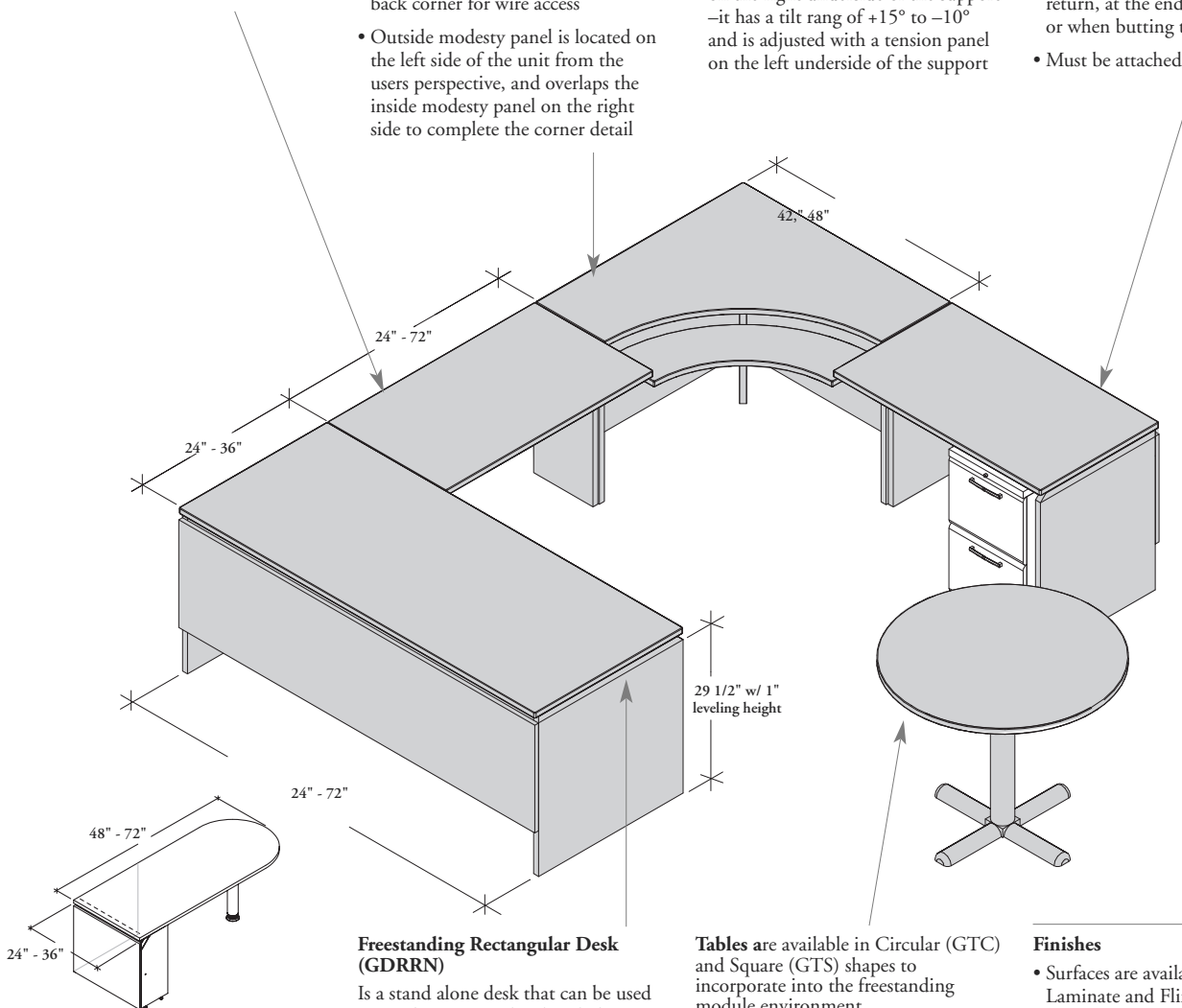

Freestanding Rectangular Desk (GDRRN)

Is a stand alone desk that can be used in combination with other desks or returns

Tables are available in Circular (GTC) and Square (GTS) shapes to incorporate into the freestanding module environment

Finishes

- Surfaces are available in Foundation, Laminate and Flintwood Stains
- Edges are available in Slim, Flintwood Slim, Straight and Flintwood Straight trims
- Gables and modesty panels are available in Source Laminates and Flintwood Stains
- Monolegs are available in Foundation and Mica colors

Conference Bullet Top Desk (GCBSN)

- Are available with full and half gable, or two half gables, and are used as a conference surface or return
- Offer a recessed gable option is available for the full gable on the outside only

freestanding modules

components & assembly

The following diagrams demonstrate the components that comprise pre-configured Freestanding Modules.

! Size, shape and dimensions will vary from desk to desk

rectangular return exploded view – front

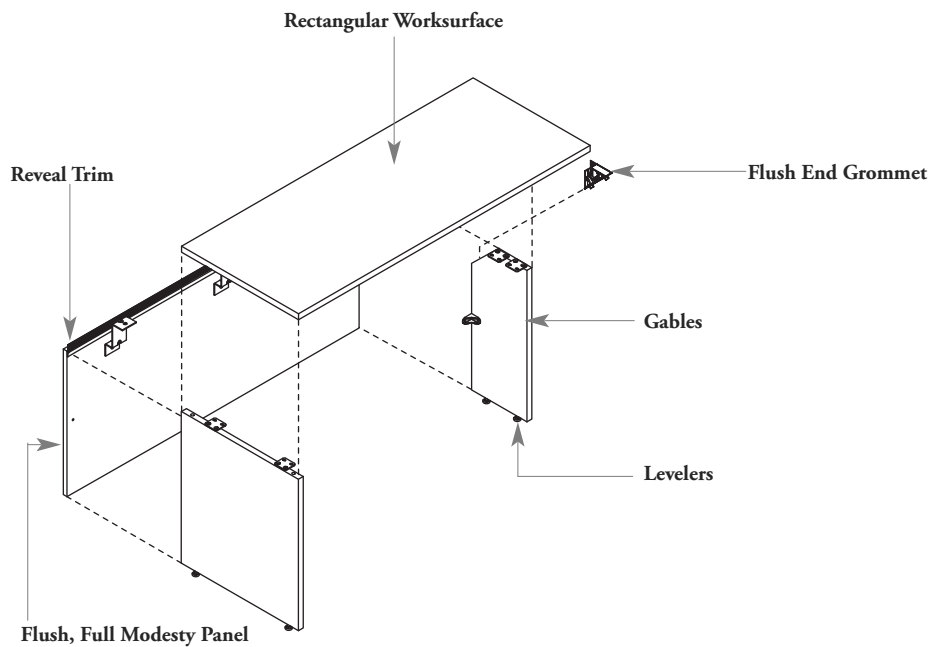

108

rectangular return exploded view back

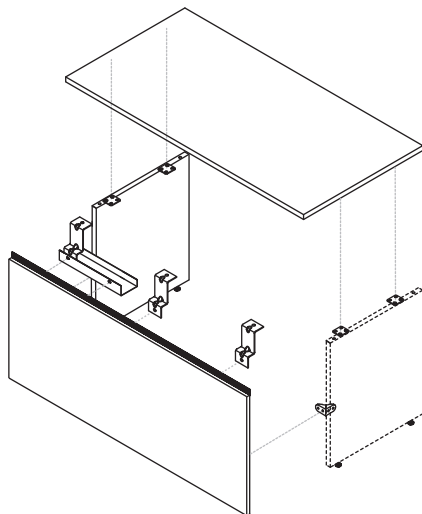

Worksurfaces, gables and modesty panels are attached with mechanical screws and inserts

freestanding modules attachment with brackets

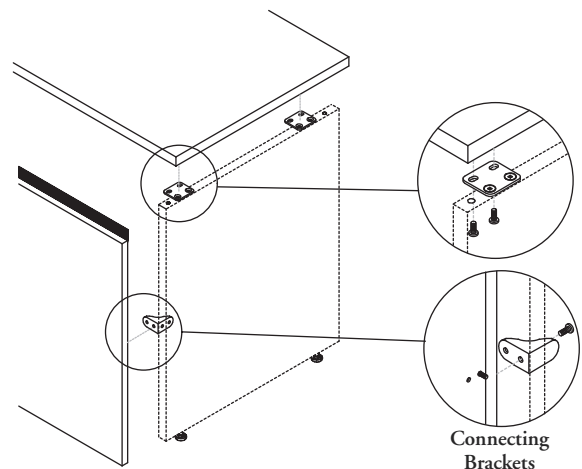

Creep must be taken into consideration when planning. Creep is the amount of extra space that must be added to a worksurface, it is the difference between the nominal and the actual dimensions.

- All worksurface dimensions are nominal
- Desks 24" – 60" are actually 1/8" wider and deeper than their nominal dimension
- Desks 66" – 72" wide are 1/4" wider and 1/8" deeper than their nominal dimensions

single desks – creep factor examples

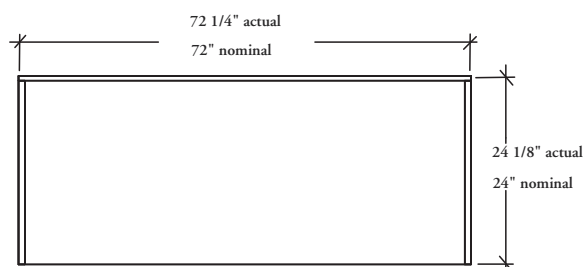
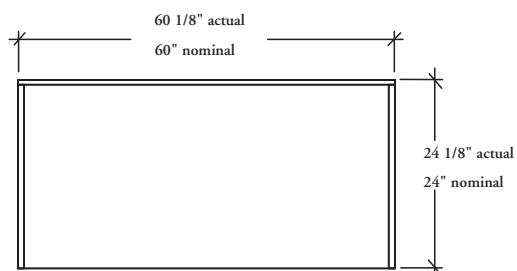

plan view

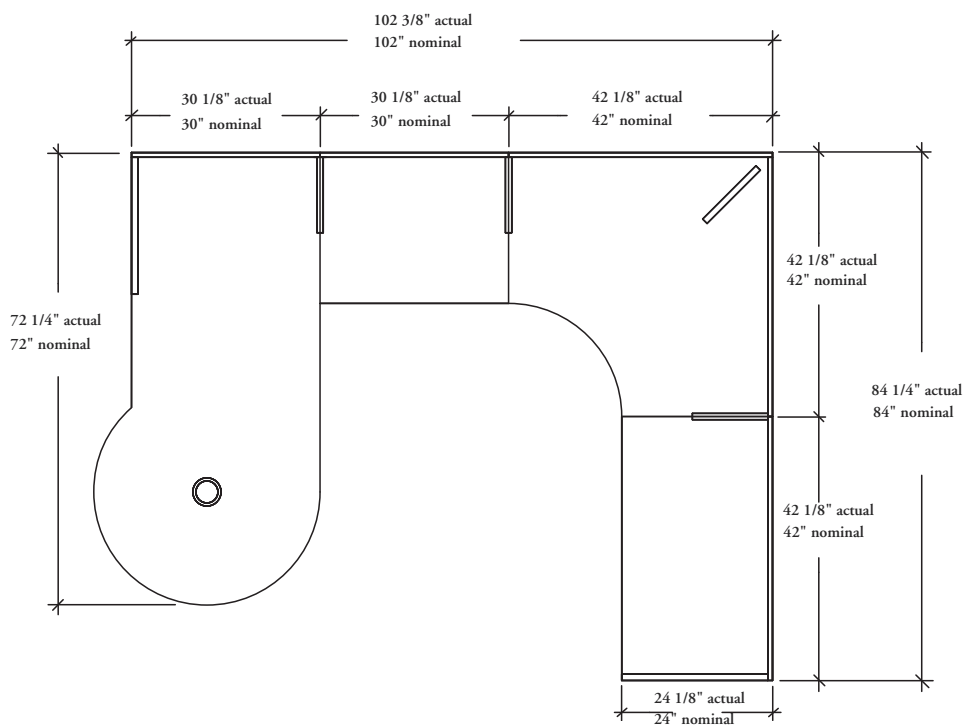

worksurfaces, modesty panels & gable basics

Freestanding Modules offer a variety of individual surfaces, gables and modesty panels for building up units or for reconfiguration purposes

- Modesty panels and gables are required to support freestanding desks
- Flush plates are required for all shared and half gables
- Shared, half and corner gables cannot adequately support a freestanding desk
- Full gables must be used at either end of a desk or run of desks for stability
- Levelers have a 1" leveling range
- When building up a corner desk, Standard (GMN), Inside (GIN) and Outside (GON) modesty panels are required

- **Modesty Panels** are the mandatory structural component when building up a desk providing privacy and stability
- Available in Full, 3/4, Raised and 1/2 heights
- Wire brackets attach to the modesty panel and worksurface to provide structural stability
- The number of modesty wire trays is dependent upon the modesty panel width (24"-42" needs one, 45"-54" needs two, 60"-72" needs three.)
- Can accommodate a Wire Tray (GMT) for the passage of larger amounts of power and communication wires and support power bars

Half Gable (GGHN)
Is used to build up semi-supported desks and provides future reconfiguration options

Inside Modesty Panel (GIN)
• Is overlapped by the Outside Modesty Panel (GON) to complete the corner detail on corner desks
• Must be used with an Outside Modesty Panel (GON)
• Must also be specified with a Corner Gable (GGCN)

Panel-Attached Full Gable (GGPN)
• Enables a freestanding desk to be panel-attached with an on-module connection

- The panel to which the full gable is attached takes the place of the modesty panel

• Comes with handed hardware

OR

Full Gable (GGFN)

- Used for support on a freestanding desk or at the end of a run of semi-supported desks
- Full Gables or Full and Half Gables are used to build up any freestanding or semi-supported desk

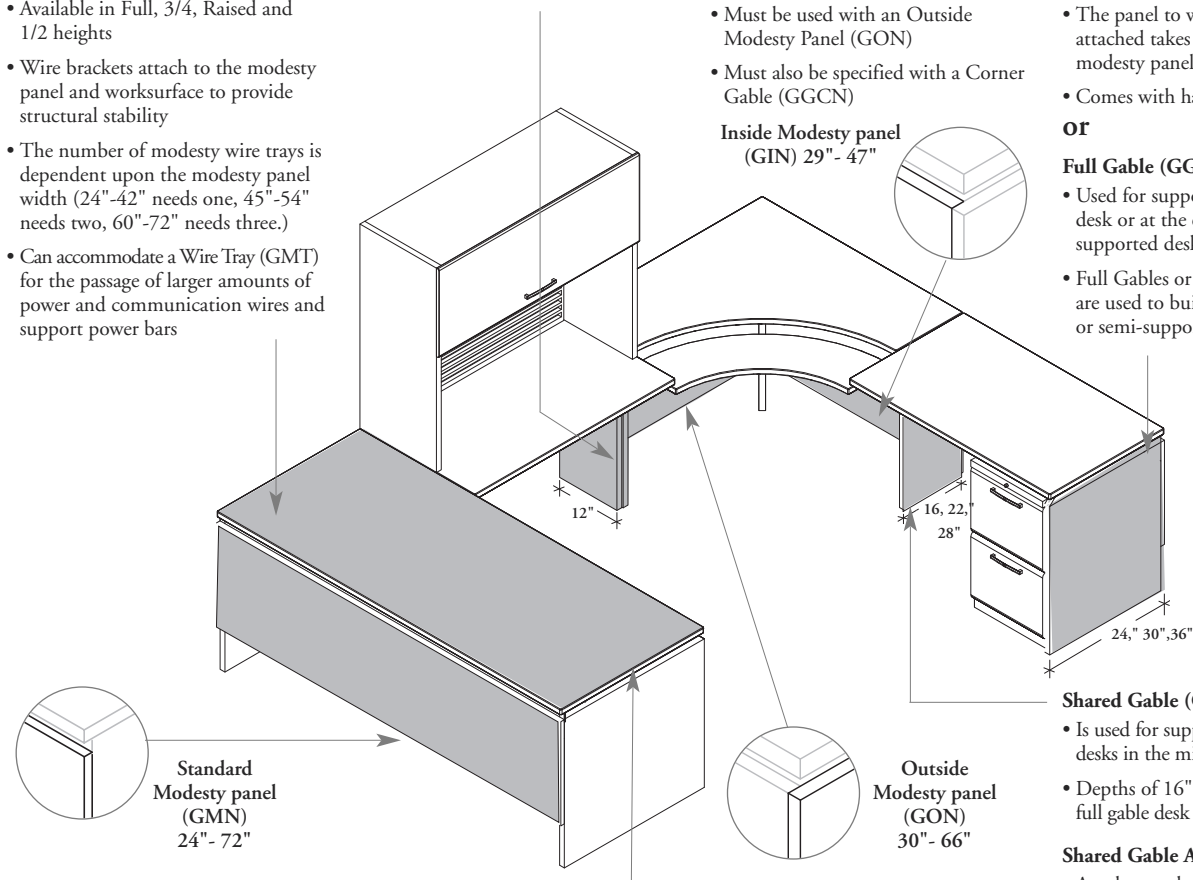

Standard Modesty panel (GMN) 24" - 72"

Outside Modesty panel (GON) 30" - 66"

- **Standard Modesty Panel (GMN)**
- Connects to the rear (visitor's side) of the desk, return or bridge
- Is not for use on a corner desk which requires Inside (GIN) and Outside Modesty Panels (GON)

- **Worksurfaces** are specified when building up any workstation and can also be panel-mounted in a T/O/S panel environment
- Come complete with inserts to enable connection to gables and modesty panels

Outside Modesty Panel (GON)
Overlaps the Inside Modesty Panel (GIN) to complete the corner detail on Corner Desks

Finishes

- Surfaces are available in Foundation Laminate and Flintwood stains
- Edges are available in Slim, Flintwood Slim, Straight and Flintwood Straight trims
- Gables and modesty panels are available in Source Laminates and Flintwood stains

Shared Gable (GGSN)

- Is used for support on semi-supported desks in the middle of a run
- Depths of 16", 22" and 28" provide full gable desk support over long runs

Shared Gable Assembly (GBSN)

- Attaches to a half gable to create a shared half gable and can be used in place of two half gables when connecting two semi supported desks
- To ensure stability, the plates on the half gable must be removed and replaced with larger plates supplied with the shared gable assembly

Gable Plate Flush Plate

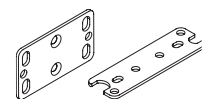

planning with modesty panels and gables

The following information should be considered when planning with modesty panels and gables.

modesty panel options

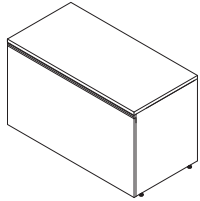

Full Modesty Panel
Flush

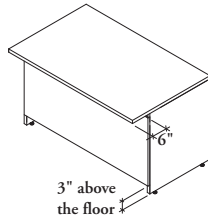

Raised Modesty Panel
Recessed

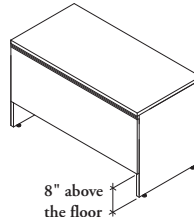

3/4 Modesty Panel
Flush

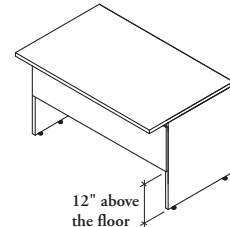

1/2 Modesty Panel
Recessed

Modesty panels are offered in flush and recessed options and are available in four styles:

- Full: flush with the bottom of the gable
- Raised: 3" above finished floor
- 3/4: 8" above finished floor
- 1/2: 12" above finished floor

gable styles

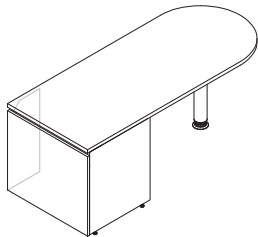

Full Modesty Panel
Flush Gable

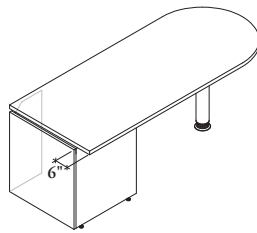

Full Modesty Panel
Recessed Gable

- While modesty panels cannot be recessed in conference desk applications, gables can be
- Please note, only the outside gable (visitor's side) can be recessed
- The gable that connects to another desk must be flush with the worksurface edge

two half gables

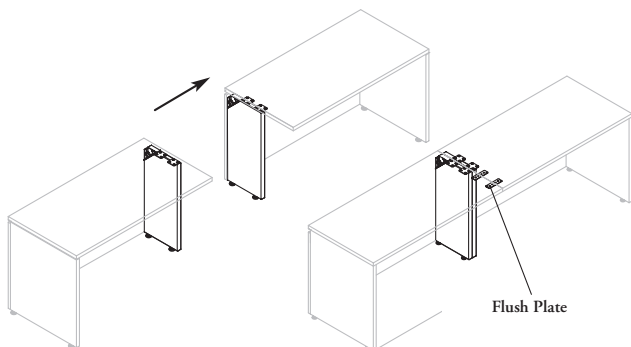

- Two Half Gables can sufficiently support two semi-supported desks butted up against one another
- Two Flush Plates are mandatory in order to maintain stability and a level surface
- Use of two Half Gables allows for flexibility in future reconfigurations.

shared half gables

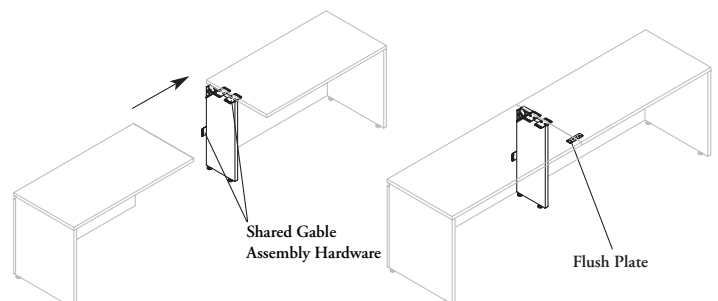

- Desks with only one gable can be connected to another desk using the Shared Gable Assembly brackets (GGSN)
- This hardware allows you to transform a Half Gable (GGHN) into a Shared Gable (GGSN) and can be ordered separately
- A Flush Plate is mandatory in order to maintain stability and a level surface
- Use of a Shared Half Gable may represent a cost reduction in some situations

freestanding modules

stability requirements

The following stability rules apply when planning with Freestanding Modules.

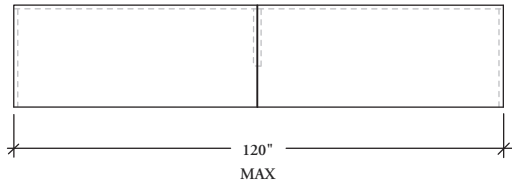

two full gables

- Freestanding Modules need Full Gable support every 120"
- A run of desks cannot exceed 120" without Full Gable support to maintain stability

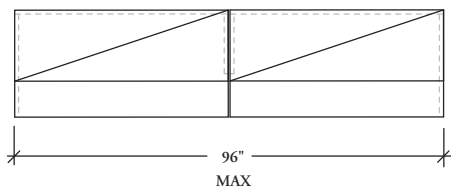

two full gables – supporting hutches

- When supporting Hutches, Freestanding Modules need Full Gable support every 96"
- Stability cannot be ensured if Full Gable support is not maintained every 96" when desks are supporting Hutches

112

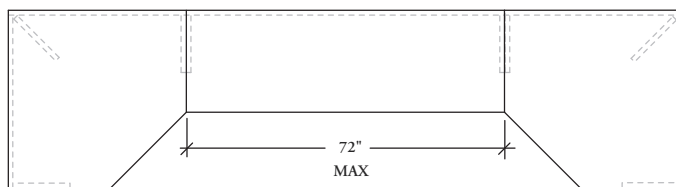

two corner desks

Corner Desks can be used to provide stability instead of Full Gables. However, the distance between the Corner Desks must not exceed 72" if stability is to be ensured

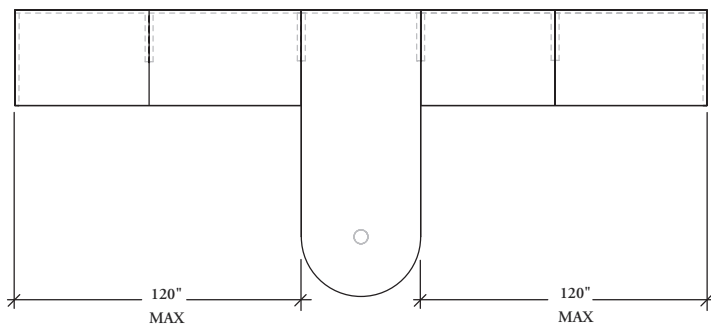

conference desks

- Provide sufficient support when Full Gables are not appropriate
- If the Conference Desk acts as a Full Gable; ensure that 120" is not exceeded on either side of the Conference Desk without Full Gable support

edge trim style overview

The chart below indicates which edge trim style can be specified with all freestanding module finishes.

- Three standard trim styles (Slim and Straight) in two standard finishes (PVC and Flintwood) are available for application to the user edge on Freestanding Modules worksurfaces. The non-user edge is finished in a matching Straight Trim
- The Straight Trim, applied to the non-user edge on Freestanding Modules worksurfaces, matches the specified trim finish applied to the user edge
- When PVC Straight or Flintwood Straight is specified, this trim finishes all edges
- Shading indicates user edge

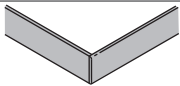
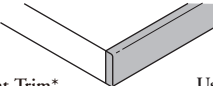
	Foundation Laminate Surface
PVC Straight (6)** All Edges	 All Edges
PVC Slim (A) All Edges	 Straight Trim* User Edge

grain direction/user edge

The illustrations below show the grain direction of Wood Grain Laminate.

- Grain direction is an important factor when planning workstation configurations, if a different grain direction is required, please contact your Teknion Customer Service Representative
- The pattern/grain direction of Laminate worksurfaces varies depending on the type of worksurface specified
- Shading indicates user edge

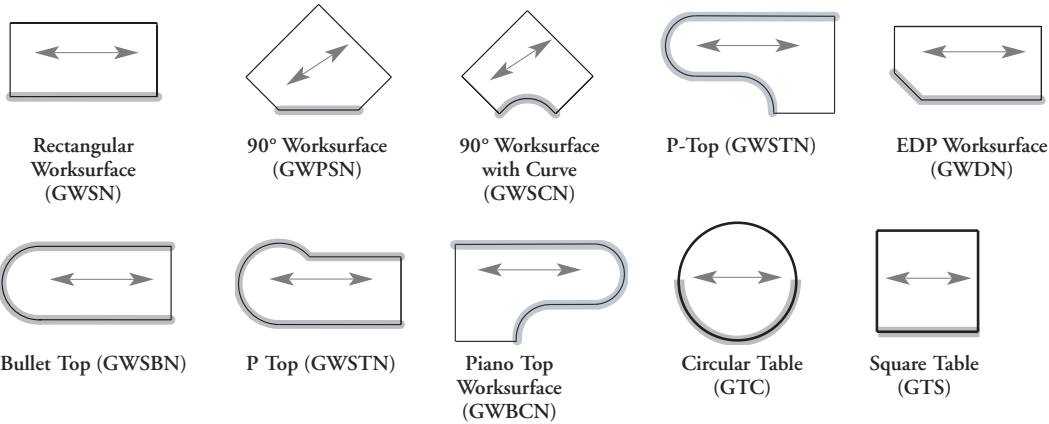

freestanding modules

storage basics

The Hutch provides storage space above the worksurface and privacy between stations.

Hutch with Flipper Door (GHF)

- Provides privacy and storage space above the worksurface
- In widths of 36" - 48" will have one door and hatches while widths of 54" - 72" will have two
- Is divided into two sections, shelf is not included
- Accepts the Utility Light (TY), Shelf Dividers (BK61), Hutch Wire Manager (GHW21) and Hutch Elements (GEA, GET, GEM)

Hutch Accessory Element (GEA)

- Is designed to support Personal Organizers (PAX). For details, see: *Complements Teknion's Ergonomics & Accessories* program
- Is not interchangeable with the T/O/S Accessory Elements (PAE)
- Widths must be specified to match the width of the Hutch

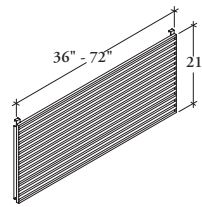

Hutch Wire Manager (GHW21)

- Conceals electrical wires and routes them from the electrical source under the reveal trim and into the light fixture
- Is applied in the corner of a Hutch with an adhesive backing
- Finished in Black

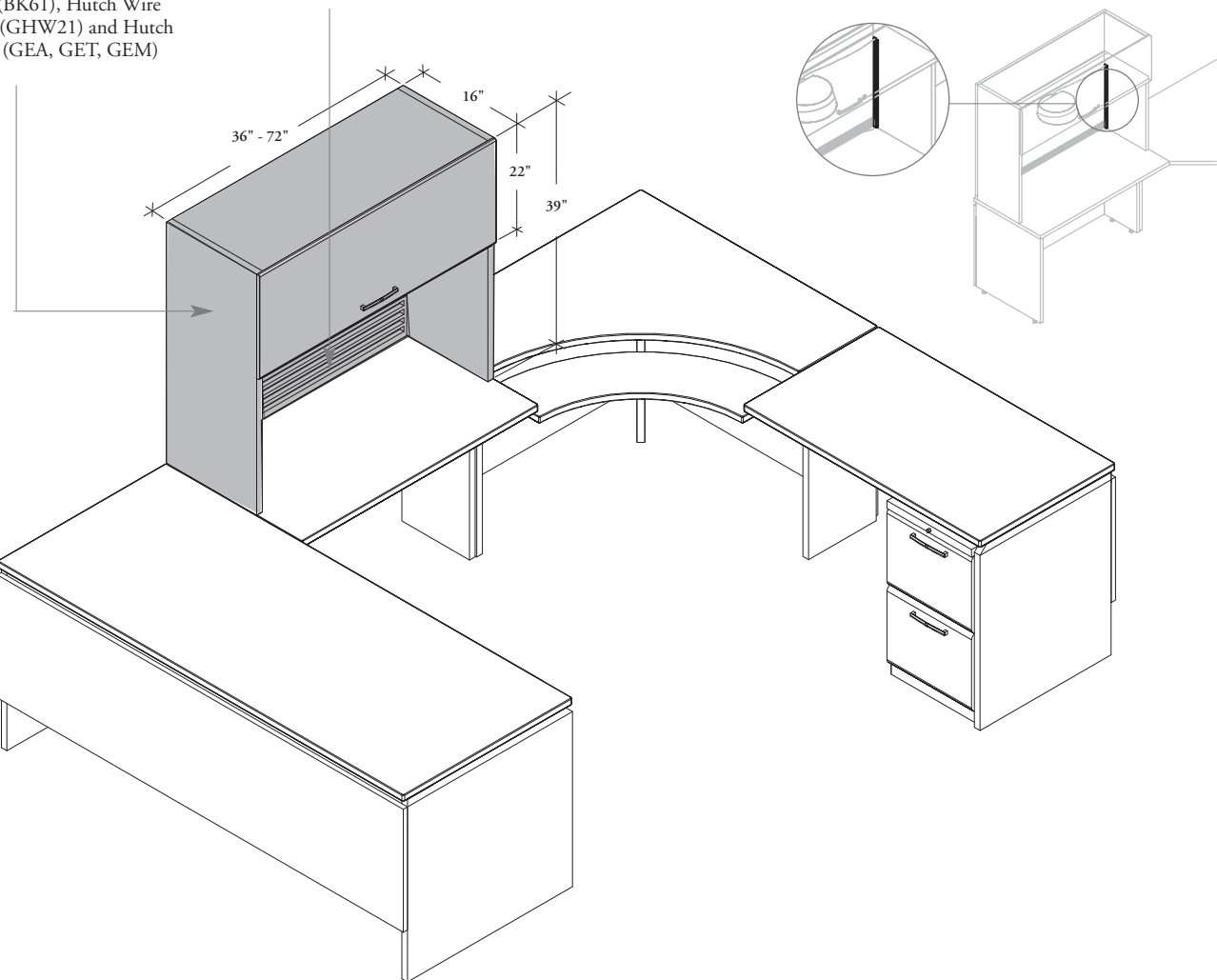

Also Available

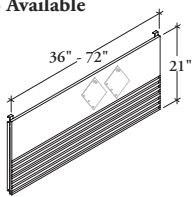

Hutch Multi Element (GEM)

- Is not available with the T/O/S Accessory Element (PAE)
- Also accepts Personal Organizers (PAX)

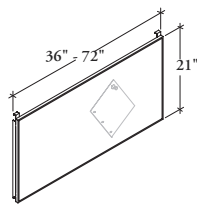

Hutch Tackboard Element (GET)

Is not interchangeable with the T/O/S Tackable Element (PTA)

Finishes

- Case is available in Source Laminate and Flintwood stains
- Laminate doors are available in Foundation Laminates
- Metal doors are available in Foundation and Mica colors
- Flintwood doors are available in a variety of Flintwood stains

freestanding modules

wire management overview

Power and communications wires can rerouted through modesty panel brackets and wire trays.

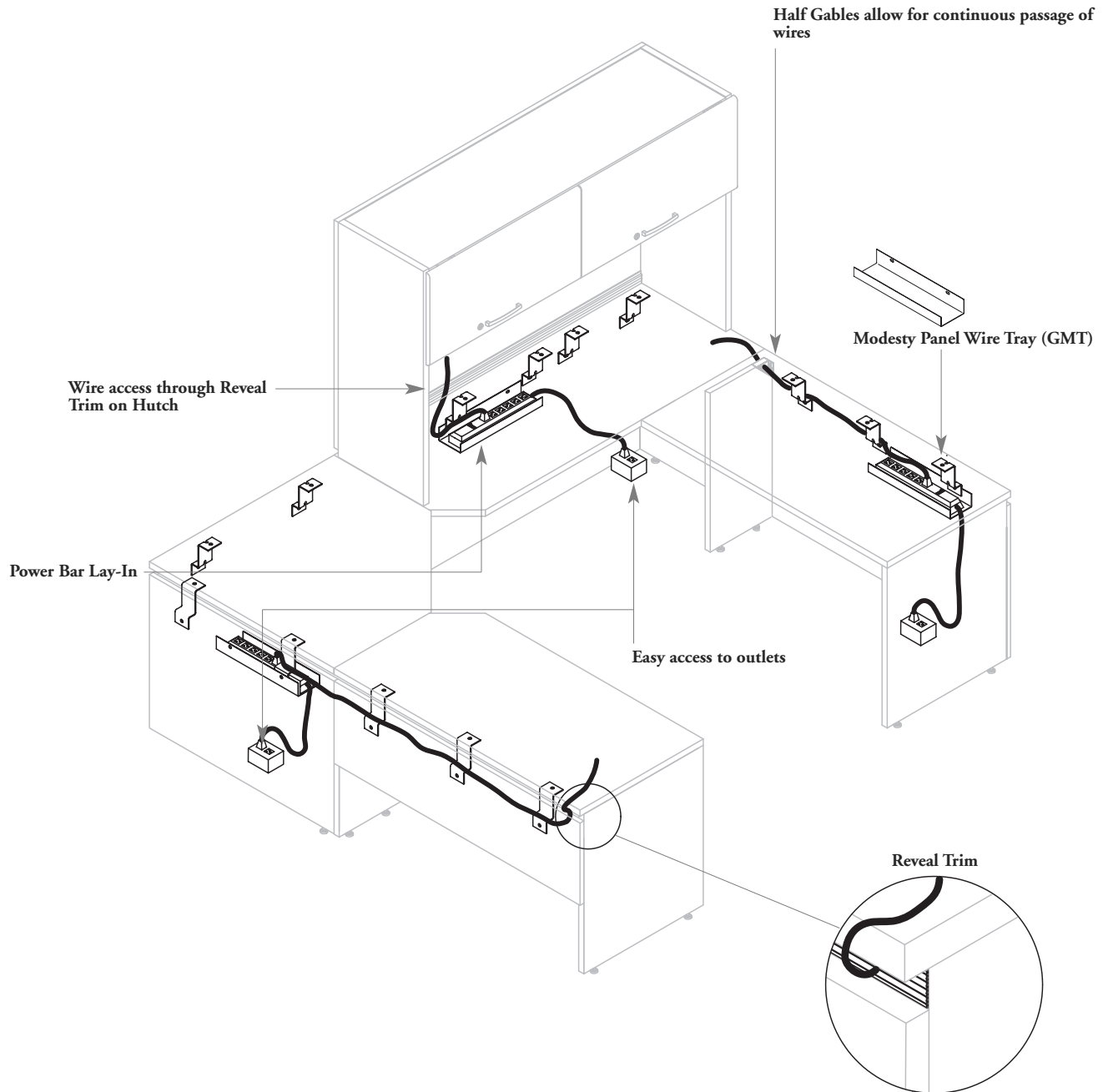





freestanding modules

t/o/s storage compatibility with installed wire tray

The following rules apply when planning storage where Modesty Wire Trays (GMT) exist.

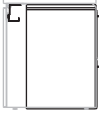
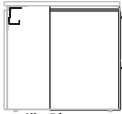
- ❗ If a wire tray is being used the T/O/S storage must be 6" less in depth than the Freestanding Module desks being used
- If it is not being used the T/O/S storage must be 2" less in depth

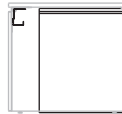
flush modesty panel

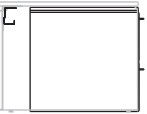
T/O/S Storage Sizes	24" Deep Desk	30" Deep Desk	36" Deep Desk
18" Deep		 6" Clearance	 12" Clearance
22" Deep	Does not fit	 2" Clearance	 8" Clearance
28" Deep	Does not fit	Does not fit	 2" Clearance

recessed modesty panel

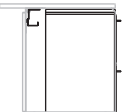
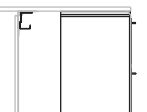
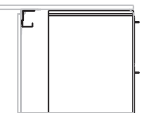
T/O/S Storage Sizes	24" Deep Desk	30" Deep Desk	36" Deep Desk
18" Deep	n/a		 6" Clearance
22" Deep	n/a	Does not fit	 2" Clearance
28" Deep	n/a	Does not fit	Does not fit

storage width compatibility

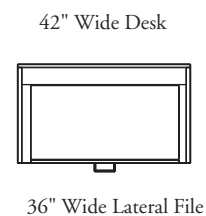
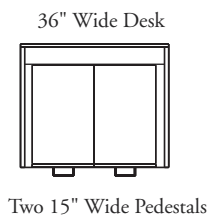
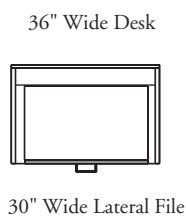

planning with freestanding modules and t/o/s panels

The following example shows how T/O/S panels and Freestanding Modules can work together.

Panels provide spine applications and services and extra wire management capabilities

A variety of element types are available

Freestanding Modules can be used when no panels are required

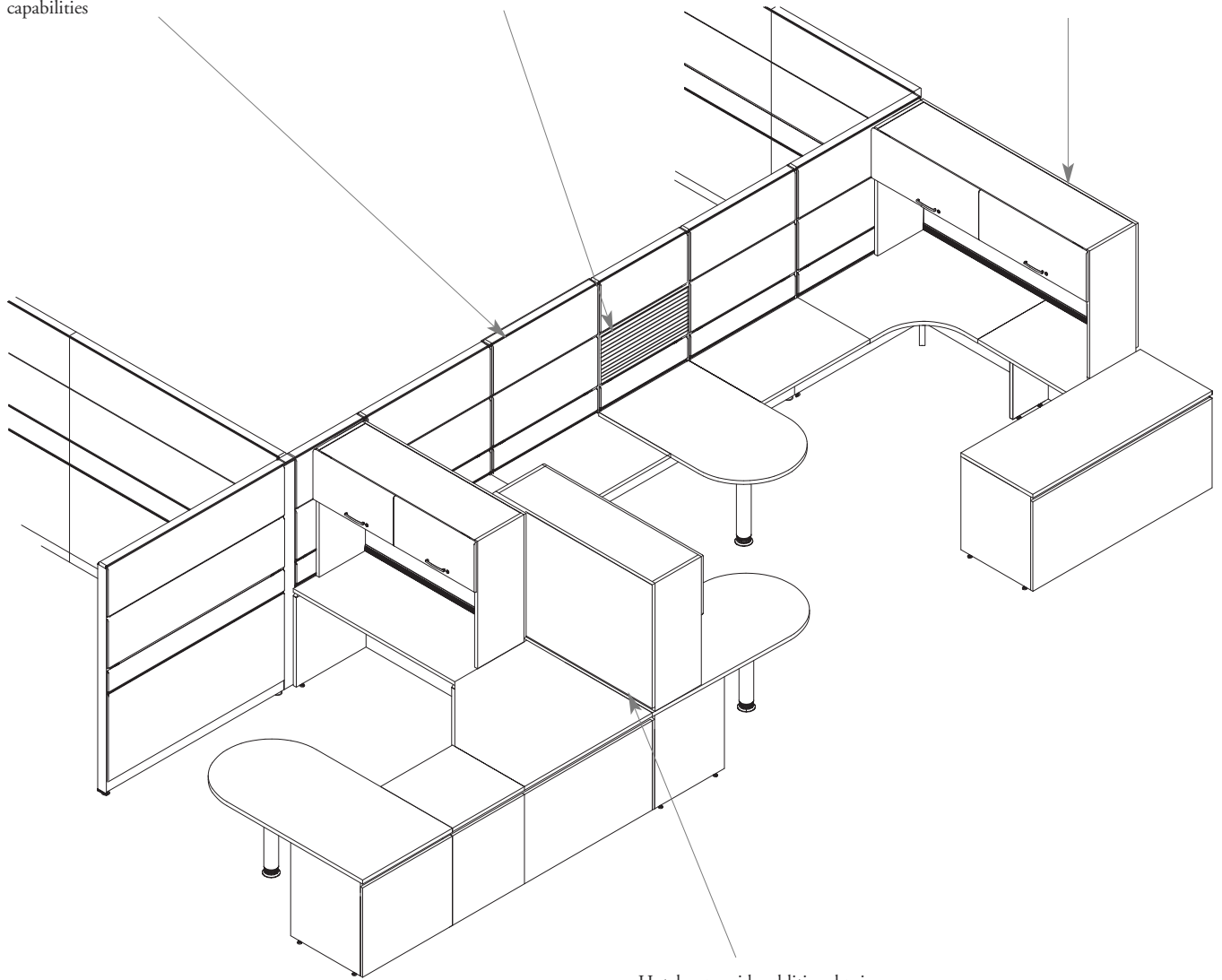

Hutches provide additional privacy as well as storage