

The *Audience* Flintwood Hospitality Cart is designed for use in boardroom applications.

WHAT'S INCLUDED

1 cart, casters, locks and keys (If specified), waste receptacle (if specified), 1 push/pull handle.

WHAT'S EXCLUDED

Hospitality Cart Top (AFMT) must be ordered separately.

NOTES

If the Doors option (A) is specified, glass doors do not support pull or lock options.

Solid doors and drawers will always be finished to match the case finish.

Waste Receptacle is not available when glass doors are specified.

Glass doors do not support pulls or keys.

A F M F *Audience* Flintwood Hospitality Cart

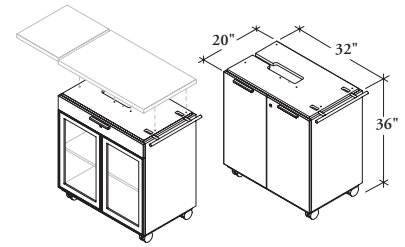

PRODUCT OPTIONS

Configuration	Door Style	Width	Height	Case & Front Finish	Pull Style	Pull Finish	Key Style	Waste Receptacle Option
A Doors	S Solid	32	36	Flintwood	C Contemporary	7 Platinum	N None	1 With
B Doors & Drawer	G Glass				B Rectangular	E Ebony	K Keyed Alike R Keyed Randomly	2 Without

SAMPLE ORDER CODE

AFMF B	S	32	36	FX	C	7	N	1
--------	---	----	----	----	---	---	---	---

DIMENSIONS INCHES / MM

		PRICING			
		DOORS (A)		DOORS & DRAWERS (B)	
W	H	Solid Doors	Glass Doors	Solid Doors	Glass Doors
32 / 813	36 / 914	5029	5441	5926	6065

If Contemporary Pull style, Glass Door is specified, add 37

If Contemporary Pull style, Solid Door is specified, add 80

If Contemporary Pull style, Solid Door & Drawer is specified, add 110

If Lock is specified, add 184

If Waste Receptacle is specified, add 278