

This cabinet offers space for storage as well as easy access for a microwave.

WHAT'S INCLUDED

1 case, 2 doors, pulls (as specified), lock and keys (as specified), mounting hardware, and adjustable shelves as listed below:

	Heights	
	30"	36"
Adjustable Shelf	0	1

WHAT'S EXCLUDED

Wall Supports (RHAWS and RHABC).

NOTES

Wire cut-out must be drilled by the installer.

Door Edge Trim Finish does not apply to Flintwood doors.

Pull Finish does not apply to Stainless Pull (8).

Internal width is determined by subtracting 1.4" from specified width.

R H W M D Wall Cabinet with Microwave Section

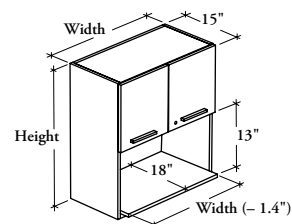

PRODUCT OPTIONS

Depth	Width	Height	Door Finish	Door Edge Trim Finish	Case and Shelf Finish	Hinge Style	Pull Style	Pull Finish (If applicable)	Key Style
15	24, 27, 30, 33, 36	30, 36	Source Laminate Foundation Laminate Flintwood	Edge Trim Colors	Source Laminate	S Standard F Full Extension	1 Standard Expansion 6 Arched 7 Elliptical 8 Stainless 9 Rectilinear	Foundation Accent Mica	R Keyed Randomly K Keyed Alike N No Lock

SAMPLE ORDER CODE

RHWMD 15	24	36	XS	ST	LE	S	9	E	R
---------------------------	-----------	-----------	-----------	-----------	-----------	----------	----------	----------	----------

DIMENSIONS INCHES / MM

D	W	H
15 / 381	24 / 610	30 / 762
15 / 381	24 / 610	36 / 914
15 / 381	27 / 686	30 / 762
15 / 381	27 / 686	36 / 914
15 / 381	30 / 762	30 / 762
15 / 381	30 / 762	36 / 914
15 / 381	33 / 838	30 / 762
15 / 381	33 / 838	36 / 914
15 / 381	36 / 914	30 / 762
15 / 381	36 / 914	36 / 914

PRICING

Source Laminate	Foundation Laminate	Flintwood
897	1000	1493
1008	1120	1679
934	1039	1559
1060	1174	1761
959	1071	1600
1097	1216	1826
1000	1110	1663
1145	1271	1904
1034	1151	1721
1196	1329	1987

If Full Extension Hinge is specified

add 54

If Stainless Pull is specified

add 54

If a Key Style is specified

add 47