

WWGK
Support Locker

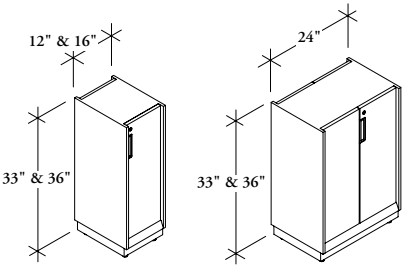

The Support Locker is not a standalone unit. It is always ordered with an overhead to provide storage and privacy in lateral applications.

WHAT’S INCLUDED

1 support locker as specified and plinth skirt base.

NOTES

Available with Plinth Skirt Base only.

Support Locker is 16" deep.

33" high Support Lockers are used with 9" high overheads to achieve 42" datum heights (can only be used with open overheads).

36" high Support Lockers are used with 15" high overheads to achieve 51" datum height.

Single-sided style only available for 12" and 16" widths.

Double-sided style only available for 24" widths.

Ensure product is leveled. If front/door alignment is needed, it can be done by either releasing the front mounting screws, adjusting the front/door and tightening the screws, or by using hinge adjustments to ensure an equal gap.

PRODUCT OPTIONS

Style	Height	Width	Orientation	Case Finish
S Single-Sided D Double-Sided	33, 36	12, 16, 24	L Left R Right	Foundation Mica Accent

SAMPLE ORDER CODE

WWGK S	33	16	L	74
--------	----	----	---	----

PRODUCT OPTIONS CONTINUED

Secondary Color	Front Finish	Handle Finish	Bottom Modifier Finish	Key Option
Foundation Mica Accent	CC Match Case SS Match Secondary Color Source Laminate Flintwood	C All Match Case S Match Secondary Color E Exterior Match Case, Interior Match Secondary Color I Interior Match Case, Exterior Match Secondary Color	C Match Case S Match Secondary Color	K Key Alike R Key Random

SAMPLE ORDER CODE

74	74	C	C	K
----	----	---	---	---

See pricing on following page.

W W G K
Support Locker (Continued)

DIMENSIONS INCHES / MM		PRICING	
H	W	Foundation	Mica/Accent
SINGLE-SIDED (S)			
33 / 838	12 / 305	1449	1494
33 / 838	16 / 406	1485	1528
36 / 914	12 / 305	1480	1526
36 / 914	16 / 406	1512	1557

DIMENSIONS INCHES / MM		PRICING	
H	W	Foundation	Mica/Accent
DOUBLE-SIDED (D)			
33 / 838	24 / 610	1814	1867
36 / 914	24 / 610	1850	1907

If Source Laminate for Double-Sided (D) is specified, add 115
 If Source Laminate for Single-Sided (S) is specified, add: 12" 57
 16" 90

If Flintwood Front for Double-Sided (D) is specified, add 738
 If Flintwood Front for Single-Sided (S) is specified, add: 12" 369
 16" 480