

### Three-High Storage Cabinets

Preconfigured Storage Cabinets provide enclosed storage in heights to match Lateral Files.

#### WHAT'S INCLUDED

1 cabinet case, 2 doors, 2 shelves, hardware, lock and keys.

#### NOTES

Not all configurations are available as Xpress. Please see Xpress catalogue and/or specification software for details.

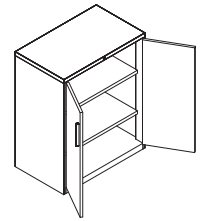

#### PRODUCT OPTIONS

Height	Depth	Width	Front Finish Style	Pull Style	Case & Metal Front Finish	Non-Metal Front Finish	Key Style
<b>L</b> Letter (36.8")	18, 20	30, 36, 42	<b>D0</b> Seamless	<b>A</b> Full Pull (metal front)	Foundation	Seamless Colors	<b>K</b> Keyed Alike
<b>C</b> Combo (40")			<b>D1</b> Metal	<b>B</b> Rectangular Handle Pull	Mica Accent	Flintwood	<b>R</b> Keyed Randomly
<b>B</b> Binder (41.6")			<b>D</b> District Handle Pull (non-metal)				

#### SAMPLE ORDER CODE

<b>LSC31 C</b>	<b>20</b>	<b>36</b>	<b>D1</b>	<b>A</b>	<b>74</b>	<b>R</b>
----------------	-----------	-----------	-----------	----------	-----------	----------

#### DIMENSIONS INCHES / MM

D	W
18 / 457	30 / 762
18 / 457	36 / 914
18 / 457	42 / 1067
20 / 508	30 / 762
20 / 508	36 / 914
20 / 508	42 / 1067
18 / 457	30 / 762
18 / 457	36 / 914
18 / 457	42 / 1067
20 / 508	30 / 762
20 / 508	36 / 914
20 / 508	42 / 1067
18 / 457	30 / 762
18 / 457	36 / 914
18 / 457	42 / 1067
20 / 508	30 / 762
20 / 508	36 / 914
20 / 508	42 / 1067

#### PRICING

METAL FRONT	
Foundation	Mica/Accent
<b>LETTER HEIGHT</b> Xpress	
987	1151
1059	1226
1116	1299
<b>COMBO HEIGHT</b> Xpress	
1024	1192
1094	1269
1152	1337
<b>BINDER HEIGHT</b>	
1043	1226
1113	1289
1172	1358
1043	1226
1113	1289
1172	1358

SEAMLESS FRONT	
Foundation	Mica/Accent
<b>LETTER HEIGHT</b>	
1438	1600
1577	1745
1644	1829
n/a	n/a
n/a	n/a
n/a	n/a
<b>COMBO HEIGHT</b>	
1481	1645
1619	1796
1687	1873
n/a	n/a
n/a	n/a
n/a	n/a
<b>BINDER HEIGHT</b>	
1497	1684
1639	1813
1708	1897
n/a	n/a
n/a	n/a
n/a	n/a

FLINTWOOD FRONT	
Foundation	Mica/Accent
<b>LETTER HEIGHT</b>	
1665	1707
1778	1820
1877	1928
n/a	n/a
n/a	n/a
n/a	n/a
<b>COMBO HEIGHT</b>	
1736	1771
1844	1890
1947	1994
n/a	n/a
n/a	n/a
n/a	n/a
<b>BINDER HEIGHT</b>	
1769	1834
1881	1925
1982	2027
n/a	n/a
n/a	n/a
n/a	n/a

If Rectangular Handle Pull (B) is specified on a Metal Front (D1), add 43