

Storage Unit with Glass Doors combines the filing capabilities of a Lateral File with the flexibility of a storage unit.

#### WHAT'S INCLUDED

1 storage unit with 2 lateral file drawers, pulls, levelers, lock and keys, and accessories as listed below:

	Widths				Heights	
	24"	30"	36"		51"	66" or 72"
15" Cross File Bar	2	4	4	Shelf	1	2

#### WHAT'S EXCLUDED

Top for Solid Storage Cabinet and Hang-On Kit.

#### NOTES

Top on 51" height overlaps side and back panels for a cleaner look and to fit with Elevated Desktop Cabinets.

This Storage Unit with drawers accepts both letter- and legal-size paper.

Holes at 1 1/4" intervals on the inside walls of side panels allow for shelf adjustment.

Additional shelves (RSHE) are available and must be ordered separately.

Cross file bars are included along the depth only.

Frosted (FT) is a single-sided etched tempered glass which is facing inward of storage.

Soft Touch (2) and Standard T/O/S (4) pulls are only available in limited Foundation colors. Refer to the specification software for details.

**Xpress** Not all glass door finishes are available as Xpress, Please see Xpress catalogue and/or specification software for details.

## R B U S G Storage Unit – Glass Doors

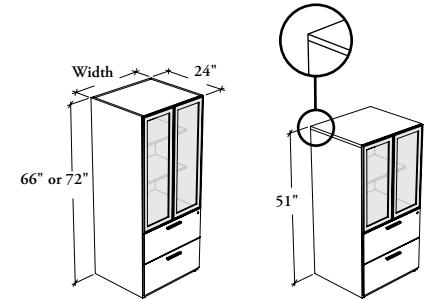

#### PRODUCT OPTIONS

Depth	Drawer Front Finish	Door Frame Finish	Glass Door Finish	Pull Style	Pull Finish	Key Style	Glass Door Lock
24	Source Laminate	Foundation	Standard Glass: CL Clear	1 Standard Expansion	Foundation	K Keyed Alike	0 No
Width	Foundation Laminate	Accent	FT Frosted	2 Soft Touch	Accent	R Keyed Randomly	1 Yes
	Flintwood	Mica	Back-Painted Glass	4 Standard T/O/S	Mica		
24, 30, 36	Edge Trim Finish	AC Clear Anodized		6 Arched			
Height	Edge Trim Colors			7 Elliptical			
	Case Finish			9 Rectilinear			
	Source Laminate						

#### SAMPLE ORDER CODE

<b>RBUSG</b>												
<b>24</b>	<b>30</b>	<b>72</b>	<b>2E</b>	<b>4E</b>	<b>3E</b>	<b>AC</b>	<b>K7</b>	<b>1</b>	<b>E</b>	<b>R</b>	<b>0</b>	

#### DIMENSIONS INCHES / MM

D	W	H
24 / 610	24 / 610	51 / 1295
24 / 610	24 / 610	66 / 1676
24 / 610	24 / 610	72 / 1829
24 / 610	30 / 762	51 / 1295
24 / 610	30 / 762	66 / 1676
24 / 610	30 / 762	72 / 1829
24 / 610	36 / 914	51 / 1295
24 / 610	36 / 914	66 / 1676
24 / 610	36 / 914	72 / 1829

#### PRICING

CLEAR GLASS DOOR (CL)		
Source Laminate	Foundation Laminate	Flintwood
2846	2951	4442
3073	3177	4670
3224	3342	4897
2999	3141	4732
3253	3395	4986
3413	3579	5238
3096	3297	5032
3479	3679	5417
3631	3869	5672

FROSTED GLASS DOOR (FT)/ BACK-PAINTED GLASS DOOR		
Source Laminate	Foundation Laminate	Flintwood
3030	3135	4626
3293	3397	4890
3489	3607	5162
3183	3325	4916
3530	3672	5263
3745	3911	5570
3280	3481	5216
3811	4011	5749
4033	4271	6074

#### GLASS DOOR LOCK (1)

57
57
57
57
57
57
57
57
57
57