

J Z B D O

EZ Off-Module Suspended Credenza
– Lateral File and Cubby – Shared

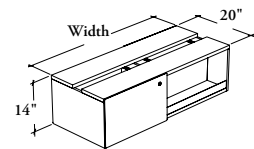

This off-module suspended credenza must be installed off-module under a EZ Fence Beam to provide share filling and casual open storage to both sides of the fence.

WHAT'S INCLUDED
1 ez off-module suspended credenza, 2 drawers, 2 bag holders, 1 12" hanging file bar (per drawer), mounting hardware, lock and keys (as specified).

WHAT'S EXCLUDED
EZ Fence Beam, Chicago EZ Fence Beam and File Drawer Organizer.

NOTES
When Front Style (M or N) is specified, only Metal Front Finish is available.
When Front Style (S or T) is specified, only Laminate Front Finish is available.
When Front Style (M or S) is specified, Pull Style and Pull and Bag Holder Finish are **not** available.
When Front Style (N or T) is specified, Bag Holder Finish are **not** available.

PRODUCT OPTIONS

Front Style	EZ Fence Leg Style	Case Height	Depth	Width	Orientation	Front Finish
M Metal N Metal with Pull S Solid T Solid with Pull	A Angled	14	20	36, 42, 48	L Drawer on Left (Shown) R Drawer on Right	Metal Front: Foundation Accent Mica Laminate Front: Source Laminate Foundation Laminate

SAMPLE ORDER CODE

JZBDO S	A	14	20	72	L	3D
---------	---	----	----	----	---	----

PRODUCT OPTIONS CONTINUED

Edge Trim Finish (Laminate Front Only)	Case Finish	Pull Style (If Applicable)	Pull and Bag Holder Finish (If Applicable)	Bag Holder Finish (If Applicable)	Leg Mounting Hardware Finish	Key Style
Edge Trim Colors	Source Laminate	C Cityline Recessed	Foundation Mica Accent	Foundation Mica Accent	Foundation Mica Accent	K Keyed Alike R Keyed Randomly N No Lock

SAMPLE ORDER CODE CONTINUED

4D	3D			60	60	R
----	----	--	--	----	----	---

See Pricing on the following page.

J Z B D O

**EZ Off-Module Suspended Credenza
– Lateral File and Cubby – Shared (Continued)**

**DIMENSIONS
INCHES / MM**

H	D	W
14 / 356	20 / 508	36 / 914
14 / 356	20 / 508	42 / 1067
14 / 356	20 / 508	48 / 1219

PRICING

METAL FRONT (M) or METAL FRONT WITH PULL (N)

2335
2377
2418

SOLID FRONT (S) or SOLID FRONT WITH PULL (T)

Source Laminate	Foundation Laminate
2335	2398
2377	2450
2418	2501