

beam-mounted storage

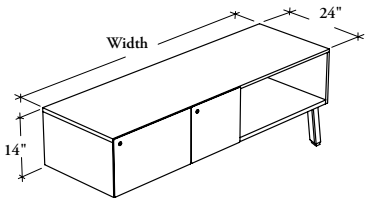

J N B D C

Semi-Suspended Credenza – Open with Combo File



This storage is semi-supported, so it must be installed on front of a structural beam to provide filing, personal and open storage.

WHAT'S INCLUDED

1 credenza, 1 large and 1 small drawers, angled foot with leveler (as specified), lock and keys (as specified), mounting hardware and accessories listed below:

| | Width | | | | Depth |
|--------------------|--------------------|-----|------------|-----|-------|
| | 54" to 72" | | 78" or 84" | | |
| | 18" | 24" | 18" | 24" | |
| | 12" Hang. File Bar | 1 | 1 | 2 | |
| 15" Hang. File Bar | n/a | 1 | n/a | 2 | |

WHAT'S EXCLUDED

Structural Beam, Chicago Structural Beam, EZ Fence Beam, Chicago EZ Fence Beam, EZ Fence Beam for Corridor, Chicago EZ Fence Beam for Corridor, EZ Structural Legs, Structural Legs and File Drawer Organizer.

NOTES

- Small drawer of 18" deep configuration can only store letter size files.
- Beam Configuration must match the beam on which the storage will be mounted.
- This storage unit is equipped with an interlock system that prevents opening more than one drawer at a time.
- The Support Mounting Hardware Finish can be specified to match the case or the leg to which the storage is mounted to. See the application guide section for details.
- When Front Style (M or N) is specified, only Metal Drawer Front Finish is available.
- When Front Style (S or T) is specified, only Laminate Drawer Front Finish is available.
- When Front Style (M or S) is specified, Pull Style and Pull Finish are **not** available.

PRODUCT OPTIONS

| Front Style | Foot and Structural Leg Style | Case Height | Depth | Width | Foot Option | Beam Configuration | Orientation |
|--|-------------------------------|---------------------------|--------|------------------------|----------------------------------|----------------------------------|---|
| M Metal (Shown) N Metal with Pull S Solid T Solid with Pull | A Angled | 14 14" (Datum Height 24") | 18, 24 | 54, 60, 66, 72, 78, 84 | O One Foot (Shown) T Two Feet | D Double-Sided S Single-Sided | L Drawers on Left (Shown) R Drawers on Right |

SAMPLE ORDER CODE

| | | | | | | | |
|---------|---|----|----|----|---|---|---|
| JNBDC S | A | 14 | 24 | 72 | O | D | L |
|---------|---|----|----|----|---|---|---|

PRODUCT OPTIONS CONTINUED

| Front Finish | Edge Trim Finish (for Laminate Front only) | Case Finish | Foot Finish | Pull Style (for Front Style (N or T) only) | Pull Finish (for Front Style (N or T) only) | Key Style | Support Mounting Hardware Finish |
|--|--|-----------------|------------------------------|--|---|--|---|
| Metal Front: (for metal front style) Foundation Mica Accent Laminate Front: (for solid front style) Source Laminate Foundation Laminate | Edge Trim Colors | Source Laminate | Foundation Mica Accent | C Cityline Recessed | Foundation Mica Accent | K Keyed Alike R Keyed Randomly N No Lock | Foundation Mica Accent Coordinate Colors |

SAMPLE ORDER CODE CONTINUED

| | | | | | | | |
|----|----|----|----|--|--|---|----|
| XM | SB | XM | 83 | | | R | 60 |
|----|----|----|----|--|--|---|----|

See Pricing on the following page.

J N B D C

Semi-Suspended Credenza – Open
with Combo File (Continued)DIMENSIONS
INCHES / MM

| H | D | W |
|----------|----------|-----------|
| 14 / 356 | 18 / 457 | 54 / 1372 |
| 14 / 356 | 18 / 457 | 60 / 1524 |
| 14 / 356 | 18 / 457 | 66 / 1676 |
| 14 / 356 | 18 / 457 | 72 / 1829 |
| 14 / 356 | 18 / 457 | 78 / 1981 |
| 14 / 356 | 18 / 457 | 84 / 2134 |
| | | |
| 14 / 356 | 24 / 610 | 54 / 1372 |
| 14 / 356 | 24 / 610 | 60 / 1524 |
| 14 / 356 | 24 / 610 | 66 / 1676 |
| 14 / 356 | 24 / 610 | 72 / 1829 |
| 14 / 356 | 24 / 610 | 78 / 1981 |
| 14 / 356 | 24 / 610 | 84 / 2134 |

| | | |
|----------|----------|-----------|
| 14 / 356 | 18 / 457 | 54 / 1372 |
| 14 / 356 | 18 / 457 | 60 / 1524 |
| 14 / 356 | 18 / 457 | 66 / 1676 |
| 14 / 356 | 18 / 457 | 72 / 1829 |
| 14 / 356 | 18 / 457 | 78 / 1981 |
| 14 / 356 | 18 / 457 | 84 / 2134 |
| | | |
| 14 / 356 | 24 / 610 | 54 / 1372 |
| 14 / 356 | 24 / 610 | 60 / 1524 |
| 14 / 356 | 24 / 610 | 66 / 1676 |
| 14 / 356 | 24 / 610 | 72 / 1829 |
| 14 / 356 | 24 / 610 | 78 / 1981 |
| 14 / 356 | 24 / 610 | 84 / 2134 |

PRICING

| ONE FOOT (O) | | | |
|--|------|--|---------------------|
| METAL FRONT (M) or METAL FRONT WITH PULL (N) | | SOLID FRONT (S) or SOLID FRONT WITH PULL (T) | |
| | | Source Laminate | Foundation Laminate |
| | 1529 | 1529 | 1564 |
| | 1726 | 1726 | 1771 |
| | 1921 | 1921 | 1978 |
| | 2119 | 2119 | 2185 |
| | 2314 | 2314 | 2394 |
| | 2513 | 2513 | 2602 |
| | | | |
| | 1651 | 1651 | 1684 |
| | 1846 | 1846 | 1891 |
| | 2043 | 2043 | 2100 |
| | 2237 | 2237 | 2315 |
| | 2434 | 2434 | 2514 |
| | 2632 | 2632 | 2711 |

| TWO FEET (T) | | | |
|--------------|------|------|------|
| | | | |
| | 1732 | 1732 | 1764 |
| | 1928 | 1928 | 1972 |
| | 2124 | 2124 | 2180 |
| | 2319 | 2319 | 2389 |
| | 2516 | 2516 | 2594 |
| | 2714 | 2714 | 2803 |
| | | | |
| | 1854 | 1854 | 1886 |
| | 2049 | 2049 | 2094 |
| | 2245 | 2245 | 2302 |
| | 2439 | 2439 | 2517 |
| | 2637 | 2637 | 2715 |
| | 2832 | 2832 | 2912 |