

This support is an alternative to legs for Rectangular Worksurfaces (B\_RWL or B\_RWC) and Run-Off Worksurfaces (B\_MHH, B\_MPL or B\_MPG). It can be used in left or right position.

**WHAT'S INCLUDED**

1 semi-supported leg with levelers, mounting bracket, and hardware.

**NOTES**

Specify the Worksurface Thickness and Depth options accordingly with the worksurface under which the Semi-Supported Leg will be installed.

Cannot be used to support a glass top.

Base height is 29" from the finished floor to the top of the finished worksurface with a leveling range of 3".

The 1 9/16" (X) thickness is **not** available in all Source Laminate. Refer to the finish page of the Application Guide for details.

**Not all finishes** are available as Xpress, Please see Xpress catalogue and/or specification software for details.

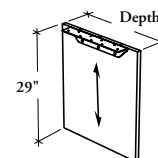

## B W G L

### Semi-Supported Leg – Solid

**PRODUCT OPTIONS**

Worksurface Thickness	Height	Depth	Gable Finish
<b>D</b> 1"	<b>S</b> Standard (29")	24, 30, 36	Source Laminate
<b>M</b> 1 3/16"			Flintwood (No Cathedral)
<b>X</b> 1 9/16"			

**SAMPLE ORDER CODE**

<b>BWGL X</b>	<b>S</b>	<b>24</b>	<b>XS</b>
---------------	----------	-----------	-----------

**DIMENSIONS  
INCHES / MM**

H	D
29 / 137	24 / 610
29 / 137	30 / 762
29 / 137	36 / 914

**PRICING**

1" (D)		1 3/16" (M)		1 9/16" (X)	
GABLE FINISH					
Source Laminate		Source Laminate	Flintwood	Source Laminate	Flintwood
238		238	794	291	841
285		285	910	346	966
n/a		362	1196	402	1260