

Xpress

UPSC

Parallel Spine Credenza for Height-Adjustable Table

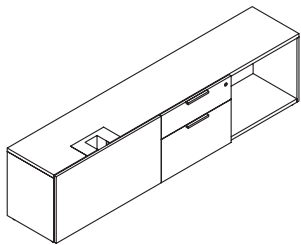

The Parallel Spine Credenza for Height-Adjustable Table is installed parallel to the panel to allow for perpendicular planning with the worksurface. This product can support the panel.

WHAT’S INCLUDED

1 case, box/file drawers with pulls (as specified), lock and keys (if specified), counterweight, leg grommet.

Open with Drawer (P) has an extra kit that contains two 1-1/4" levelers and two 1-3/4" levelers will be shipped with the storage.

WHAT’S EXCLUDED

A Seat Cushion (UWLC) or Fitted Seated Cushion(UWLF) can be ordered separately and can be found in the *Accessories* section.

NOTES

Full Drawer (F) includes extended levelers (UNSLB) already installed.

Hinged door is push latch, no handle required.

The following bases can be installed into this credenza:

Navigate Height-Adjustable Built-in Base - Perpendicular Planning (YGD)

Navigate Height-Adjustable Built-in Gable Base - Perpendicular Planning (YVD)

hiSpace HA Built-in Base - Perpendicular Planning (YSG)

hiSpace HA Built-in Base - Parallel Planning (YSP)

Xpress

Case, Back & Front Finish Flintwood and Natural Veneer are excluded from *Teknion’s Xpress Program*.

PRODUCT OPTIONS

Configuration	Depth	Width	Pull Style	Storage Compartment Location
F Navigate Compatible with Full Drawer	16	72, 78, 84	D District R Rectangular	L Left R Right
P Navigate Compatible Open with Drawer				
E hiSpace Compatible with Full Drawer				
J hiSpace Compatible Open with Drawer				

SAMPLE ORDER CODE

UPSC F	16	72	D	L
--------	----	----	---	---

PRODUCT OPTIONS (CONTINUED)

Pull Finish	Leg Grommet Finish	Case & Back, Front Finish	Key
Foundation	Foundation	Source Laminate	K Key Alike R Key Random N None
Mica	Mica	Flintwood	
		Natural Veneer	

SAMPLE ORDER CODE (CONTINUED)

7	7	ZA	ZA	R
---	---	----	----	---

See pricing in the following page.

UPSC

Parallel Spine Credenza for Height-Adjustable Table (Continued)

DIMENSIONS INCHES / MM

D	W
16 / 406	72 / 1829
16 / 406	78 / 1981
16 / 406	84 / 2134

PRICING

FULL DRAWER (F/E)

SOURCE LAMINATE BACK & CASE		FLINTWOOD BACK & CASE	veneer BACK & CASE
Source Lam. Front	Flintwood Front	Flintwood Front	Veneer Front
3267	4247	5929	6224
3418	4443	6201	6510
3541	4604	6424	6747

OPEN WITH DRAWER (P/J)

SOURCE LAMINATE BACK & CASE		FLINTWOOD BACK & CASE	veneer BACK & CASE
Source Lam. Front	Flintwood Front	Flintwood Front	Veneer Front
2642	3434	4792	5032
2767	3596	5018	5272
2861	3721	5191	5453