

Xpress

UPPC

Perpendicular Credenza for Height-Adjustable Table

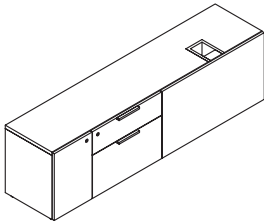

The Perpendicular Credenza for Height-Adjustable Table is installed perpendicular to the panel to allow for parallel planning within the worksurface.

WHAT'S INCLUDED

1 case, box/file drawers with pulls (as specified), lock and keys (if specified), counterweight, leg grommet

File with Hinged Door (H) has an extra kit that contains two 1-1/4" levelers and two 1-3/4" levelers will be shipped with the storage.

WHAT'S EXCLUDED

A Seat Cushion (UWLC) or Fitted Seated Cushion (UWLF) can be ordered separately and can be found in the *Accessories* section.

NOTES

Full Drawer (F) includes extended levelers (UNSLB) already installed.

Hinged door is push latch, no handle required.

48" and 54" Widths are not available if configuration (H) File with Hinged Door is specified.

The following bases can be installed into this credenza:

Navigate Height-Adjustable Built-in Base - Parallel Planning (YHD)

Navigate Height-Adjustable Built-in Gable Base - Parallel Planning (YWD)

hiSpace HA Built-in Base - Perpendicular Planning (YSG)

hiSpace HA Built-in Base - Parallel Planning (YSP)

Xpress

Case, Back & Front Finish Flintwood and Natural Veneer are excluded from *Teknion's Xpress Program*.

PRODUCT OPTIONS

Configuration	Depth	Width	Pull Style	Storage Compartment Location
<b>F</b> Navigate Compatible with Full drawer	16	48, 54, 60, 66, 72	<b>D</b> District <b>R</b> Rectangular	<b>L</b> Left (shown) <b>R</b> Right
<b>H</b> Navigate Compatible with File with Hinged Door				
<b>E</b> hiSpace Compatible with Full drawer				
<b>G</b> hiSpace Compatible with File with Hinged Door				

SAMPLE ORDER CODE

UPPC F	16	60	D	L
--------	----	----	---	---

PRODUCT OPTIONS (CONTINUED)

Pull Finish	Leg Grommet Finish	Case, Back & Front Finish	Key	Slot For Storage Screen
Foundation	Foundation	Source Laminate	<b>K</b> Key Alike <b>R</b> Key Random <b>N</b> No Key	<b>N</b> No <b>Y</b> Yes
Mica	Mica	Flintwood		
		Natural Veneer		

SAMPLE ORDER CODE (CONTINUED)

		Case	Back	Front		
7	7	ZA	ZA	ZA	R	N

See pricing in the following page.

## UPPC

Perpendicular Credenza for  
Height-Adjustable Table  
(Continued)DIMENSIONS  
INCHES / MM

D	W
16 / 406	48 / 1219
16 / 406	54 / 1372
16 / 406	60 / 1524
16 / 406	66 / 1676
16 / 406	72 / 1829

## PRICING

## FULL DRAWER (F/E)

SOURCE LAMINATE CASE		FLINTWOOD CASE	VENEER CASE
Source Lam. Back & Front	Source Lam. Back, Flintwood Front	Flintwood Back & Front	Veneer Back & Front
2149	2794	3897	4095
2270	2953	4125	4330
2588	3364	4697	4929
2710	3522	4917	5162
2815	3656	5103	5360

## FILE WITH HINGED DOOR (H/G)

SOURCE LAMINATE CASE		FLINTWOOD CASE	VENEER CASE
Source Lam. Back & Front	Source Lam. Back, Flintwood Front	Flintwood Back & Front	Veneer Back & Front
2458	3194	4459	4680
2574	3347	4671	4905
2672	3473	4849	5091