

**Xpress**

**UPCC**

## Parallel Corridor Credenza for Height-Adjustable Table

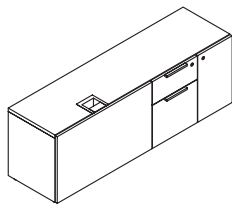

The Parallel Corridor Credenza for Height-Adjustable Table is installed parallel to the corridor to allow for perpendicular planning with the worksurface.

### WHAT'S INCLUDED

1 case, box/file drawers with pulls (as specified), lock and keys (if specified), counterweight, leg grommet.

File with Hinged Door (H) has an extra kit that contains two 1-1/4" levelers and two 1-3/4" levelers will be shipped with the storage.

### WHAT'S EXCLUDED

A Seat Cushion (UWLC) or Fitted Seated Cushion (UWLF) can be ordered separately and can be found in the *Accessories* section.

### NOTES

Full Drawer (F) includes extended levelers (UNSLB) already installed.

Hinged door is push latch, no handle required.

48" and 54" Widths are not available if configuration (H) File with Hinged Door is specified.

The following bases can be installed into this credenza:

Navigate Height-Adjustable Built-in Base - Parallel Planning (YHD)

Navigate Height-Adjustable Built-in Gable Base - Parallel Planning (YWD)

hiSpace HA Built-in Base - Perpendicular Planning (YSG)

hiSpace HA Built-in Base - Parallel Planning (YSP)

**Xpress** Case, Back & Front Finish Flintwood and Natural Veneer are excluded from *Teknion's Xpress Program*.

### PRODUCT OPTIONS

Configuration	Depth	Width	Pull Style	Storage Compartment Location
<b>F</b> Navigate Full Drawer	16	48, 54, 60	<b>D</b> District	<b>L</b> Left
<b>H</b> Navigate File with Hinged Door			<b>R</b> Rectangular	<b>R</b> Right
<b>E</b> hiSpace Quick-Connect Full drawer				
<b>G</b> hiSpace Quick-Connect File with Hinged Door				

### SAMPLE ORDER CODE

<b>UPCC F</b>	<b>16</b>	<b>48</b>	<b>D</b>	<b>L</b>
---------------	-----------	-----------	----------	----------

### PRODUCT OPTIONS (CONTINUED)

Pull Finish	Leg Grommet Finish	Case, Back & Front Finish	Key
Foundation	Foundation	Source Laminate	<b>K</b> Key Alike
Mica	Mica	Flintwood	<b>R</b> Key Random
		Natural Veneer	<b>N</b> None

### SAMPLE ORDER CODE (CONTINUED)

<b>7</b>	<b>7</b>	<b>ZA</b>	<b>ZA</b>	<b>ZA</b>	<b>R</b>
----------	----------	-----------	-----------	-----------	----------

See pricing in the following page.

## U P C C

Parallel Corridor Credenza for  
Height-Adjustable Table(Continued)DIMENSIONS  
INCHES / MM

D	W
16 / 406	48 / 1219
16 / 406	54 / 1372

## PRICING

## FULL DRAWER (F/E)

SOURCE LAMINATE CASE		FLINTWOOD CASE	VENEER CASE
Source Lam. Back & Front	Source Lam. Back, Flintwood Front	Flintwood Back & Front	Veneer Back & Front
2149	2794	3897	4095
2270	2953	4125	4330

## FILE WITH HINGED DOOR (H/G)

SOURCE LAMINATE CASE		FLINTWOOD CASE	VENEER CASE
Source Lam. Back & Front	Source Lam. Back, Flintwood Front	Flintwood Back & Front	Veneer Back & Front
2588	3364	4697	4929