

# storage

**Xpress**

## ULHS

### Low Open with Drawer Credenza – Standard

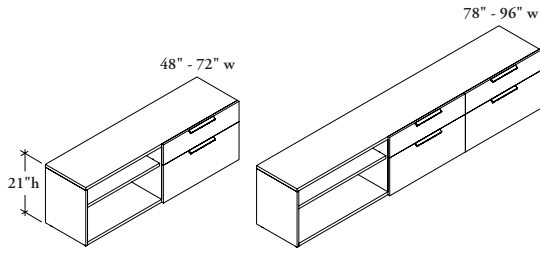

The Standard Low Open Drawer Credenza provides both file storage and open binder storage with the capability to support worksurfaces, stackers and panels.

#### WHAT'S INCLUDED

1 credenza, lock and keys (if specified), counterweight (if specified), 48" - 72" widths include 1 height-adjustable shelf, 1 box/file drawer and 2 pulls; 78" - 96" widths include 1 height-adjustable shelf, 2 box/file drawers and 4 pulls.

Extra kit that contains two 1-1/4" levelers and two 1-3/4" levelers will be shipped with the storage.

#### WHAT'S EXCLUDED

A Seat Cushion (UWLC) or Fitted Seated Cushion (UWLF) can be ordered separately. Can be found in the *Accessories* section.

#### NOTES

**Xpress** Case & Back Finish Flintwood and Natural Veneer are excluded from *Teknion's Xpress Program*.

#### PRODUCT OPTIONS

Depth	Width	Open Compartment Location	Pull Style	Pull Finish	Case, Back & Front Finish	Key Style	Counterweight
16, 19	30, 36, 42, 48, 54, 60, 66, 72, 78, 84, 90, 96	L Left (shown) R Right	D District R Rectangular	Foundation Mica	Source Laminate Flintwood Natural Veneer	K Keyed Alike R Keyed Randomly N No Lock	1 Yes 2 No

#### SAMPLE ORDER CODE

		Case			Back			Front		
<b>ULHS 19</b>	<b>48</b>	<b>R</b>	<b>D</b>	<b>7</b>	<b>ZA</b>	<b>ZA</b>	<b>ZA</b>	<b>R</b>	<b>2</b>	

#### DIMENSIONS INCHES / MM

D	W
16 / 406	30 / 762
16 / 406	36 / 914
16 / 406	42 / 1067
16 / 406	48 / 1219
16 / 406	54 / 1372
16 / 406	60 / 1524
16 / 406	66 / 1676
16 / 406	72 / 1829
16 / 406	78 / 1981
16 / 406	84 / 2134
16 / 406	90 / 2286
16 / 406	96 / 2438
19 / 483	30 / 762
19 / 483	36 / 914
19 / 483	42 / 1067
19 / 483	48 / 1219
19 / 483	54 / 1372
19 / 483	60 / 1524
19 / 483	66 / 1676
19 / 483	72 / 1829
19 / 483	78 / 1981
19 / 483	84 / 2134
19 / 483	90 / 2286
19 / 483	96 / 2438

#### PRICING

##### SOURCE LAMINATE CASE

Source Lam. Back & Front	Source Lam. Back, Flintwood Front
2036	2547
2095	2625
2161	2702
2224	2782
2297	2883
2370	2981
2465	3225
2561	3463
3358	4129
3528	4592
3776	4794
n/a	n/a
2144	2688
2208	2769
2274	2852
2343	2937
2418	3042
2495	3148
2598	3400
2697	3656
3538	4355
3714	4842
3978	5057
n/a	n/a

##### FLINTWOOD CASE

Flintwood Back & Front
3729
3844
3958
4077
4247
4413
4848
5280
6261
7088
7436
7681
3938
4057
4179
4306
4477
4653
5110
5569
6599
7472
7835
8095

##### VENEER CASE

Veneer Back & Front
4106
4231
4355
4487
4670
4852
5332
5809
6885
7797
8180
8447
4334
4463
4594
4732
4927
5117
5624
6127
7259
8220
8623
8903

If Counterweight is specified, add 203

