

# mounted storage & accessories

SHELVES & OVERHEAD STORAGE BASICS . . . . . 190

PLANNING WITH OVERHEAD CABINETS. . . . . 192

PLANNING WITH OVERHEAD UPMOUNT CABINETS . . . . . 193

PLANNING WITH SHELVES . . . . . 194

PLANNING WITH SUSPENSION SHELVES . . . . . 194

STORAGE MAXIMUMS . . . . . 195

INTEGRATING DISTRICT UNIVERSAL STORAGE OVERHEADS . 196

PLANNING WITH DISTRICT OVERHEAD CABINETS ON LEVERAGE 197

INTEGRATING DISTRICT CREDENZAS WITH  
HEIGHT-ADJUSTABLE TABLES . . . . . 199

ACCESSORY & SCREEN BASICS . . . . . 200

PLANNING WITH HANG-ON WHITEBOARD. . . . . 201

PLANNING WITH ACCESSORY RAILS . . . . . 202

## shelves & overhead storage basics

Leverage offers a variety of mounted storage options.

- Mounted storage may be installed in any location along the panel spine when used with panel-mounted worksurfaces with a flush end gable
- Cabinets are available with locks keyed alike to match other storage components or keyed randomly for a dedicated lock
- Overhead cabinets should **not** be hung over glazed elements

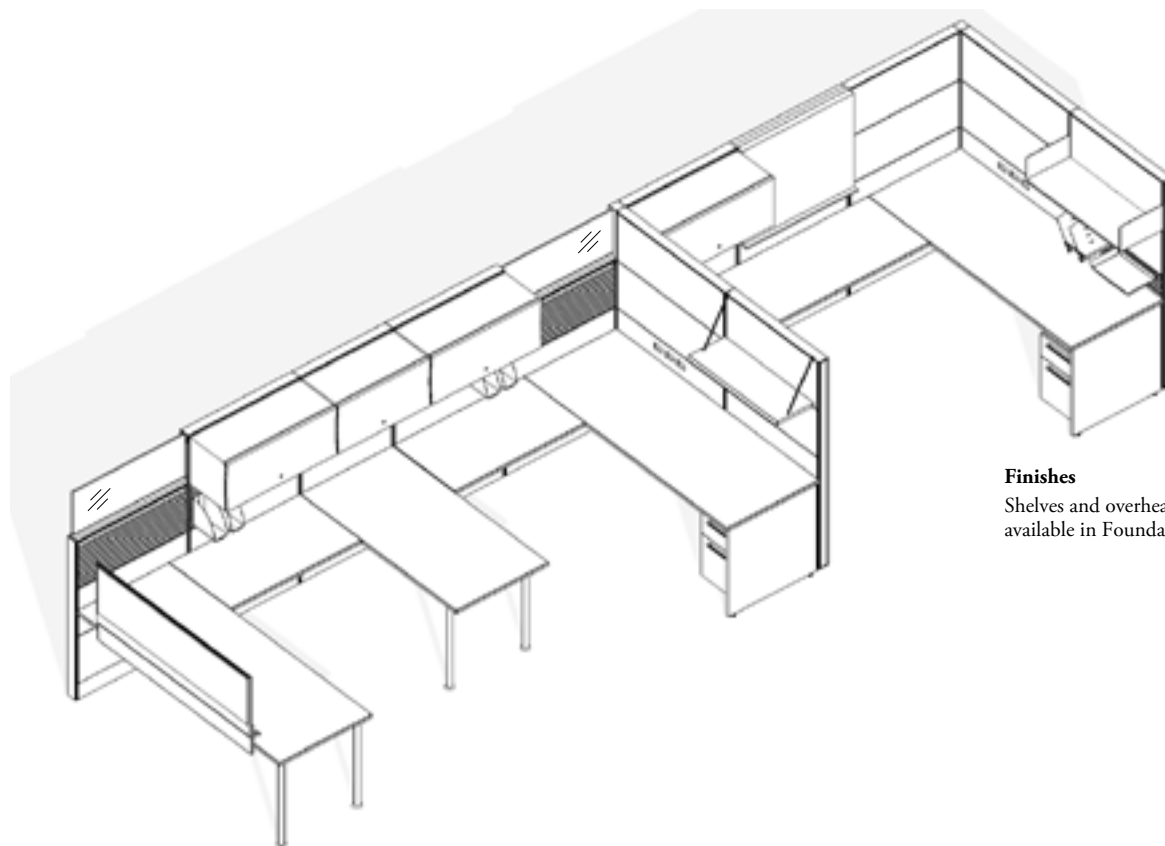

### Finishes

Shelves and overhead components are available in Foundation and Mica colors

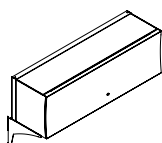

### Overhead Upmount (KSU)

- Is a panel-mounted on-module lockable storage unit for lower height panels with an over the cabinets retractable door
- Can be used in single or double sided applications with lay-in wires
- Can be used with Add-On Screens (KPC) to enhance a 51" height work environment
- On-module mounting brackets can only be applied to panels of the same size
- Door with Motion Control Mechanism will be slow closing
- Accepts Shelf Dividers (BK61)

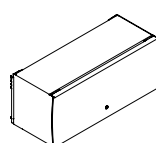

### Overhead Cabinet (KSF)

- Is a panel-mounted, on- or off-module lockable storage unit with an over the cabinet retractable door
- When mounting Overhead Cabinet (KSF) on an Panel Add-On (KPOF and KPOW) that is stacked on a panel with high capacity lay-in channel, special brackets may be required. Contact customer service for more information
- Provides storage for both imperial and metric binders
- On-module cabinet can be mounted at any height, however 51" is recommended for accessibility of storage
- Accepts Shelf Dividers (BK61)
- Door with Motion Control Mechanism will be slow closing same size

## shelves &amp; overhead storage basics (continued)

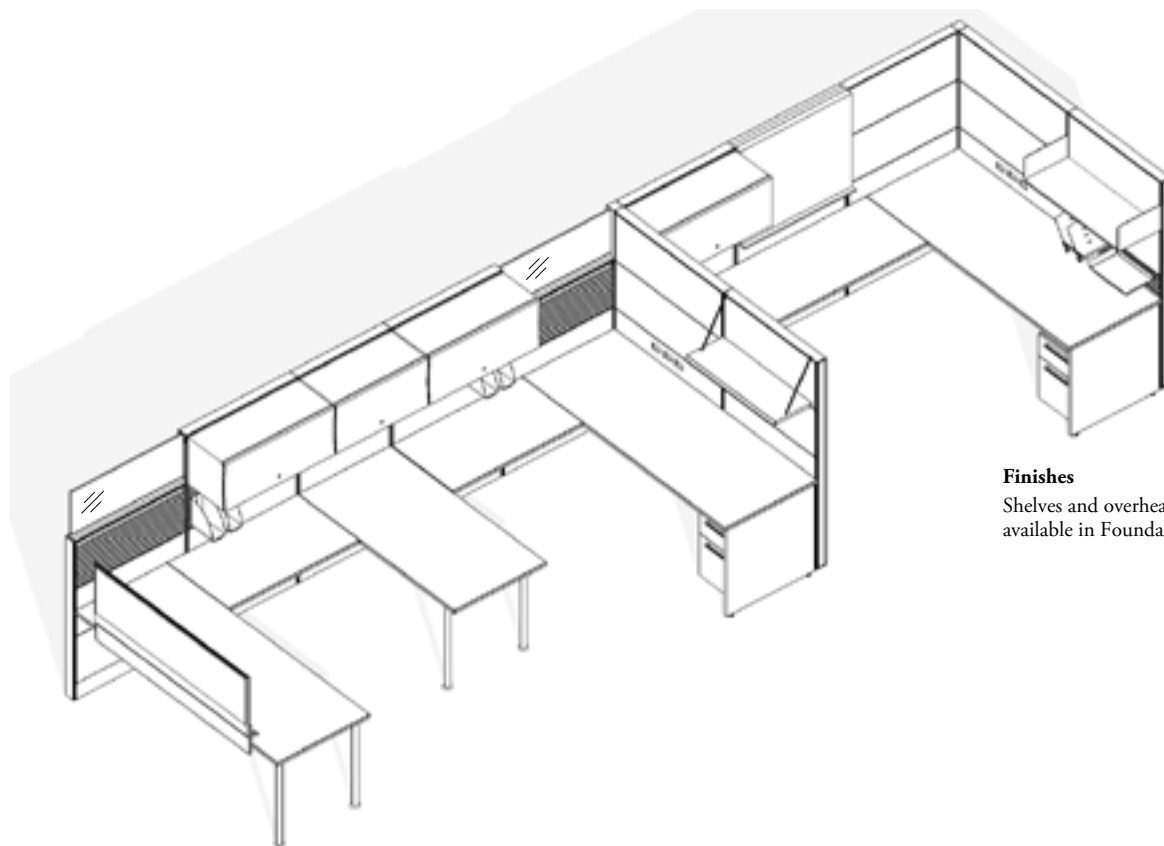
**Finishes**

Shelves and overhead components are available in Foundation and Mica colors

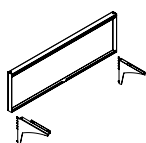
**Overhead Upmount Retrofit Kit (KSR)**

- Allows an existing Leverage Overhead Cabinet (KSF) to be upmounted on-module on a Leverage panel
- On-module mounting brackets can only be applied to panels of the

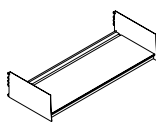
**Shelves (KSS)**

- Provide panel mounted, on-module open storage for both imperial and metric binders
- Can be mounted at any height, however 51" is recommended for accessibility of storage
- Must be applied to same-sized Leverage panels with a Lyft Shelf look
- Can be used with the Panel Add-On (KPOF) and (KPOW)
- Accepts Shelf Dividers (BK61)

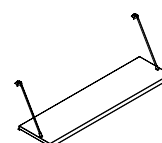
**Suspension Shelf (KSSN)**

- Provides panel-mounted on semi or off-module suspended storage
- Must be applied on same sized or one size larger Leverage Panel
- Light, open aesthetic
- Can be mounted from the top of the panel only
- Can be mounted on Panel Add-On (KPOF and KPOW)
- Width 24"-48" nominal size, but actual width is 2" shorter

## planning with overhead cabinets

The following should be considered when planning with Overhead Cabinets.

Overhead Cabinet (KSF) can be mounted to the panel on- or off-module.

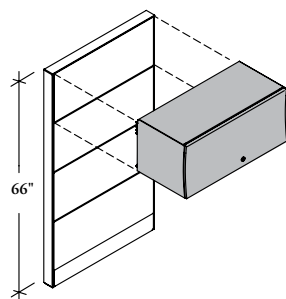

The width of the On-Module Overhead Cabinet (KSF, KSU) must be equal to the width of the panel from which it is suspended

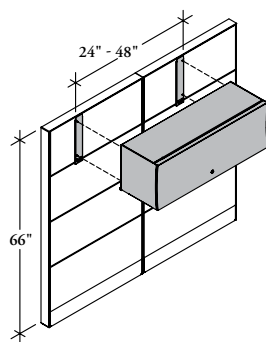

- The Off-Module cabinet requires a rail above and below the cabinet, if a Segmented Panel (KPUC) or Semi-Segmented Panel (KPUS) are **not** specified an additional Panel Rail (KPL) and two 15" elements must be ordered and field installed to support off-module mounting of overheads because they mount into the rail between the elements
- **Cannot** be mounted at a panel-to-panel connector
- Off-module mounting option is available for overhead cabinets with widths from 24" to 48"

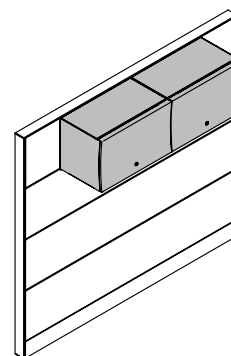

- Two off-module cabinets **cannot** be hung on the same panel unless the combined width is less than that of the panel

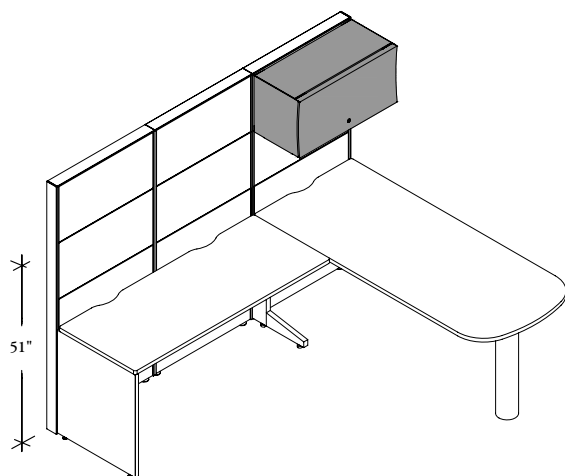

- The Leverage On-Module Overhead Cabinet (KSF\_1) can be mounted at any height but for accessibility of storage above the worksurface, a mounting height of 51" above finished floor is recommended

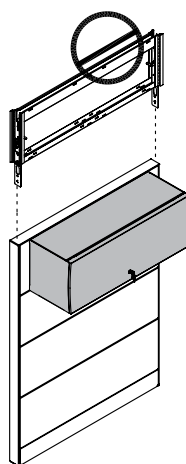

- Add-on panels **cannot** be added to panels with an off-module overhead cabinet
- When mounting an overhead on a Panel Add-On (KPOF and KPOW) that is stacked on a panel with high capacity lay-in channel, special brackets may be required. Contact your Teknion Customer Service Representative

# planning with overhead upmount cabinets

The following should be considered when planning with Upmount Cabinets.

In either single- or double-sided applications, Overhead Upmount Cabinets still permit lay-in wires to be accessed and pass by unobstructed.

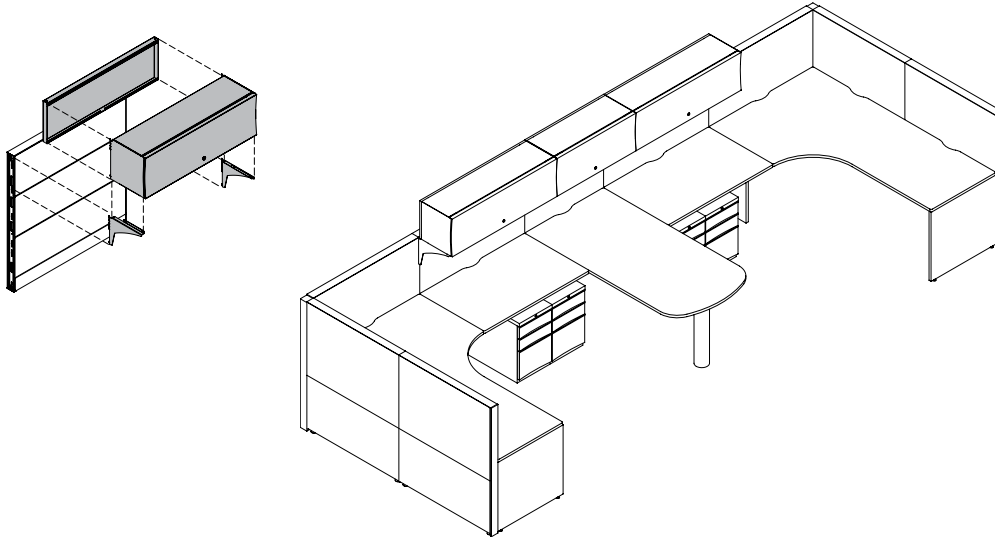

- Retrofit kits are available to convert an Overhead to an Upmount Overhead Cabinet
- Kits include two upmount brackets and a back cover

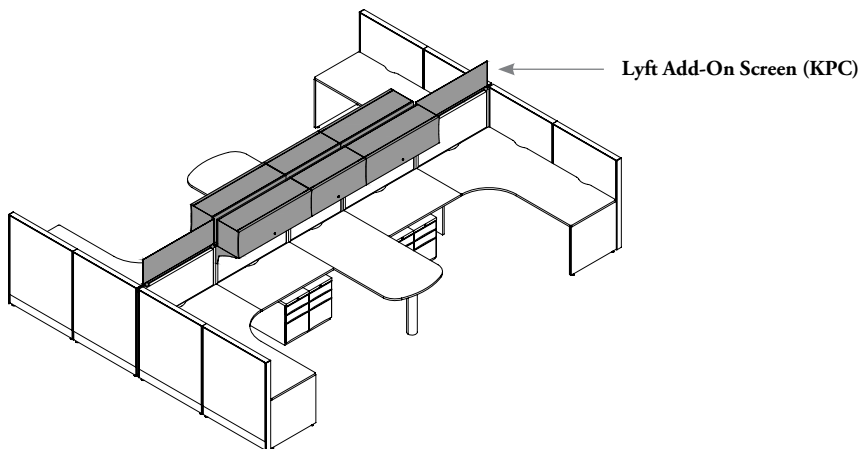

- When used with **Lyft Add-On Screens (KPC)** the functionality of a 51" height work environment can be enhanced

## planning with shelves

The following should be considered when planning with Shelves (KSS).

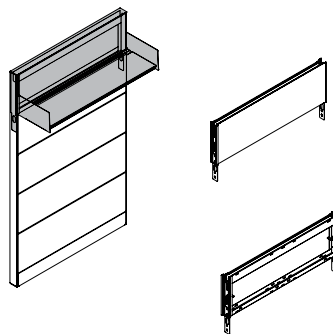
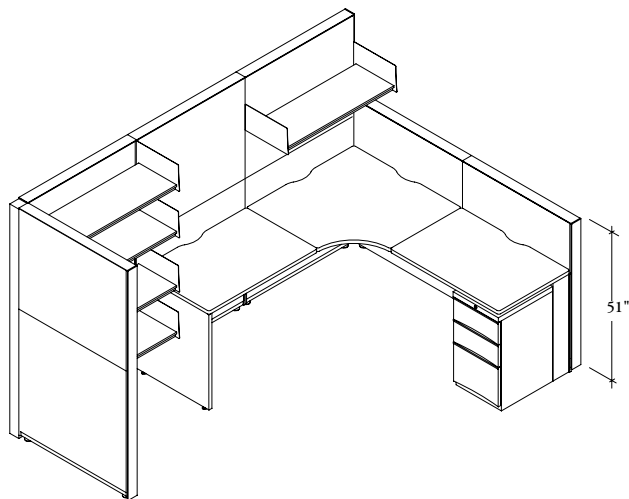

- Can be mounted at any height however, for accessibility of storage above the worksurface, a mounting height of 51" above finished floor is recommended

- The Panel Add-On (KPOF) can be used with the Shelf (KSS)
- All Leverage shelves must be mounted to the panel on-module
- The width of the shelf **must** be equal to the width of the panel from which it is suspended

## planning with suspension shelves

The following should be considered when planning with Suspension Shelves (KSSN).

Shelves can be mounted on-module and off-module.

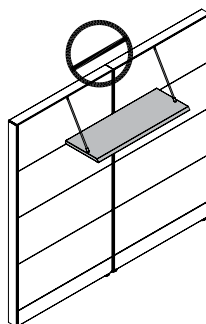
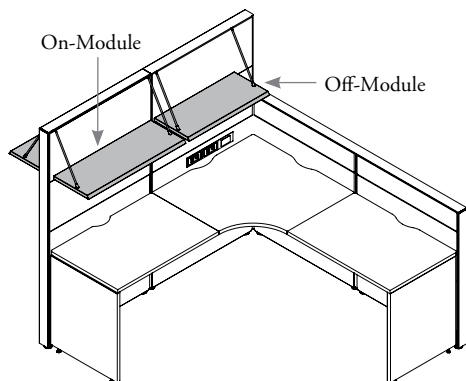

- The shelf always suspends from the panel
- The height is always 15" below the top

- The Suspension Shelf **cannot** be mounted off-module across two panels

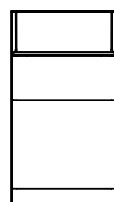

- When mounted on-module can be on 30" high element
- Only one shelf can be mounted per panel

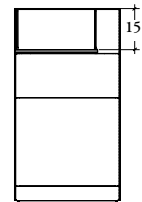

- When the shelf is mounted off-module it must be mounted into a segmented element for support in corner
- Shelves can be the same width or less than the panel that it is mounting onto

## storage maximums

Leverage Panels are able to suspend a multitude of storage products for increased efficiency of the work space. The illustrations below demonstrate the functionality of Leverage mounted storage products.

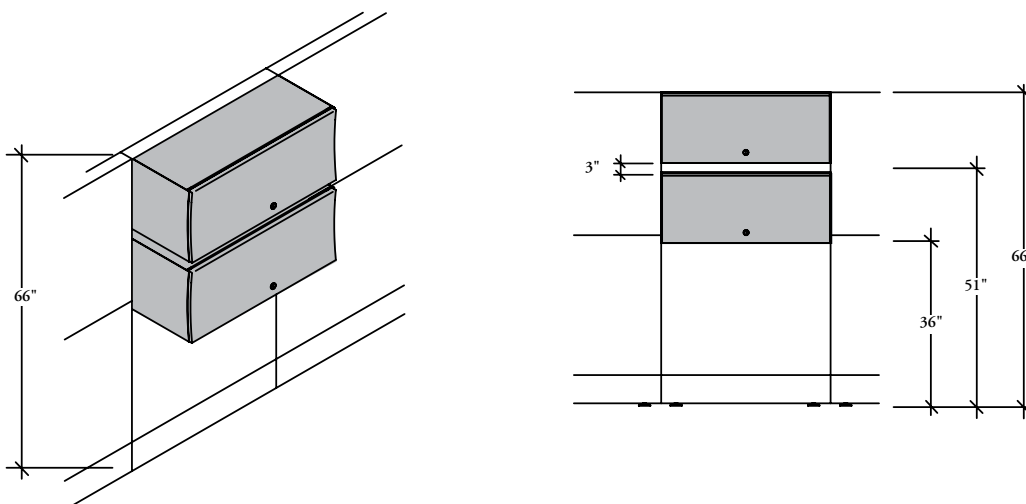

- An Overhead Cabinet (KSF) and Shelf (KSS) provide storage and can be mounted above each other
- Overhead Cabinets (KSF) are mounted to the panel to provide storage for documents including both imperial and metric binders
- The Leverage On-Module Overhead Cabinet (KSF\_1) can be mounted at any height
- For accessibility of storage above the worksurface, a mounting height of 51" above finished floor is recommended

# integrating district universal storage overheads

District Storage can be integrated with Leverage Panels. The following should be considered when blending the two products.

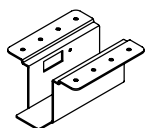
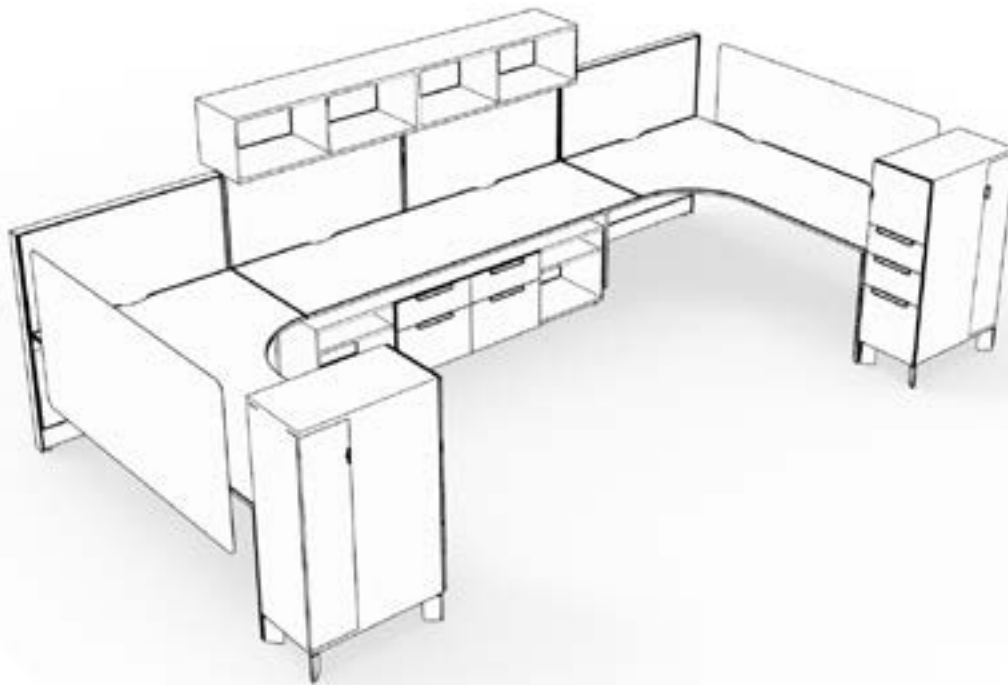

### Centermount Storage Bracket (KUOHC)

- Attaches District Centermount Overhead Cabinet to Leverage Panels
- Mounts to the top trim and to the base of the centermount cabinet
- 1 Kit contains 2 brackets:
  - 24"-42" wide overheads = 1 kit (2 brackets)
  - 48"-96" wide overheads = 2 kits (2 x 2 brackets)



# planning with district overhead cabinets on leverage

## centermount cabinets

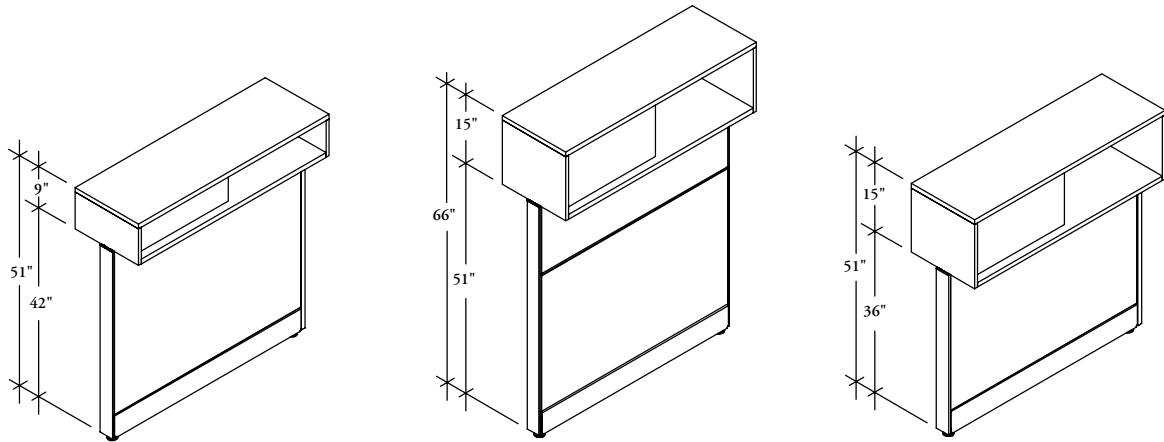

- Centermount cabinets are available 9" and 15" high, so that when they are mounted to Leverage Panels, they match standard Teknion datum heights

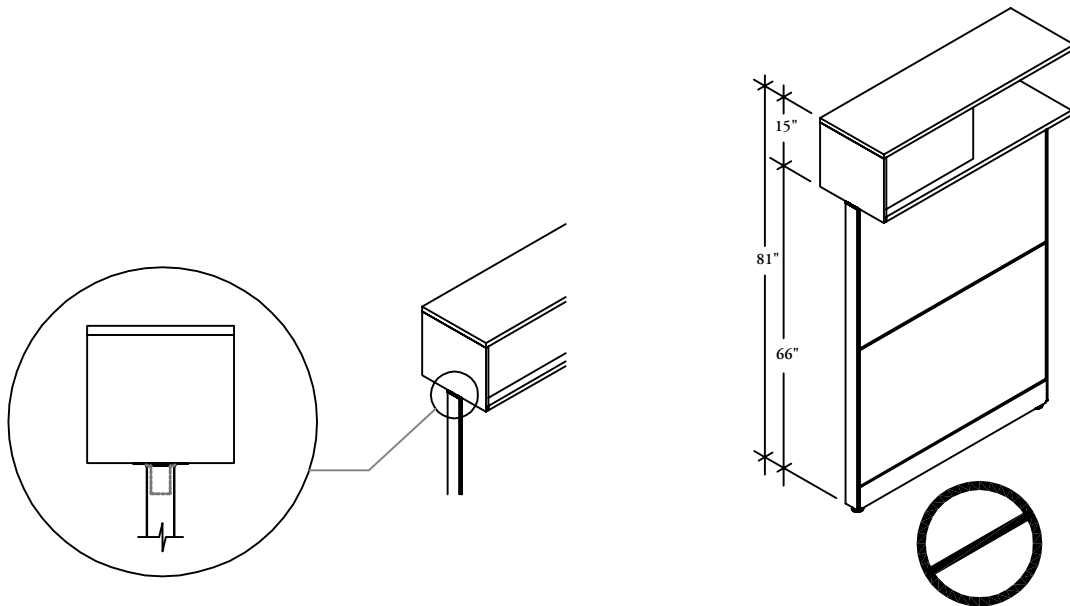

- Centermount cabinets **cannot** mount onto 30" high panels, because the mounting bracket which mounts to the top trim will **not** fit onto this height due to the construction of the panel
- They also **cannot** mount to 42" high panels
- The maximum height for a centermount cabinet is 66" high
- Cabinets **cannot** be mounted above a 66" high panel to reach a datum height of 81"

## planning with district overhead cabinets on leverage (continued)

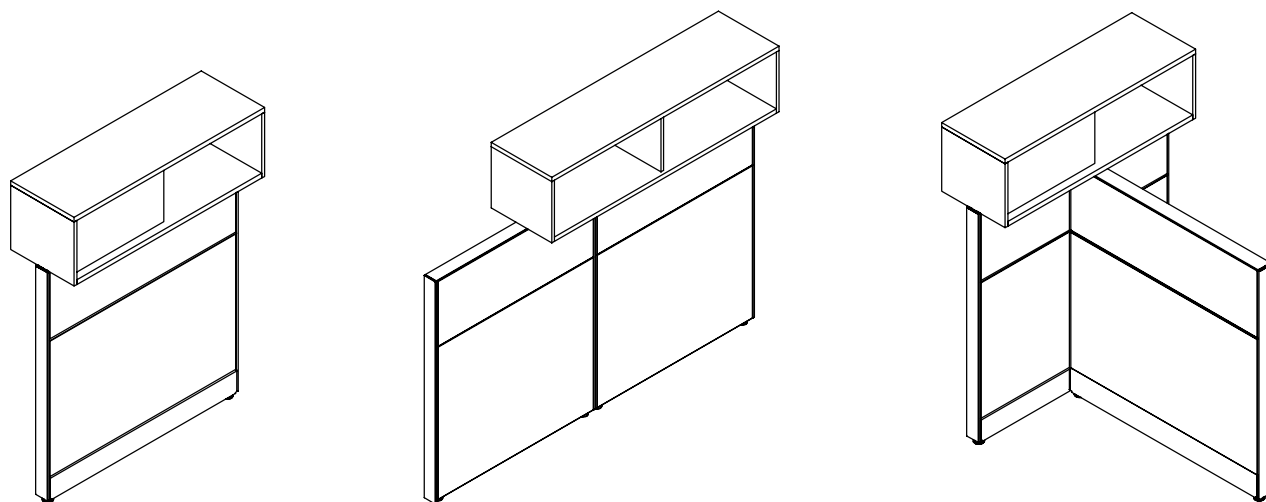

- Centermount overheads can be mounted at Two-Way, Three-Way and Four-Way Connections
- Can be mounted on- or off-module. Off-module mount is limited to Panels with Lay-in Channels. When mounted off-module one end of the Centermount overhead needs affix with one end of the panel
- 120° connections are **not** possible

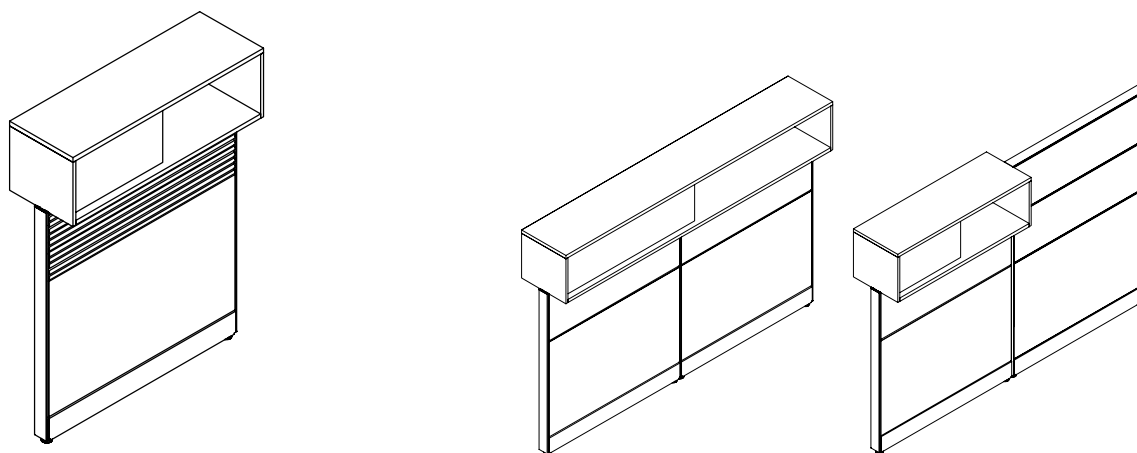

- Centermount overheads can mount over Fabric, Metal, Wood, and Accessory Rail Elements, but **not** over Glass Elements
- A single centermounted overhead can span over two smaller panels and can be on a panel run with panels at different heights
- The Intermediate Trim will **not** fit, so must be left off

# integrating district credenzas with height-adjustable tables

District Credenzas for Height-Adjustable Tables can be integrated with Leverage Panels. The following should be considered when blending the two products.

## credenzas for height adjustable tables and storage to panel brackets

- All District Credenzas for Height Adjustable Tables attach to Leverage panels with either parallel, perpendicular front or perpendicular back brackets

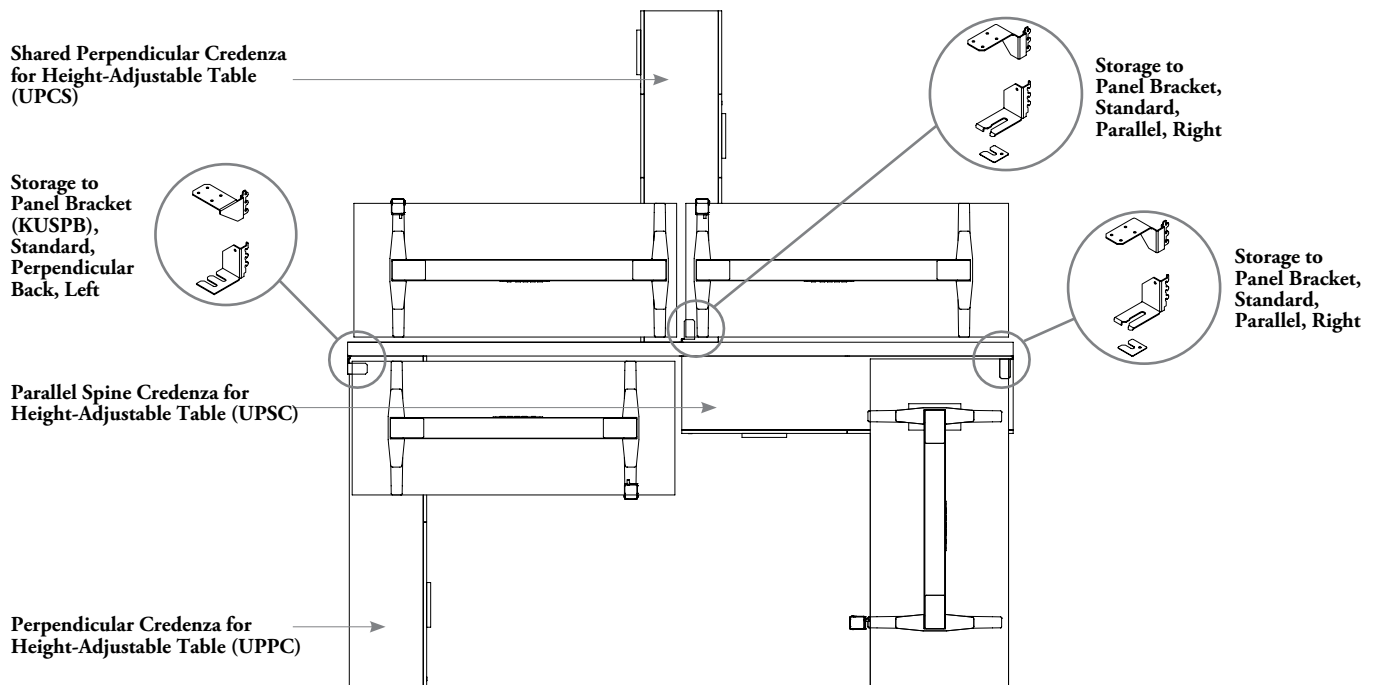

For more information, see *planning with storage-to-panel brackets for district storage integration*.

## credenzas for height adjustable tables and electrics

- The following should be considered when planning electrical with District credenzas for height adjustable tables
- Parallel and perpendicular credenza planning will affect the location of a cut out for power access

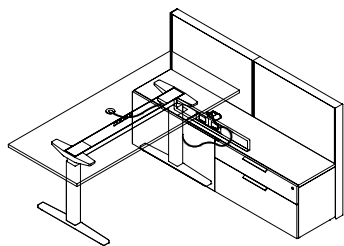

- Parallel Spine Credenzas for Height-Adjustable Tables (UPSC) are the only credenzas for height-adjustable tables that can be specified with a cut out in the back

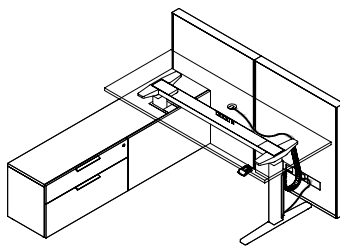

- Perpendicular Credenzas for Height-Adjustable Tables (UPPC) do not have the option for specifying a cut out
- Wire will be routed through the grommet to Vertical Wire Carrier (YEEE) which must be specified separately
- Vertical Wire Carrier (YEEE) will mount to the leg that is not in the credenza

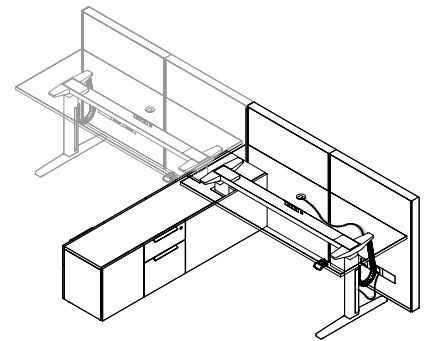

- Shared Perpendicular Credenzas for Height-Adjustable Tables (UPCS) do not have the option of specifying a cut out
- Wires will be routed through the grommet to the Vertical Wire Carrier and then directly to the power box in the panel

## accessory & screen basics

Leverage offers a variety of accessories that can be hung on-module inside or outside a workstation to facilitate organization of the workstation.

### Finishes

Above accessories are available in Foundation, Accent and Mica colors with the exception of the whiteboard frame which is Black

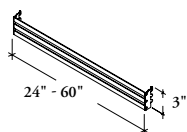
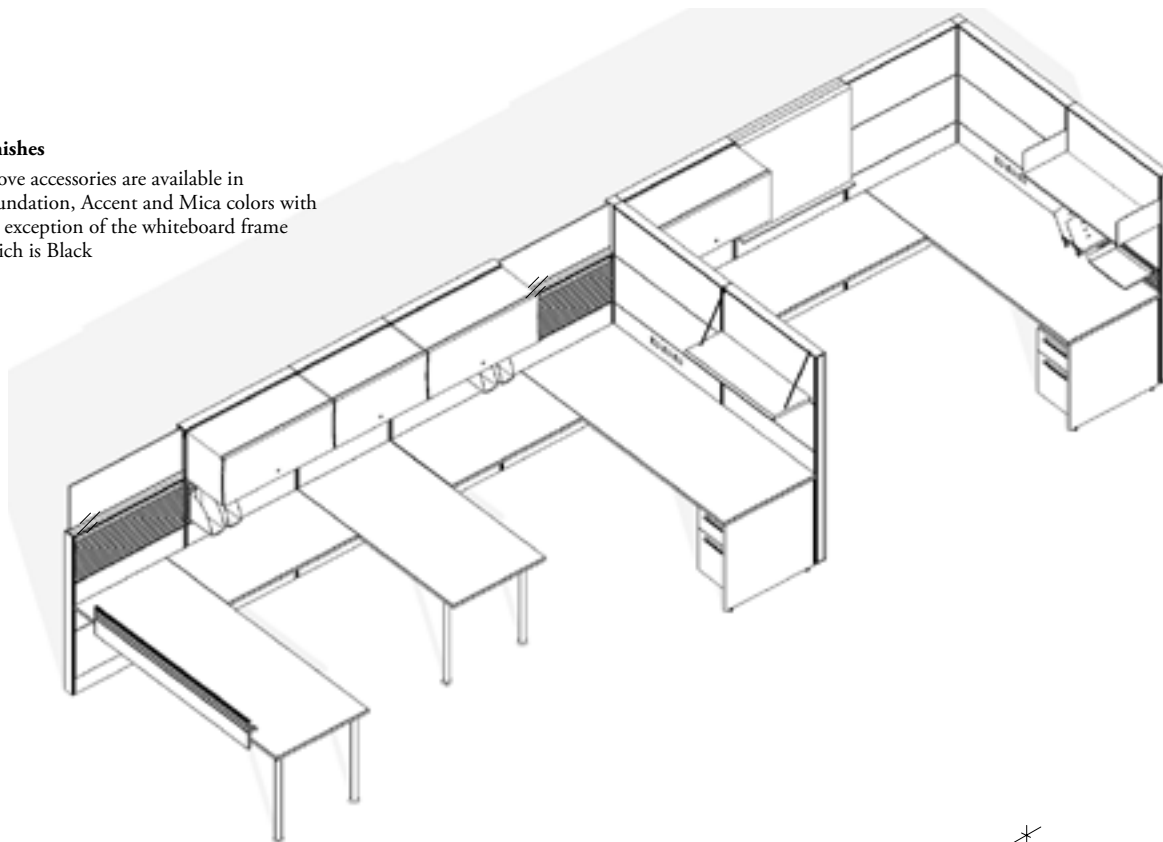

Accessory Rail (KMA)

- Supports Personal Organizers (PAX)
- Can only be attached on-module into the hingeway on a fabric covered element
- Must match the width of the panel
- Two rails are required for binder bins (PAX95). Up to three accessory rails can be attached over a single 15" or 30" high fabric element
- If the rail is supporting the Binder Bin (PAX), Vertical Organizer, Letter/A4 (PAX99) or Legal (PAX100), it should be mounted at a height sufficient to provide clearance between the Vertical Organizer (PAX99/PAX100) and the worksurface
- **Cannot** be attached at the same level when coming together in a corner situation
- Along with lighting wire, management clips **cannot** be attached in the same hingeway

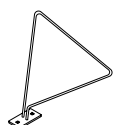

Shelf Divider (BK61)

- Separates books, paper, binders and other items on the Overhead Cabinet (KSF) or Shelf (KSS)
- Slips into the rail at the back of the overhead cabinet (KSF) or shelf (KSS) and can be positioned anywhere along its length

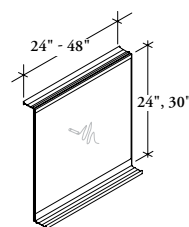

Hang-On Whiteboard (KMW)

- Is reversible erasable message board with a marker tray
- Mounts on-or off-module to the top of any panel
- **Cannot** be applied to a panel where an Overhead Cabinet (KSF) is located on the opposite side of the panel

## planning with hang-on whiteboard

The following should be considered when planning with the Hang-On Whiteboard (KMW).

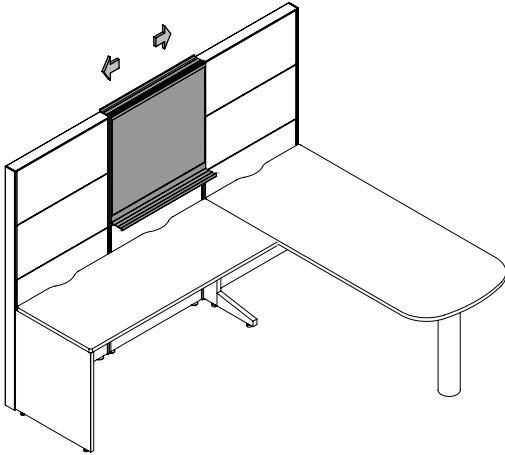

- Can be mounted on- or off-module
- Portable so allows for it to be moved around the work space

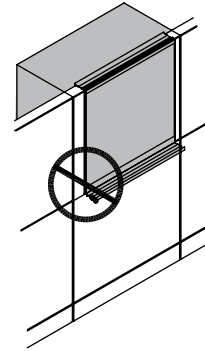

- **Cannot** be applied to a panel where an Overhead Cabinet (KSF) is located on the opposite side of the panel

## planning with accessory rails

The following should be considered when planning with the Accessory Rail (KMA).

A maximum of three Accessory Rails can be attached over a single 15" or 30" high Fabric Element (KES)

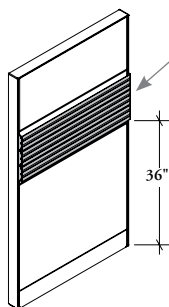

- Must be used on-module
- Width must match the width of the panel

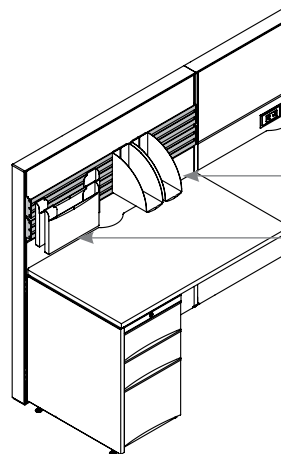

- When the Accessory Rail supports Binder Bins (PAX95) and Vertical Organizers (PAX99/PAX100), two Accessory Rails are necessary to provide adequate support

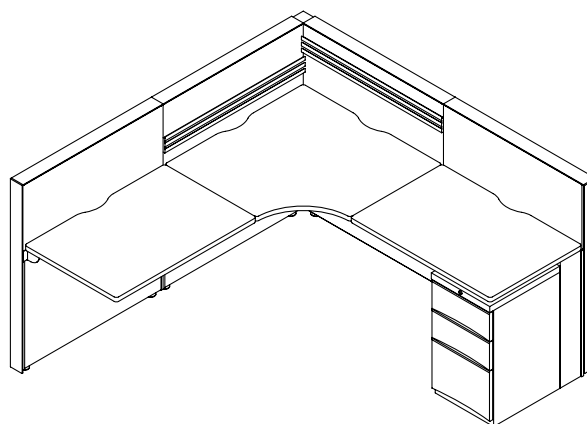
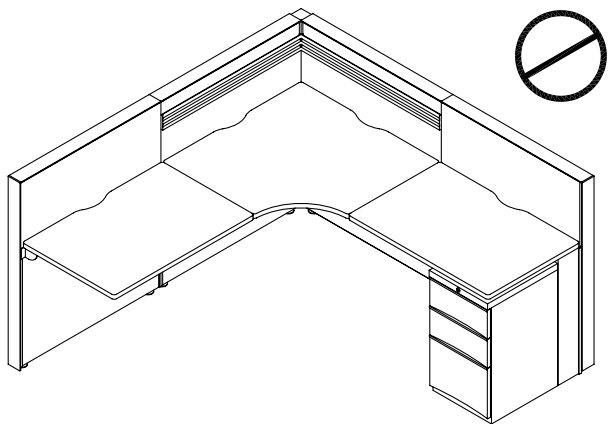

- Accessory Rail **cannot** be used at the same level where two panels meet at a 90° corner, however, it can be used in a corner situation when the mounting heights are offset