

# storage for secondary desks

STORAGE FOR SECONDARY DESK BASICS . . . . .	442
FILING DRAWER CAPACITIES – LATERAL FILE FOR SECONDARY DESK – CENTER POSITION . . . . .	450
FILING DRAWER CAPACITIES – LATERAL FILE FOR SECONDARY DESK – END POSITION – 1 3/16" WORKSURFACE THICKNESS. . . . .	451
FILING DRAWER CAPACITIES – LATERAL FILE FOR SECONDARY DESK – END POSITION – 1 9/16" WORKSURFACE THICKNESS. . . . .	452
PLANNING WITH STORAGE FOR SECONDARY DESKS . . . . .	453
PRODUCT OFFERING – STORAGE FOR SECONDARY DESKS. . . . .	454
LOCK CHART – STORAGE FOR SECONDARY DESKS . . . . .	456
INTERIOR CLEARANCE – STORAGE FOR SECONDARY DESKS . . . . .	457
STORAGE FOR SECONDARY DESKS FINISHES. . . . .	458
GRAIN DIRECTION – STORAGE FOR SECONDARY DESKS . . . . .	459

## storage for secondary desk basics

**Expansion Casegoods offers storage options for Secondary Desk Applications. The storage attaches under a secondary desk and provides additional storage and stability to the workstation.**

All dimensions in this section are nominal

- ❗ Must be mounted under a 20" or 24" deep Low or High Secondary Desk (B\_MSD, BH\_SR, BH\_SB or BH\_SL) only
- Can be specified Center (C) or End (M or X) position – worksurface thicknesses as secondary desks
- The end position must be specified next to a secondary desk gable in order compensate its thickness creepage
- All storage products include levelers with a minimum adjustment range of 1"

### Depth Storage for Secondary Desk

Depth varies when specified in-front or not in-front of Height-Adjustable Mechanism:

#### In Front of Height-Adjustable Mechanism (No):

- 20" or 24" Secondary Desk depth = 18" storage depth

#### In Front of Height-Adjustable Mechanism (Yes) (Shown):

- 20" Secondary Desk depth = 12" storage depth
- 24" Secondary Desk depth = 16" storage depth

The storage depth is smaller to clear the Height-Adjustable Mechanism

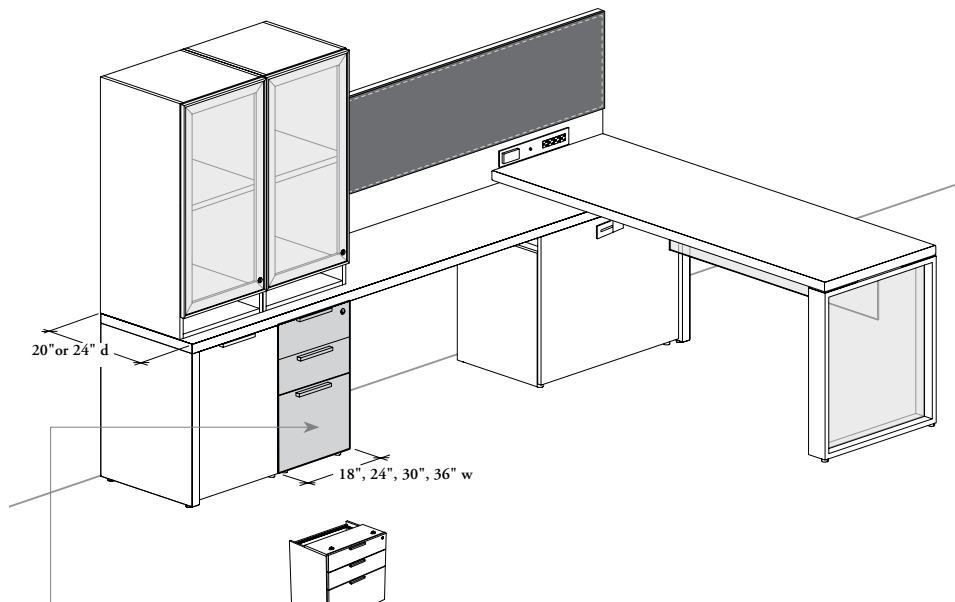

### Stretch Pedestal – Secondary Desk (BSSP)

- Provides closed storage under a High (H) Secondary Desk
- For an ergonomic and accessibility reasons, it is **not** recommended to use this storage under a worksurface perpendicular to a high secondary desk
- **Cannot** be specified in front of Height-Adjustable Mechanism (N)
- Has a central locking system and full extension drawers that can accommodate both letter- and legal-size paper
- Box drawer include an anodized pencil tray with mounting brackets. File drawer includes one or two 15" plastic cross file bar(s)

### Pull Styles

- Interchangeable within the same group:
  - Modern Straight (ADA) (M) and
  - Slim (S)
- Five pull styles are available:

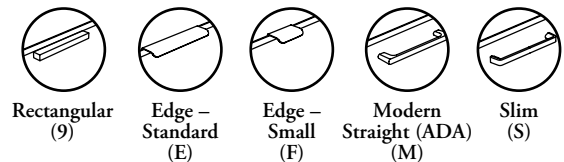

### Supporting Brackets

- Two supporting brackets are provided with all storage for secondary desk
- Mount to the underside of a secondary desk and to the top of a storage for secondary desk to provide additional support to secondary desk
- The supporting brackets are finished in Recycled Paint



## storage for secondary desk basics (continued)

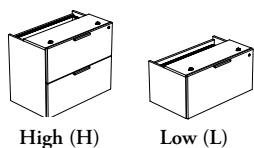
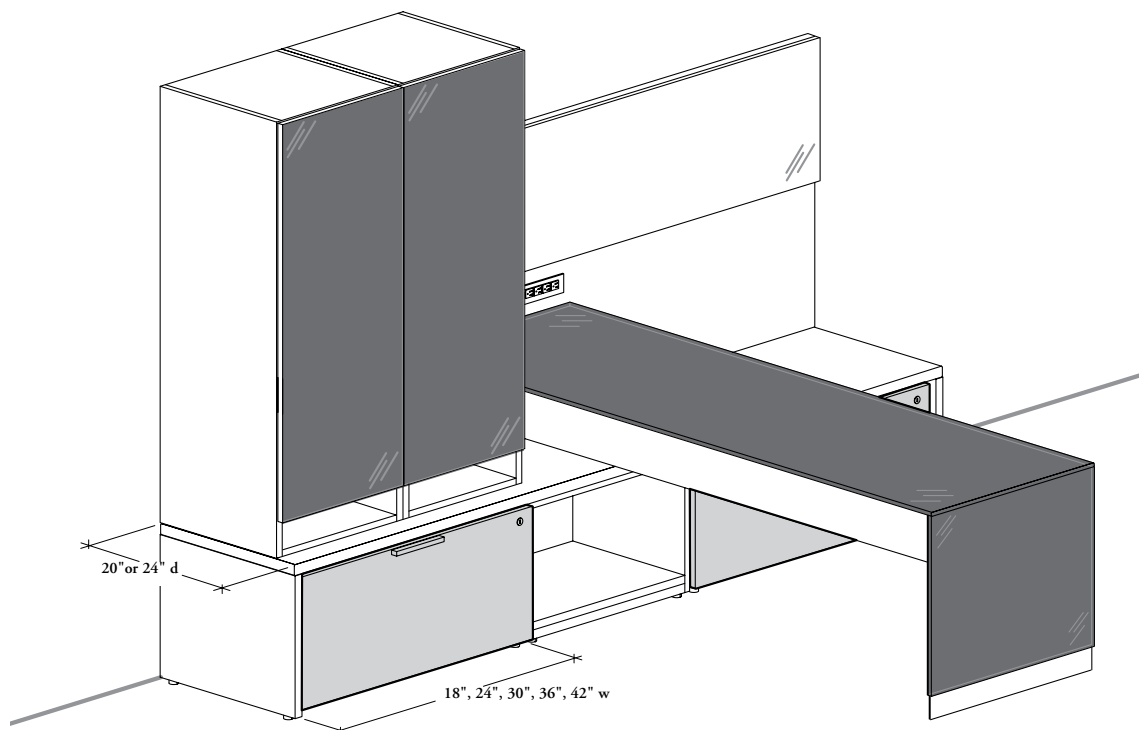

High (H)

Low (L)

**Lateral File – Secondary Desk (BSSL)**

- Provides closed storage under a **High (H) or Low (L)** Secondary Desk
- Must be specified the same height than the secondary desk
- For a ergonomic and accessibility reasons, it is **not** recommended to used this storage under a worksurface perpendicular to a high or low secondary desk
- **Cannot** be specified in front of Height-Adjustable Mechanism (N)
- When a 30" wide Lateral File for Secondary Desk – End Position (M or X) is specified, it **cannot** accommodate side-to-side filing
- When a 42" wide Lateral File for Secondary Desk is specified, only End Position (M or X) is available and the file drawer width will be reduced by 6"
- Provides full extension slides that can accommodate both letter- and legal-size paper
- Equipped with an interlock system that prevents opening more than one drawer at a time (high version only)
- File drawer includes one or two 15" plastic cross file bar(s)

## storage for secondary desk basics (continued)

⚠ Storage for Secondary Desk is mandatory in front a Height-Adjustable Mechanism (Y), if a Open Section Cover (BSSCM) is not specified

### Bookcase – Secondary Desks (BSSO)

- Provides open storage under a **High (H)** or **Low (L)** Secondary Desk
- Must be specified the same height than the secondary desk
- Can be used as a passive storage under a worksurface perpendicular to a low or high secondary desk
- Can be specified under a Run-Off, Run-Off with Glass Top, Overlapping Bridge, Height-Adjustable Worksurface or a return. When specified, the storage allows to hide the Height-Adjustable Mechanism
- Two height styles are available:

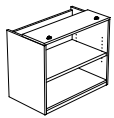

#### High (H)

- Must be specified under **High (H)** Secondary Desk only
- Comes with one adjustable shelf
- Adjustable shelf configurations has five holes in 1 1/4" intervals on the inside walls for shelf height adjustment
- The high version will **not** allow two rows of standard letter-size binders
- Additional shelves **cannot** be specified separately

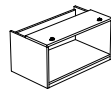

#### Low (L)

- Must be specified under **Low (L)** Secondary Desk only
- Comes with one open compartment

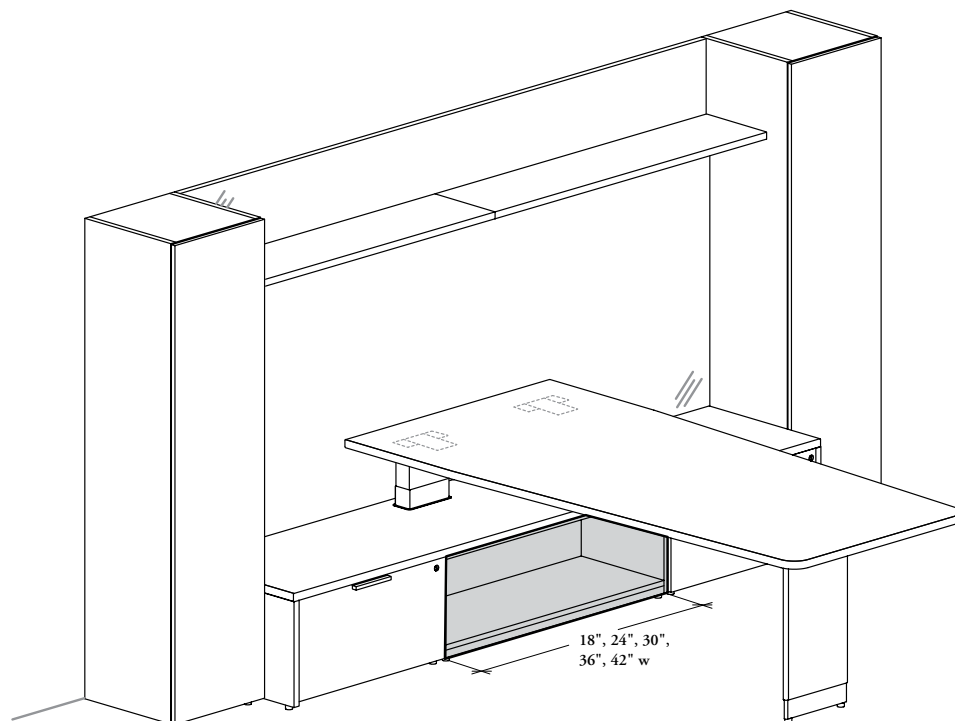

## storage for secondary desk basics (continued)

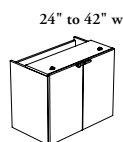
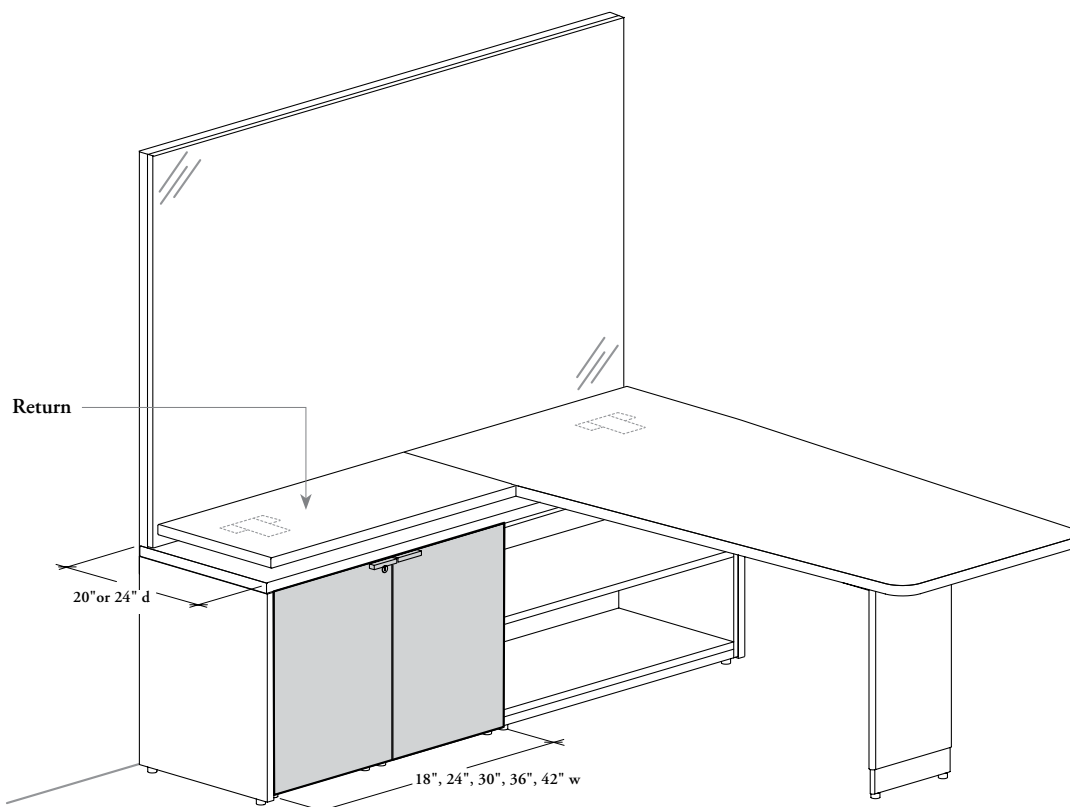

### Storage Cabinet – Secondary Desk (BSSD)

- Provides closed storage under a **High (H)** Secondary Desk only
- Can be used as a passive storage under a worksurface perpendicular to a high secondary desk
- Can be specified under a Run-Off, Run-Off with Glass Top, Overlapping Bridge or Height-Adjustable Worksurface. When specified, the storage allows to hide the Height-Adjustable Mechanism
- For an ergonomic and accessibility reasons, it is **not** recommended to use this storage under a worksurface perpendicular to a high secondary desk
- Hinges allow the door to open up to 120°
- Comes with one adjustable shelf
- Additional shelves **cannot** be specified separately
- Adjustable shelf configurations have five holes in 1 1/4" intervals on the inside walls for shelf height adjustment
- This product will **not** allow storing two rows of standard letter-size binders
- 24" to 42" wide cabinets come with two doors. Only **Not Applicable (N)** Door Swing Direction is available
- Only 18" wide cabinet comes with one door. Left (Shown) or Right swing direction must be specified

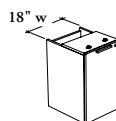

## storage for secondary desk basics (continued)

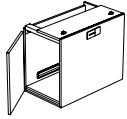

### Multi-Functional Storage – Secondary Desk (BSSM)

- Provides closed storage under a High (H) Secondary Desk only. It can be used to hide a personal computer tower or a recycling bin
- Must be used as a passive storage under a worksurface perpendicular to a high secondary desk
- Can be specified under a Run-Off, Run-Off with Glass Top, Overlapping Bridge or Height-Adjustable Worksurface. When specified, the storage allows to hide the Height-Adjustable Mechanism
- Comes with one rectangular grommet on the front and one ventilation slot with ring on the back
- Can be specified left or right and needs 24" of nominal clear space to allow full door opening
- Hinged doors have no pull and no touch latch. They can be handled with the fingertips
- Shorter door acts as a paper slot
- Hinges allow the door to open up to 120°
- A single Multi-Functional Drawer will **not** disable the opening of the door but will block the paper slot

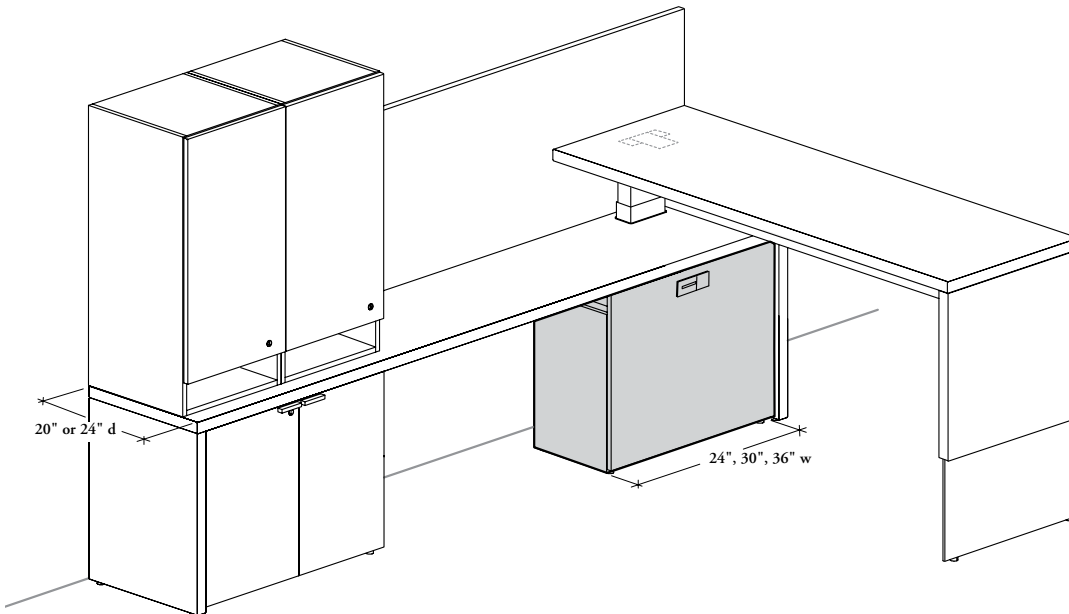

# storage for secondary desk basics (continued)

## Recycling/Waste Cabinet – Secondary Desk (BSSRW)

- Provides closed recycling and/or waste bin storage under a **High (H)** or **Low (L)** Secondary Desk
- For an ergonomic and accessibility reasons, it is **not** recommended to use this storage under a worksurface perpendicular to a high or low secondary desk
- Can be specified in front of Height-Adjustable Mechanism of height-adjustable return
- Comes with one flip-down door.
- Door have a pull and is **not** lockable

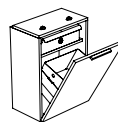

### High (H)

- Must be specified under **High (H)** Secondary Desk only
- Comes with one Recycling Bin, one Waste Bin and one Fixed Shelf

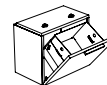

### Low (L)

- Must be specified under **Low (L)** Secondary Desk only
- Comes with one Waste Bin only

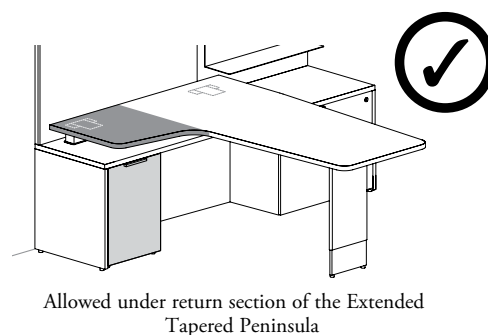
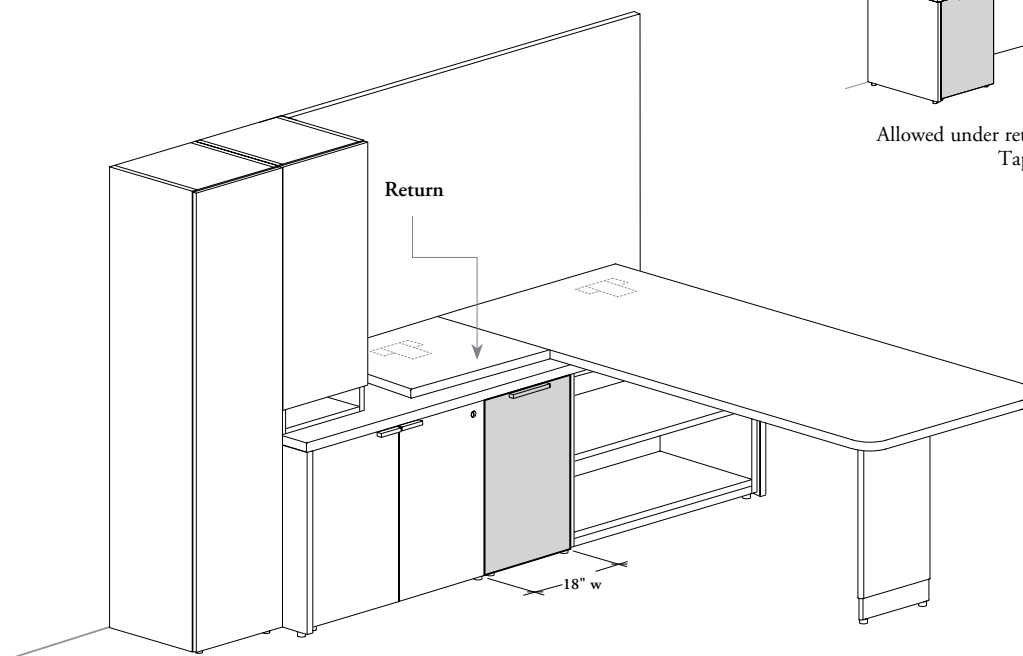

## Opening Door Configurations

- With high configuration, the hinges allow the door to open up to 30°
- With low configuration, the hinges allow the door to open up to 40°

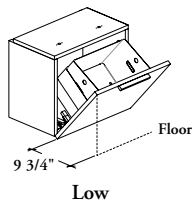
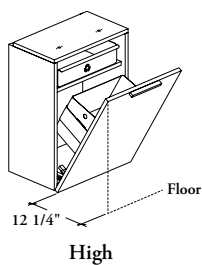

## Recycling and Waste Bins Anatomy

Waste bin require a 20" wide x 12" hide bag (13 Liter Capacity) for a true fit. Waste bin include side detail to manage the excess of bag is used

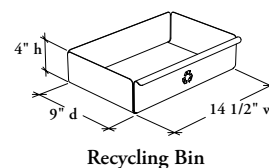
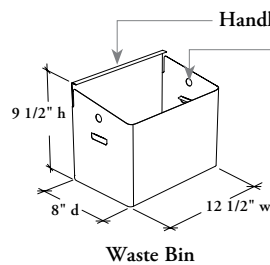

## storage for secondary desk basics (continued)

- ❗ • Open Section Cover – Secondary Desk is mandatory under a Height-Adjustable Worksurfaces, if a Storage for Secondary Desk (BSSO, BSSM, BSSD or BSSRW) is **not** specified
- Can be specified High (H) or Low (L) under Secondary Desk for Height-Adjustable Worksurfaces (BH\_SR, BH\_SB or BH\_SL) only
- Width Reduction (M or X) must be specified for End – Off-Module (E) and Full Secondary Desk Width Position (F) in order to compensate the secondary desk gable(s) thickness creepage
- When Center Position (C) is specified, only None (N) Width Reduction is available
- Can be installed under the secondary desk alone or combined with other Storage for Secondary Desk

### Open Section Cover – Secondary Desk (BSSCM)

- Can be used under a Secondary Desk to provide a continuous aesthetic
- Can hide the height-adjustable mechanism and provides a finishing element under a Secondary Desk
- 1" thick laminate panel

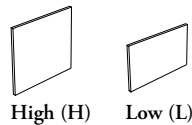

### end – off-module configuration (E)

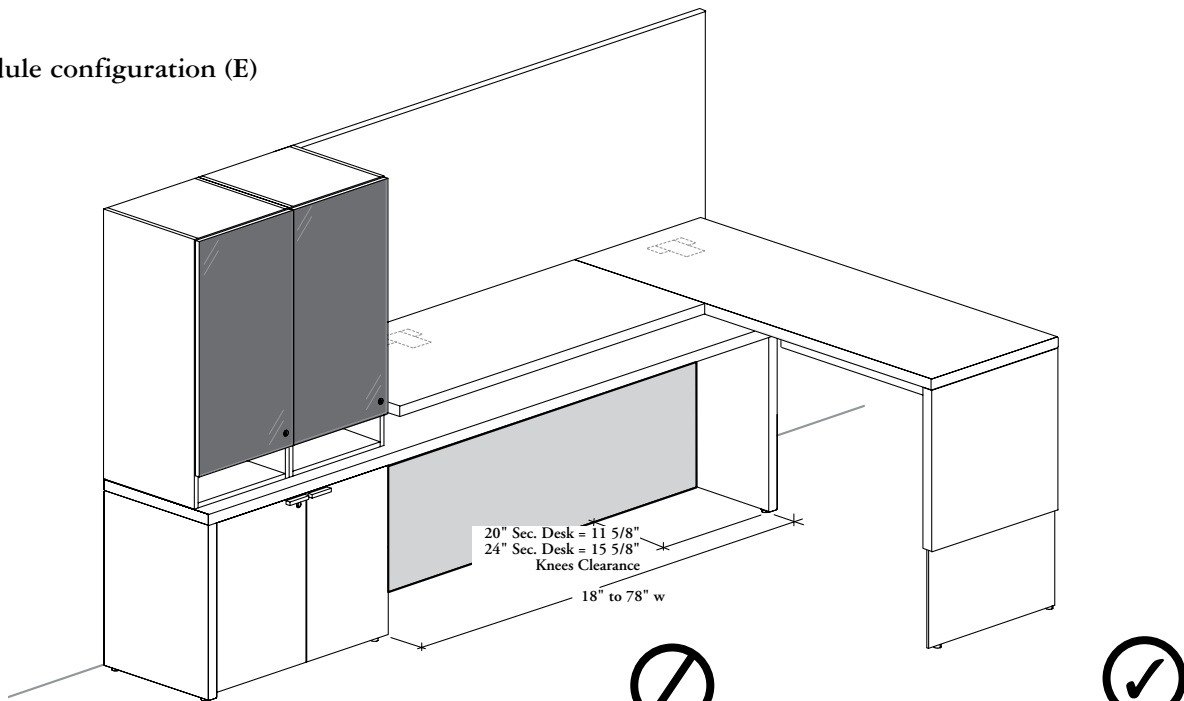

### Restrictions

- A minimum 6" wide clearance must be preserved to allow the opening door of a Multi-Functional Storage – Secondary Desk (BSSM)
- For more details on Storage for Desk Applications, refer to page 453

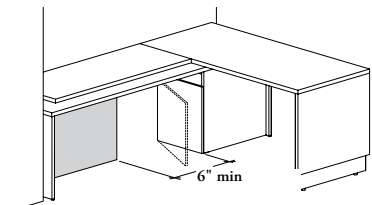
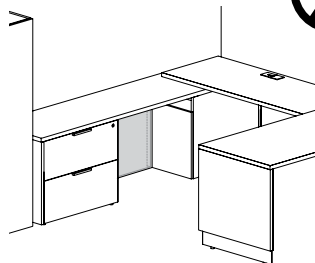

A nominal 24" of clear space is needed to allow full door opening of a Multi-Functional Storage. A Multi-Functional Drawer can be installed in this free space

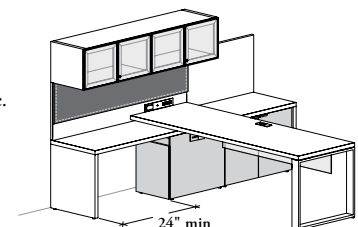



## storage for secondary desk basics (continued)

center (C)

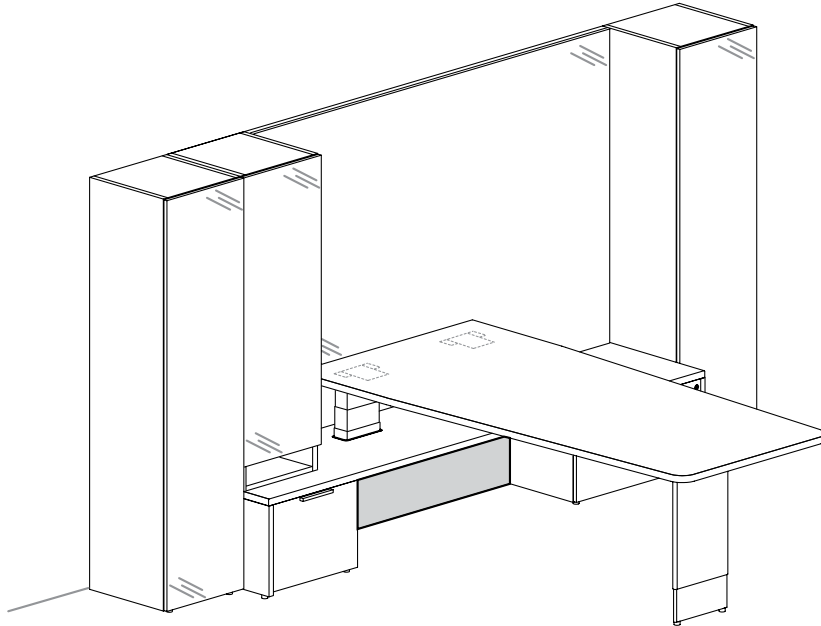

full secondary desk width (F)

When Full Secondary Desk Width (F) is specified, only 60" to 78" wide panel are available

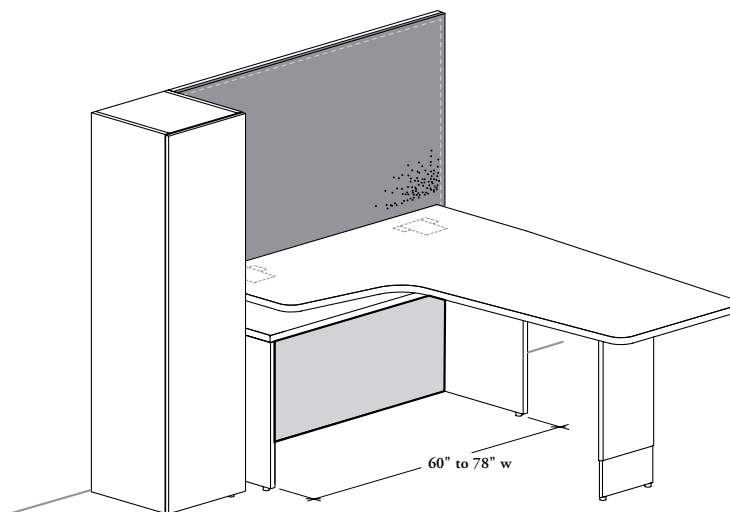

# filing drawer capacities – lateral file for secondary desk – center position

Lateral file drawer storage capacities are shown below.

⚠ The dimensions listed below are inside drawer

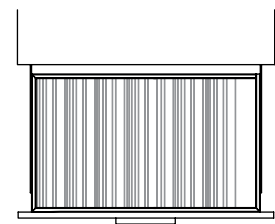
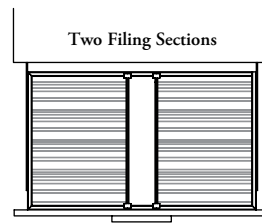
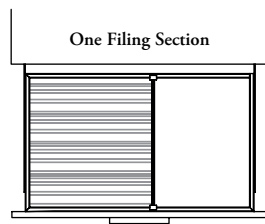

Front-to-Back

Front-to-Back

Side-to-Side

## 18" wide drawer

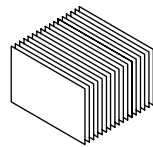
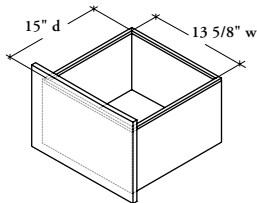

**Paper Size Allowed:**

- Letter
- A4

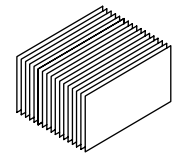

**Paper Size Allowed:**

- Legal

## 24" wide drawer

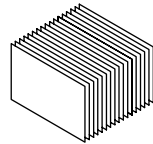
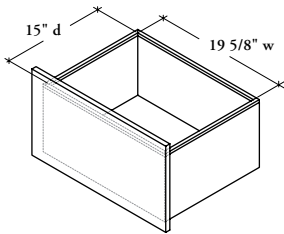

**Paper Sizes Allowed:**

- Letter
- A4
- Legal

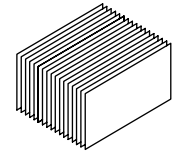

**Paper Sizes Allowed:**

- Letter\*
- A4\*
- Legal

## 30" wide drawer

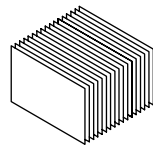
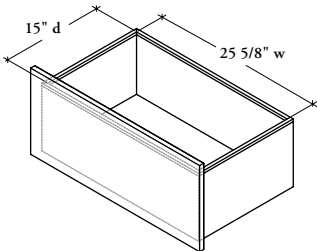

**Paper Sizes Allowed:**

- A4
- Legal

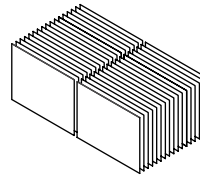

**Paper Size Allowed:**

- Letter

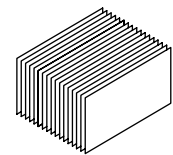

**Paper Sizes Allowed:**

- Letter\*
- A4\*
- Legal

## 36" wide drawer

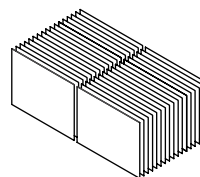
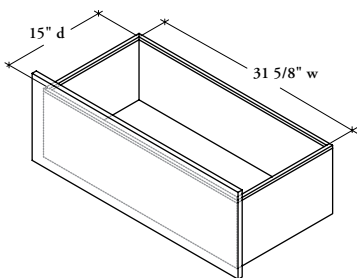

**Paper Sizes Allowed:**

- Letter
- A4
- Legal

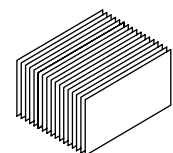

**Paper Sizes Allowed:**

- Letter\*
- A4\*
- Legal

\* The Letter or A4 paper size is allowed but require optional Hanging File Bar (RSLB)

# filing drawer capacities – lateral file for secondary desk – end position – 1 3/16" worksurface thickness

Lateral file drawer storage capacities are shown below.

 The dimensions listed below are inside drawer

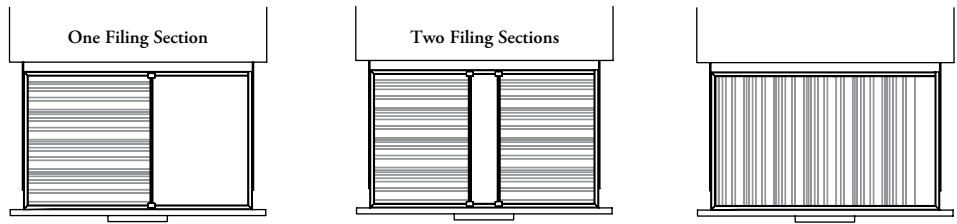

Front-to-Back

Front-to-Back

Side-to-Side

## 18" wide drawer

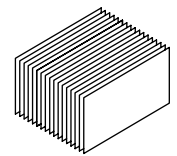
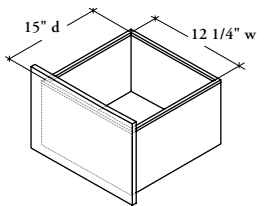

**Paper Size Allowed:**  
• Legal

## 24" or 30" wide drawers

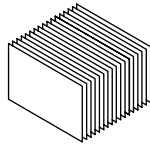
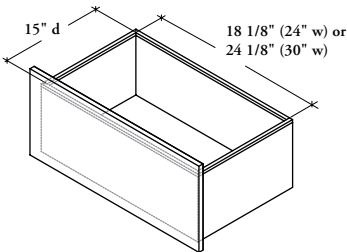

**Paper Sizes Allowed:**  
• Letter  
• A4  
• Legal

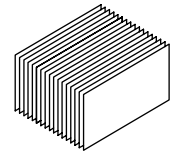

**Paper Size Allowed:**  
• Legal

## 36" wide drawer

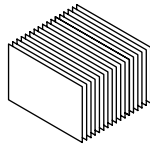
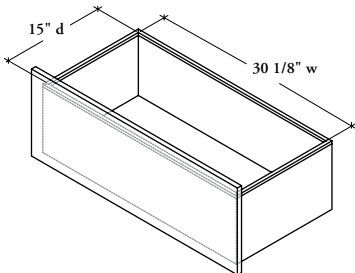

**Paper Size Allowed:**  
• Legal

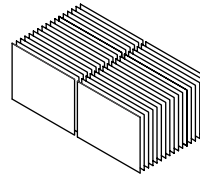

**Paper Sizes Allowed:**  
• Letter  
• A4

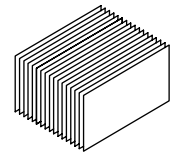

**Paper Size Allowed:**  
• Legal

## 42" wide drawer

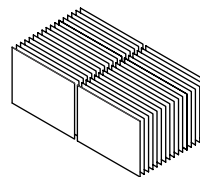
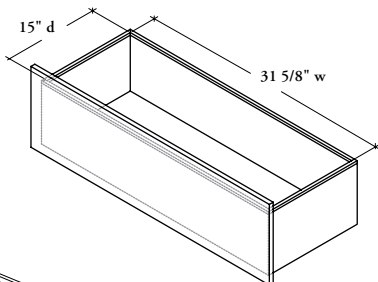

**Paper Sizes Allowed:**  
• Letter  
• A4  
• Legal

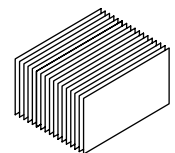

**Paper Sizes Allowed:**  
• Letter\*\*  
• A4\*\*  
• Legal

\*\* The Letter or A4 paper size is allowed but require optional 36" Metal Hanging File Bar (RSLB36)

# filing drawer capacities – lateral file for secondary desk – end position – 1 9/16" worksurface thickness

Lateral file drawer storage capacities are shown below.

⚠ The dimensions listed below are inside drawer

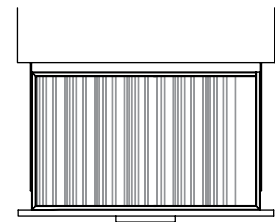
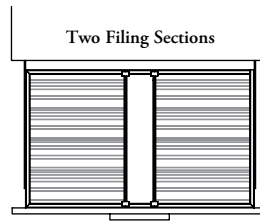
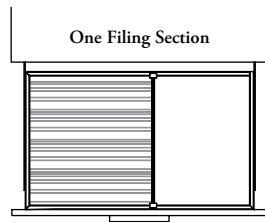

Front-to-Back

Front-to-Back

Side-to-Side

## 18" wide drawer

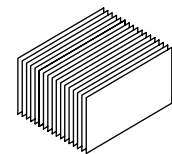
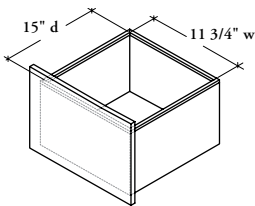

**Paper Size Allowed:**  
• Legal

## 24" or 30" wide drawers

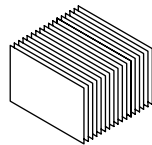
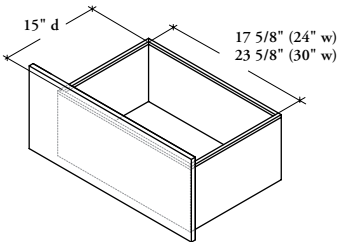

**Paper Sizes Allowed:**  
• Letter  
• A4  
• Legal

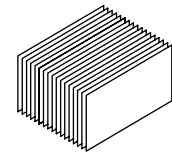

**Paper Size Allowed:**  
• Legal

## 36" wide drawer

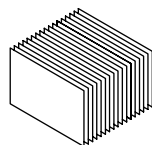
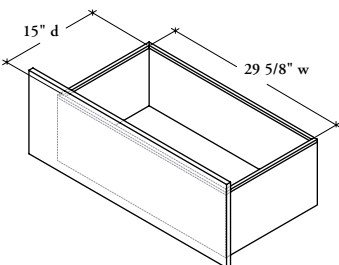

**Paper Size Allowed:**  
• Legal

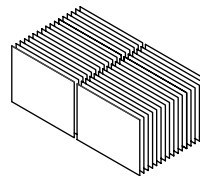

**Paper Sizes Allowed:**  
• Letter  
• A4

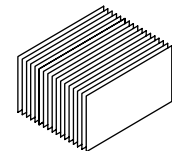

**Paper Size Allowed:**  
• Legal

## 42" wide drawer

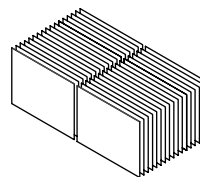
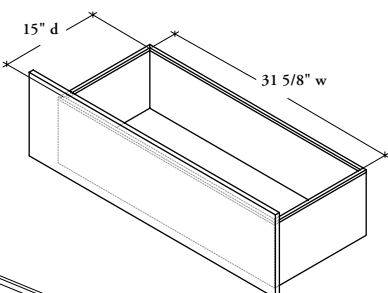

**Paper Sizes Allowed:**  
• Letter  
• A4  
• Legal

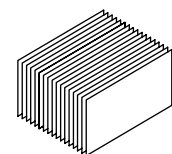

**Paper Size Allowed:**  
• Letter\*\*  
• A4\*\*  
• Legal

\*\* The Letter or A4 paper size is allowed but require optional 36" Metal Hanging File Bar (RSLB36)

# planning with storage for secondary desks

- The storage for secondary desk can be placed anywhere under low or high secondary desk (B\_MSD, BH\_SR, BH\_SB or BH\_SL)
- When a secondary desk exceeds the maximum span allowed, a Storage for Secondary Desk (BSSP, BSSL, BSSO, BSSD, BSSM or BSSRW) must be placed underside to maintain integrity
- The Open Section Cover – Secondary Desk (BSSCM) **cannot** be used to reduce unsupported span
- The restrictions illustrated below apply to Fixed-Height or Height-Adjustable Multi-Level Workstations

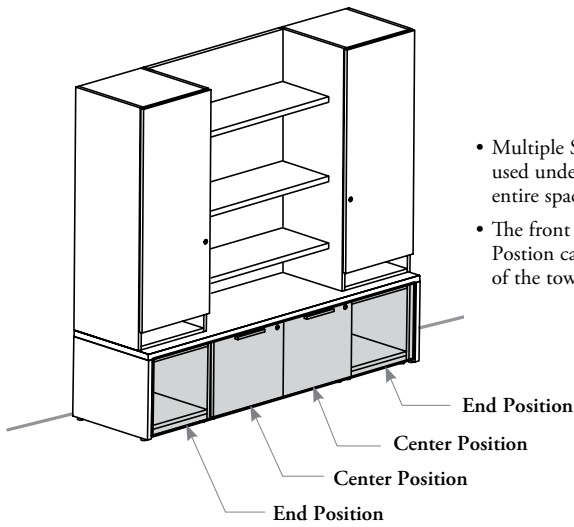

- Multiple Storage for Secondary Desk can be used under the same desk. They can fill the entire space available
- The front of Storage for Secondary Desk – End Position can perfectly be aligned with the front of the towers

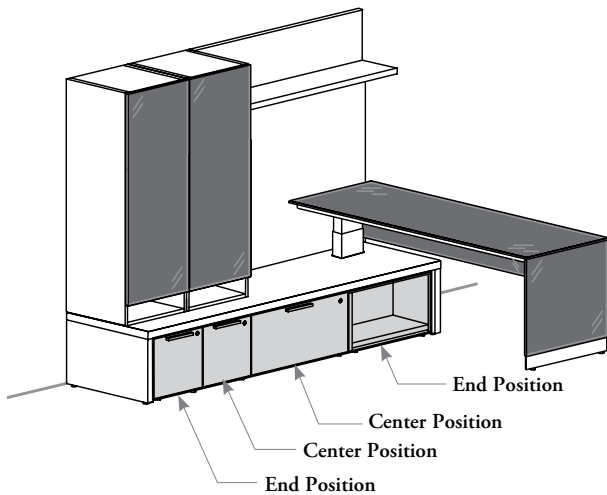
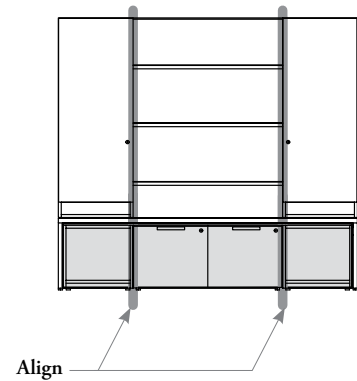

## product offering – storage for secondary desks

⚠ All dimensions on this page are actual

**Stretch Pedestal – Secondary Desk – Center Position (BSSPC)**

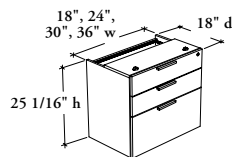

2 box drawers,  
1 file drawer

**Stretch Pedestal – Secondary Desk – End Position (BSSPM, X)**

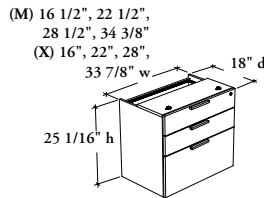

2 box drawers,  
1 file drawer

**Lateral File – Secondary Desk – Center Position (BSSLC)**

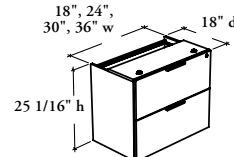

2 large file drawers

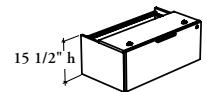

1 large file drawer

**Lateral File – Secondary Desk – End Position (BSSLM, X)**

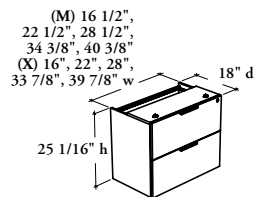

2 large file drawers

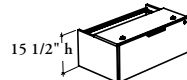

1 large file drawer

**Bookcase – Secondary Desk – Center Position (BSSOC)**

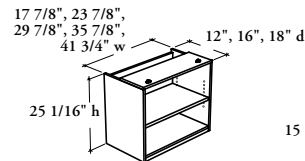

1 adjustable shelf

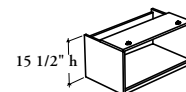

1 open

**Bookcase – Secondary Desk – End Position (BSSOM, X)**

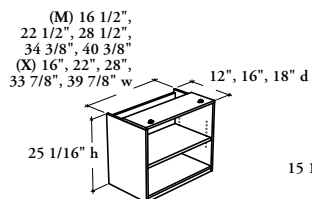

1 adjustable shelf



1 open

**Storage Cabinet – Secondary Desk – Center Position (BSSDC)**

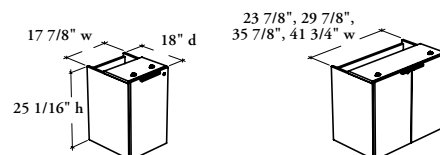

1 door

2 doors

# product offering – storage for storage for secondary desks (continued)

**Storage Cabinet – Secondary Desk – End Position (BSSDM, X)**

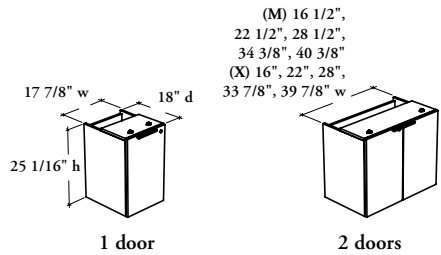

**Multi-Functional Storage – Secondary Desk – Center Position (BSSMC)**

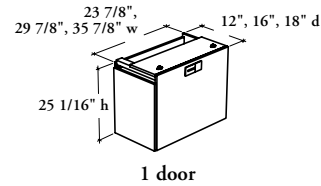

**Multi-Functional Storage – Secondary Desk – End Position (BSSMM, X)**

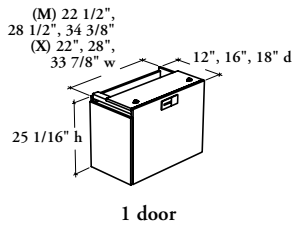

**Recycling/Waste Cabinet – Secondary Desk – Center Position (BSSRWC)**

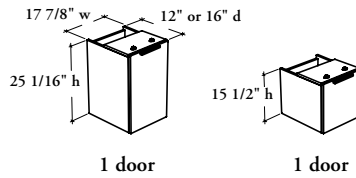

**Recycling/Waste Cabinet for Secondary Desk – End Position (BSSRWM, X)**

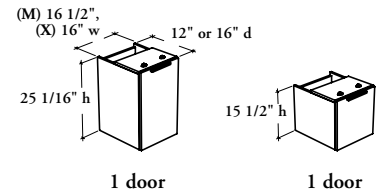

# lock chart – storage for storage for secondary desks

⚠ If specified, all closed storage products come with a lock and key set and can be keyed alike or randomly. A Key Chart must accompany every order, otherwise orders will be shipped keyed randomly

## Stretch Pedestal – Secondary Desk (BSSP)

HIGH

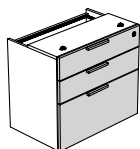

number of locks

1 x

## Lateral File – Secondary Desk (BSSL)

HIGH

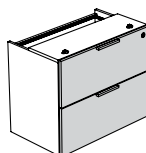

LOW

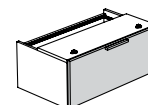

OR

1 x

## Bookcase – Secondary Desk (BSSO)

HIGH

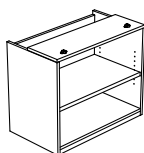

LOW

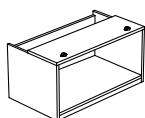

OR

number of locks

0 x

## Storage Cabinet – Secondary Desk (BSSD)

HIGH (18" width)

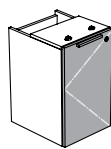

Left

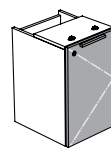

Right

OR

HIGH (24" to 42" widths)

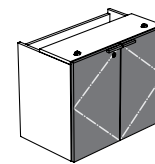

OR

1 x

## Multi-Functional Cabinet – Secondary Desk (BSSM)

HIGH

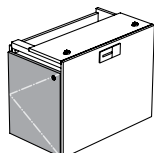

Left

OR

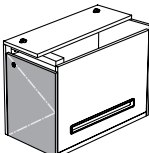

Right

number of locks

1 x

## Recycling/Waste Cabinet – Secondary Desk (BSSRW)

HIGH

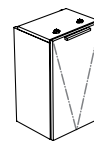

LOW

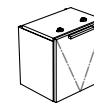

OR

1 x

	Lockable Double Doors		Lockable Single Door		Lockable Drawers		Not Lockable
---	-----------------------	---	----------------------	---	------------------	---	--------------



# interior clearance – storage for storage for secondary desks

The following outline the interior clearance available for storage for multi-level workstations.

## low-height bookcase for secondary desk

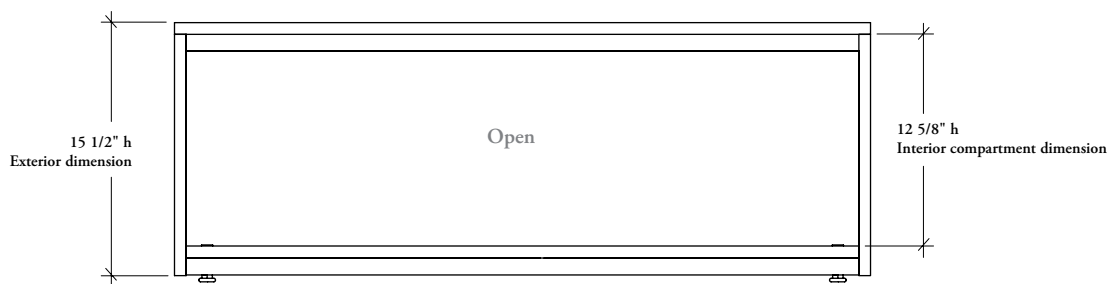

**Bookcase – Secondary Desk – Center or End Position – Low Secondary Desk**

For end position storage, the interior compartment dimension is the same for 1 3/16" (M) or 1 9/16" (X) worksurface thickness

## storage for secondary desks finishes

⚠ For an overview of which products are offered in Flintwood finishes, refer to the Expansion Casegoods product map on Teknion's website

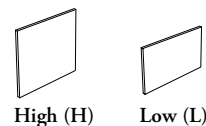
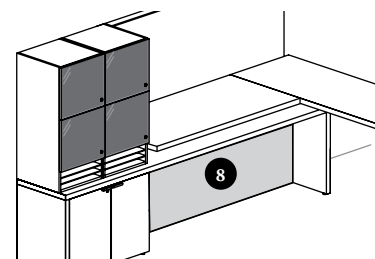
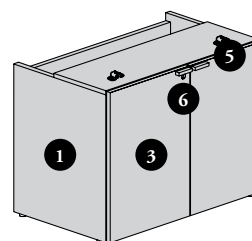
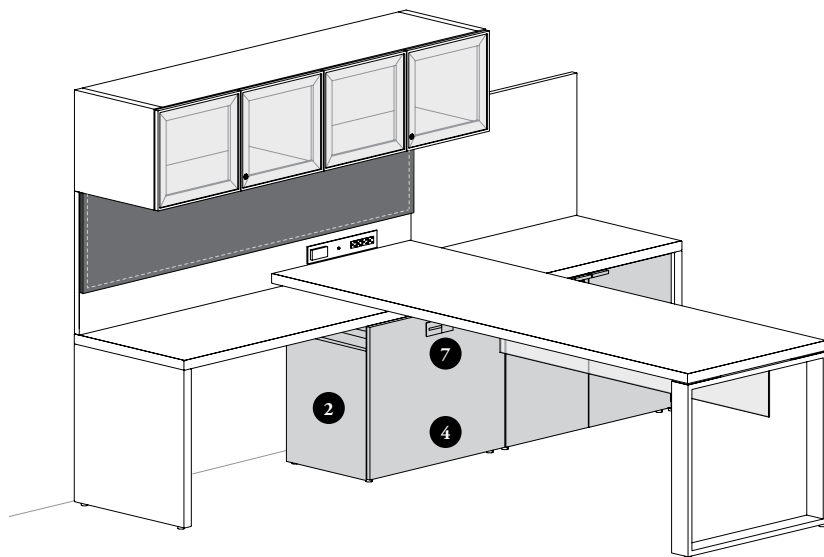

High (H) Low (L)

- 8** Open Section Cover – Secondary Desk  
 Finishes:  
 – Source Laminate  
 – Grade 2 Laminate (No Accents)  
 – Flintwood (No Cathedral)

Grain Direction  
 (Widths Available)

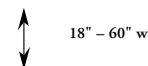

18" – 60" w



66" – 78" w

- 1** Case, **2** Side Door of Multi-Functional Storage and Adjustable Shelf

Finishes:

- Source Laminate
- Flintwood (No Cathedral)

- 3** Drawer and Door Fronts, and **4** Panel Front of Multi-Functional Storage

Finishes:

- Source Laminate
- Grade 2 Laminate (No Accents)
- Flintwood (No Cathedral)

- Edge trim on fronts always match front finish

- 5** Pull

Finishes:  
 – Foundation  
 – Mica

- Hardware will match Pull finish if visible

- 6** Lock & Key

Finish:  
 – Brushed Chrome

- 7** Grommet of Multi-Functional Storage

Finish:  
 – Foundation  
 – Mica

# grain direction – storage for storage for secondary desks

Door and drawer front grain direction will always be vertical

## Cathedral Grain Pattern:

Source Laminate

- 3A – 3B – 3C – 3D – 3E – 3L – 3M – 3X – 8E – 8R – 8S – XQ – XR – 86 – 87 – 88

For colors listed above, the Cathedral Grain Pattern for drawer fronts will be book-matched

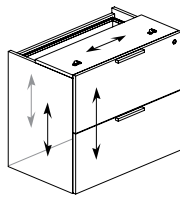

## Straight Grain Pattern:

Source Laminate

- 3F – 3K – XJ

Flintwood (No Cathedral)

- FC – FD – FM – FN – FX – NR – NT – VA – VB – VZ – 5N – 5P – 5Q – 5R – 5S – 5T – 5V – 5W – 5Z

For colors listed above, the Straight Grain Pattern for drawer fronts will be vertical

