

mounted storage & accessories

Xpress

B R L L

Tower with Full Solid Door – Low Secondary Desk Mounted

This Tower combines file drawer, shelves or wardrobe storage compartments and a pigeonhole section in a full door aesthetic. It must always be mounted on a Low Secondary Desk.

WHAT'S INCLUDED

1 tower, 1 rectangular door, mounting hardware, locks and keys (as specified), and accessories as listed below:

| | Interior Configuration | | |
|--------------------|------------------------|-----|---|
| | W | S | F |
| Adjustable Shelf | n/a | 2 | 1 |
| File Drawer | n/a | n/a | 1 |
| 15" Cross File Bar | n/a | n/a | 1 |
| Coat Hook | 2 | n/a | 2 |

WHAT'S EXCLUDED

Low Secondary Desks and Multi-Functional Drawer.

NOTES

This mounted tower **cannot** be used alone. It must be connected to another mounted tower, a freestanding tower, a wall panel or an overhead cabinet in order to ensure stability.

When applicable, the cross file bar is included and is installed along the depth only.

File Drawer accepts the legal- and letter-size paper.

The Multi-Functionnal Drawer (BADMF) can only be installed in the pigeonhole section.

The shelf has a five positions adjustment with 1 1/4" intervals.

Not all finishes are available as Xpress, Please see Xpress catalogue and/or specification software for details.

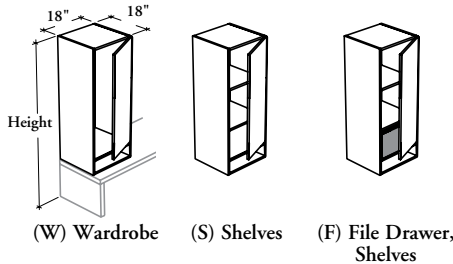

PRODUCT OPTIONS

| Interior Configuration | Depth | Width | Height | Door Swing Direction |
|---|-------|-------|--------|---|
| F File Drawer and Shelves S Shelves W Wardrobe | 18 | 18 | 66, 72 | L Left Side R Right Side (Shown) |

SAMPLE ORDER CODE

| | | | | |
|----------------|-----------|-----------|-----------|----------|
| BRL L F | 18 | 18 | 72 | R |
|----------------|-----------|-----------|-----------|----------|

PRODUCT OPTIONS CONTINUED

| Case Finish | Door Front Finish | Edge Trim Finish (For Source Lam. Fronts only) | Key Style |
|--|--|---|---|
| Source Laminate Flintwood (No Cathedral) | Source Laminate Flintwood (No Cathedral) | Edge Trim Colors | N No Lock K Keyed Alike R Keyed Randomly |

SAMPLE ORDER CODE CONTINUED

| | | | |
|-----------|-----------|-----------|----------|
| XS | XS | ST | K |
|-----------|-----------|-----------|----------|

See Pricing on the following page.

B R L L

**Tower with Full Solid Door –
Low Secondary Desk Mounted (Continued)**

| CUBE STYLE | PRICING | | |
|------------|-----------------------------|-----------|-----------------------|
| | SOURCE LAMINATE CASE FINISH | | FLINTWOOD CASE FINISH |
| | DOOR FRONT FINISH | | |
| | Source Laminate | Flintwood | Flintwood |
| BRLW1866 | 944 | 1179 | 2668 |
| BRLW1872 | 1009 | 1277 | 2797 |
| BRLS1866 | 1064 | 1296 | 3125 |
| BRLS1872 | 1126 | 1391 | 3248 |
| BRLF1866 | 1296 | 1531 | 3492 |
| BRLF1872 | 1364 | 1624 | 3611 |